



# INSTALLATION INSTRUCTIONS

Accessory  
TRAILER HITCH

Application  
2019 RDX

Publications No.  
**VERSION 1**  
Issue Date  
**MAY 2018**

## PARTS LIST

Trailer Hitch Kit  
P/N 08L92-TJB-200

Trailer hitch



Receiver cover



6 Flange bolts, 12 x 33 mm



4 Flange bolts, 14 x 40 mm



Right bracket



Left bracket



**Ball Mount Kit**  
P/N 08L92-TJB-200A

Ball mount



Hitch pin



Hitch pin clip



**Hitch Cover Panel Kit**  
P/N 08L92-TJB-200B

Hitch Cover Panel



**Hitch Cover Panel Kit**  
P/N 08L92-TJB-200C

Hitch Cover Panel



## Hands-Free Access Power Tailgate Unit Kit P/N 08L91-TJB-200B

Hands-Free Access unit



Label



### TOOLS AND SUPPLIES REQUIRED

- Phillips screwdriver
- 10 mm Open end wrench
- 10 mm, 17 mm, and 18 mm Sockets
- Ratchet
- Torque wrench
- Shop towel

*The following tools are available through the Acura Tool and Equipment Program. On the iN, click on Service > Service Bay > Tool and Equipment Program, then enter the number under "Search." Or, call 888-424-6857.*

- Trim Tool Set (T/N SOJATP2014)
- Plastic Trim Tool (T/N SILTRIMTL10)

### Illustration of the Trailer Hitch on the Vehicle

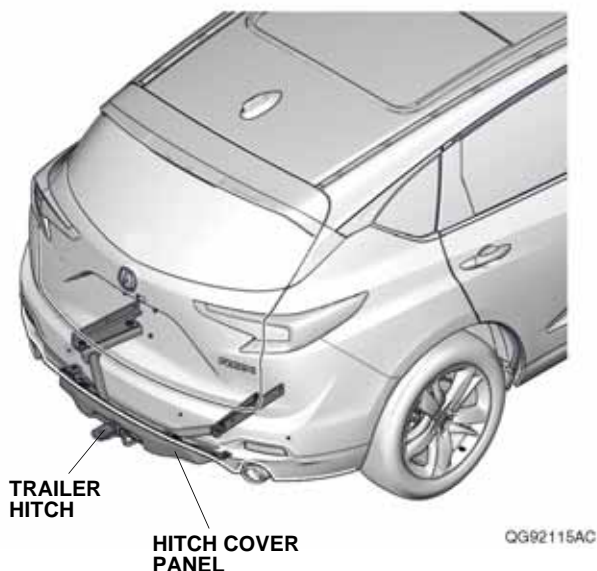

## INSTALLATION

**Client Information:** The information in this installation instruction is intended for use only by skilled technicians who have the proper tools, equipment, and training to correctly and safely add equipment to your vehicle. These procedures should not be attempted by "do-it-yourselfers."

NOTE: Do not damage the body paint finish.

1. Disconnect the negative cable from the battery.

**If the vehicle is equipped with a spare tire, continue with step 2; otherwise, go to step 5.**

### With Spare Tire

2. Remove the cargo floor board.

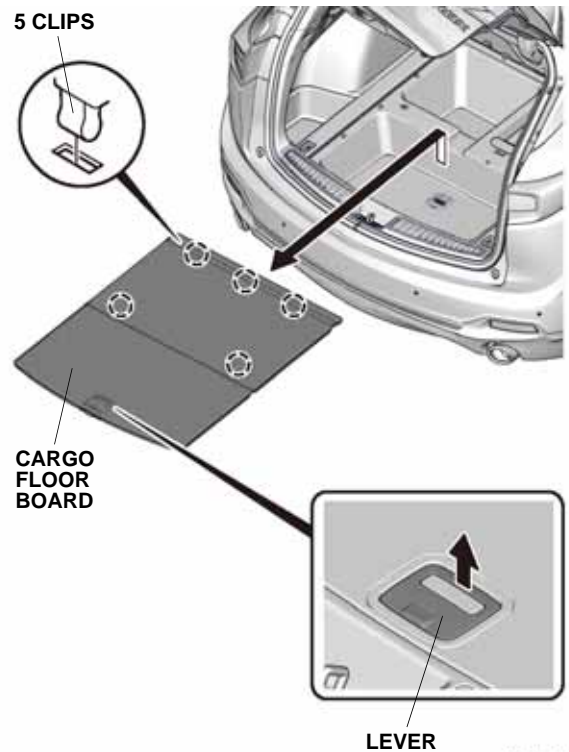

3. Remove the spare tire plug cap.

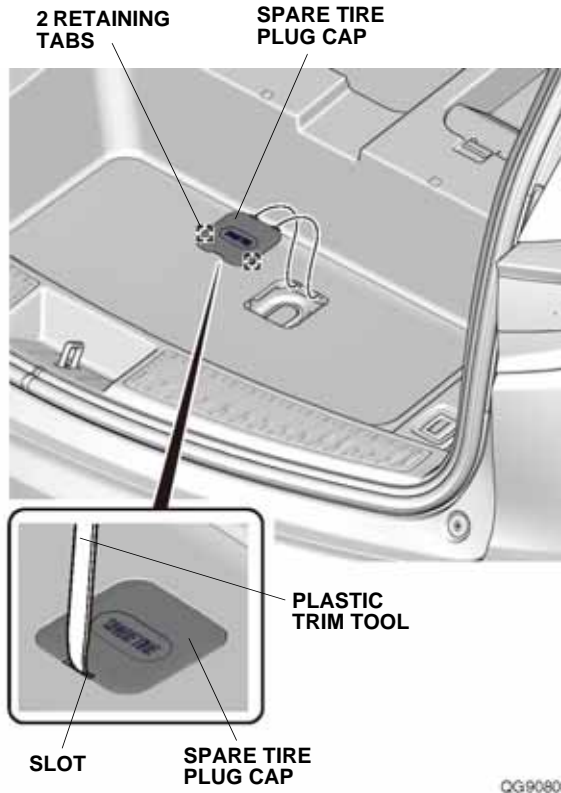

4. Remove the spare tire plug to access the spare tire hoist shaft. Lower the spare tire completely.

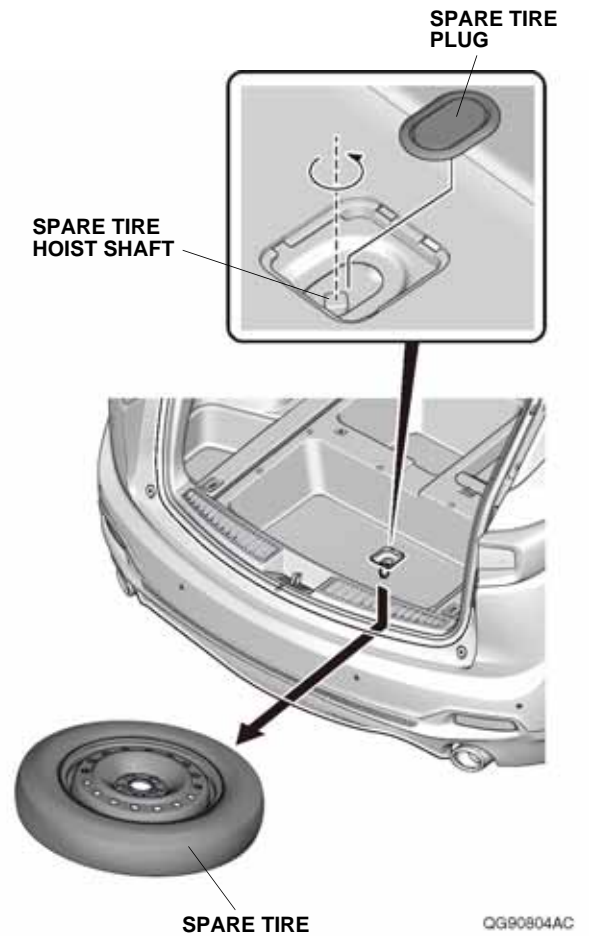

- Remove the lower panel.

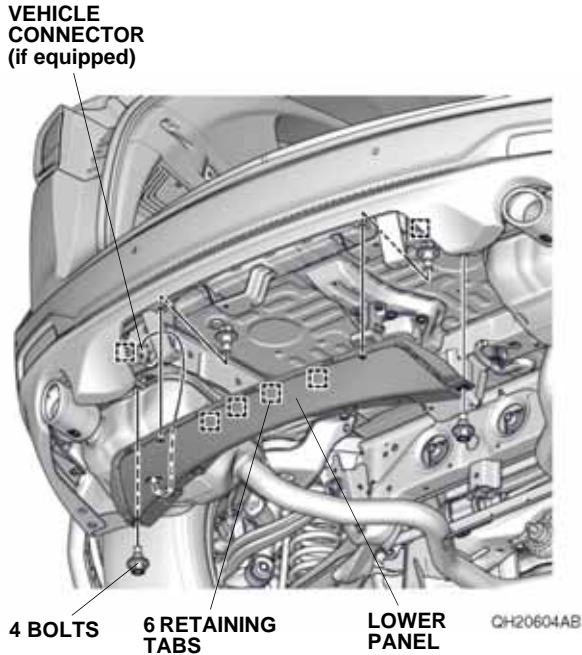

If the vehicle is equipped with the Hands-Free Access Power Tailgate, continue with step 6; if not, go to step 7.

**With Hands-Free Access Power Tailgate**

- Remove the hands-free access unit.

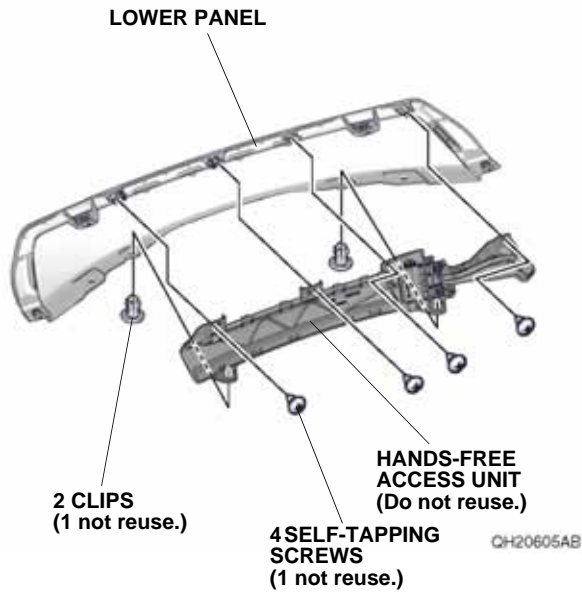

- Remove the four spring nuts from the lower panel.

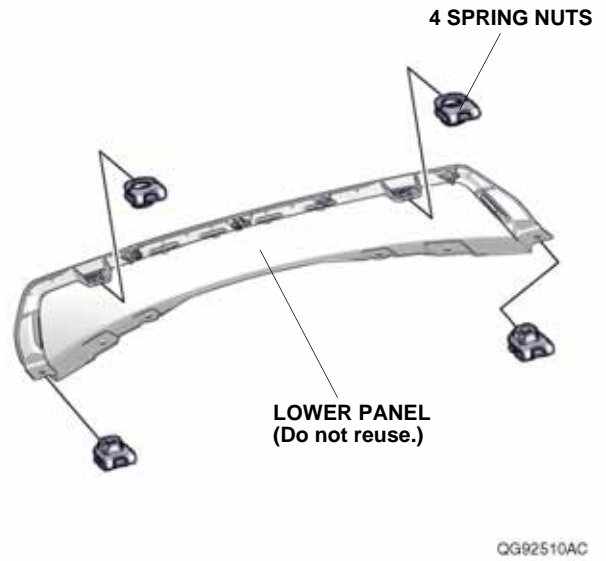

- Install the four spring nuts removed in step 7 to the hitch cover panel.  
NOTE: Make sure to install the spring nuts in the correct orientation.

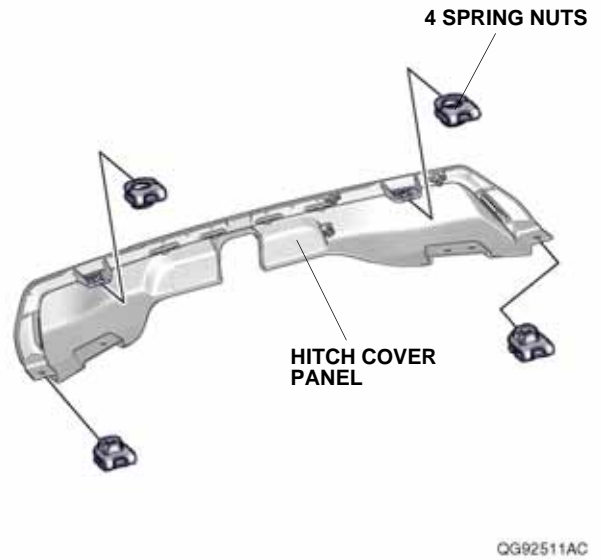

If the vehicle is equipped with the Hands-Free Access Power Tailgate, continue with step 9; if not, go to step 10.

**With Hands-Free Access Power Tailgate**

9. Install the new hands-free access unit to the hitch cover panel with one clip and the three self-tapping screws removed in step 6.

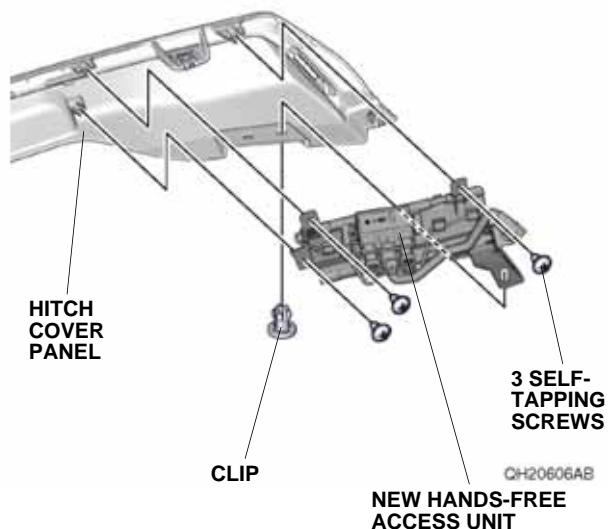

10. Plug the vehicle connector into the new hands-free access unit if equipped. Install the hitch cover panel to the rear bumper with the six retaining tabs and four bolts removed in step 5.

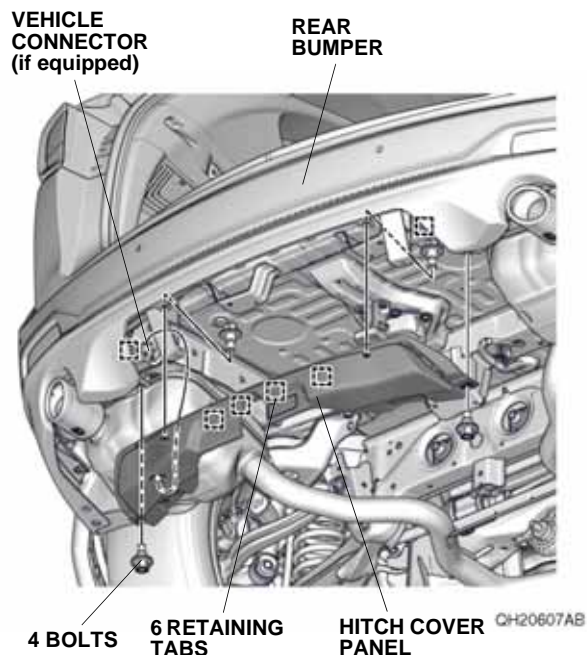

11. Loosely install the left bracket to the vehicle panel with the three 12 x 33 mm flange bolts. Tighten the flange bolts by hand.

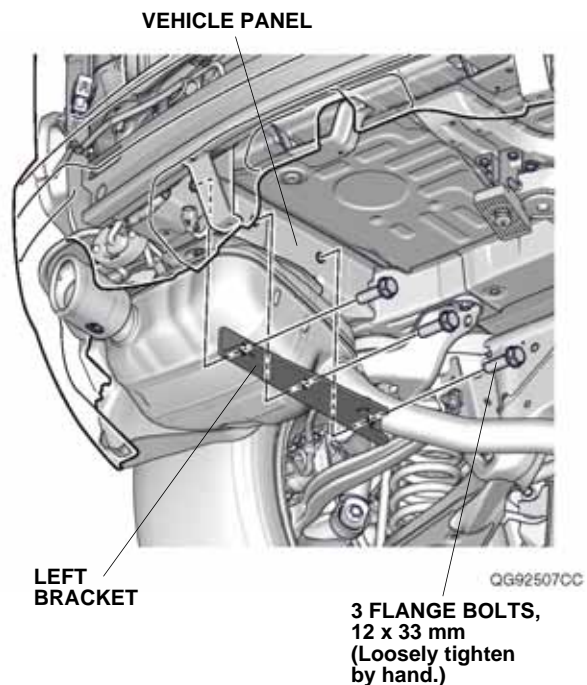

12. Repeat step 11 on the right side of the vehicle.

13. Tighten the six 12 x 33 mm flange bolts to an initial torque of 23.6 lb-ft (32 N·m) as shown. Then, tighten the bolts to a final torque of 47.2 lb-ft (64 N·m).  
NOTE: After tightening all the bolts, recheck their torque.

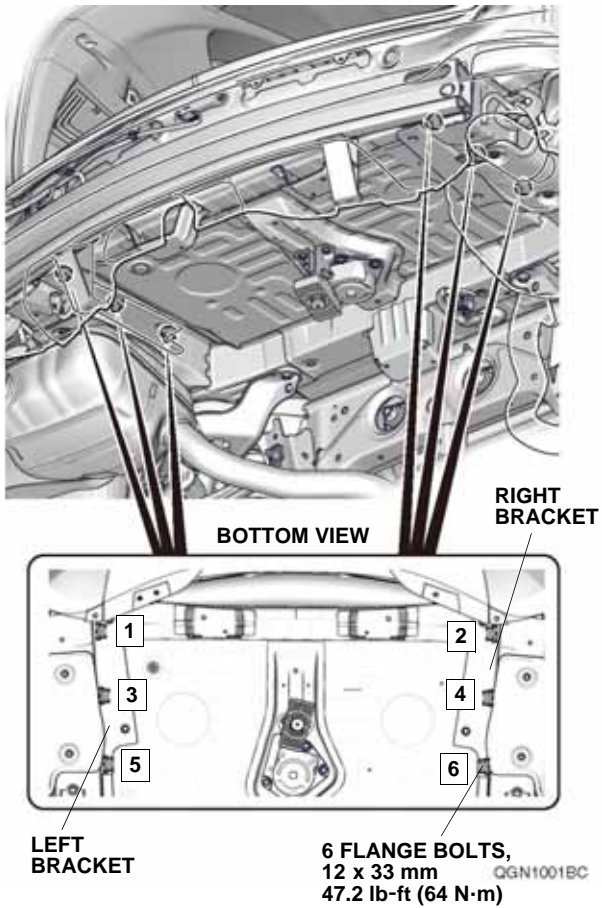

14. Loosely install the trailer hitch to the left bracket and right bracket with four 14 x 40 mm flange bolts. Tighten the flange bolts by hand.

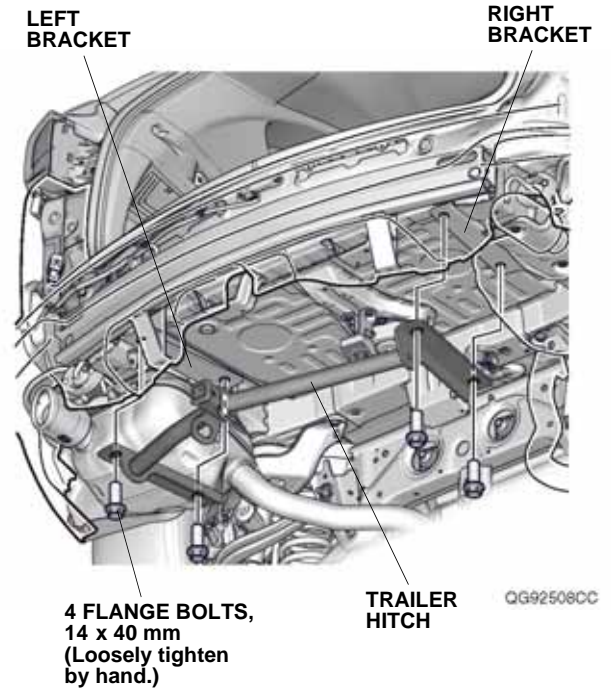

15. Tighten the four 14 x 40 mm flange bolts to an initial torque of 35 lb-ft (48 N·m) as shown. Then, tighten the bolts to a final torque of 70 lb-ft (95 N·m).  
NOTE: After tightening all the bolts, recheck their torque.

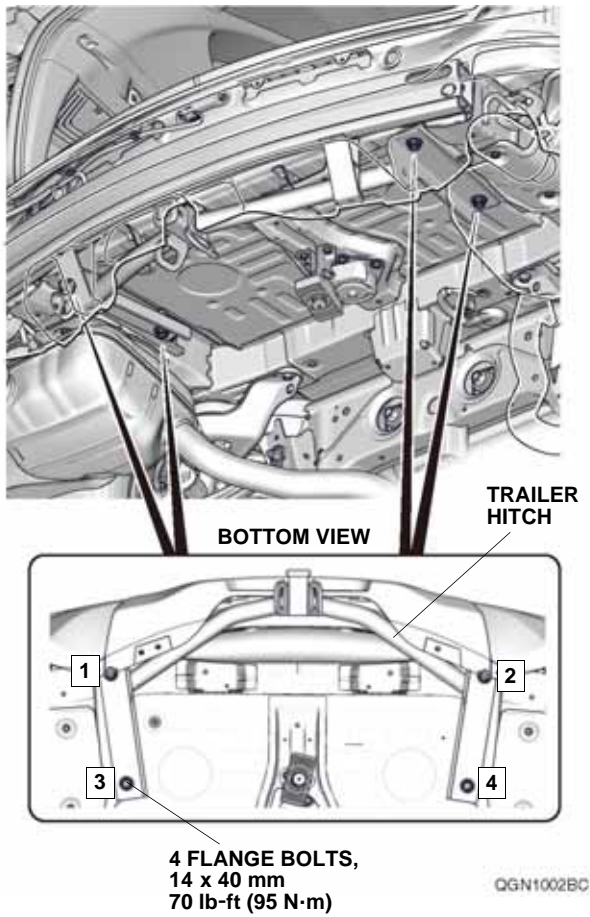

**If the vehicle is equipped with Hands-Free Access Power Tailgate, continue with step 16; if not, go to step 19.**

**With Hands-Free Access Power Tailgate**

16. Using a clean shop towel with soap and water, thoroughly clean where the label will attach. Then, dry the area with a clean towel.

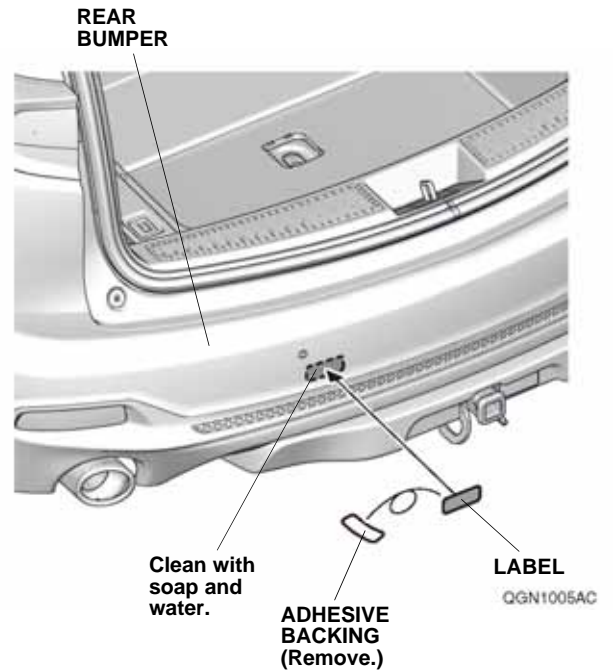

17. Remove the adhesive backing from the label. Attach the label to the rear bumper as shown.  
NOTE: Make sure the client is aware the label can be removed after reading.

18. Spare Tire Installation:

- Before raising the spare tire back into the vehicle, make sure the spare tire hoist bar is centered in the hub opening of the wheel.
- Raise the spare tire. If the hoist bar is correctly positioned, the spare tire will be close to level as it is raised. If the hoist bar is not correctly positioned, the spare tire will not be level as it is raised and will not seat flush under the vehicle.
- Using the appropriate tools in the vehicle, tighten the spare tire hoist until it clicks. Failure to do this can result in noise and/or damage to the hoist cable.

**INCORRECT:**

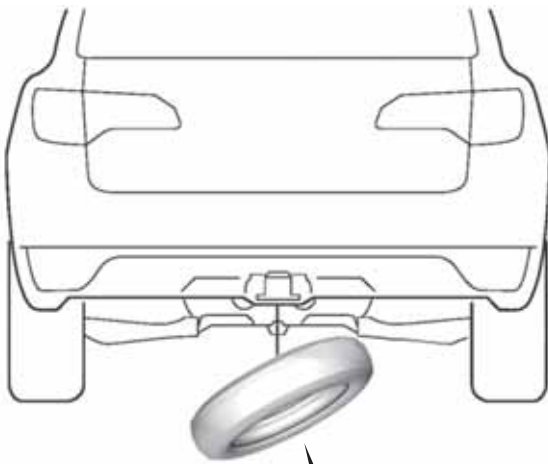

**Bracket position is incorrect.**

**CORRECT:**

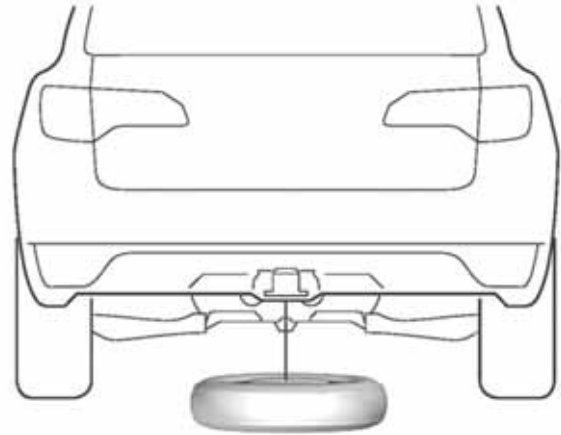

**The spare tire should remain level when being retracted.**

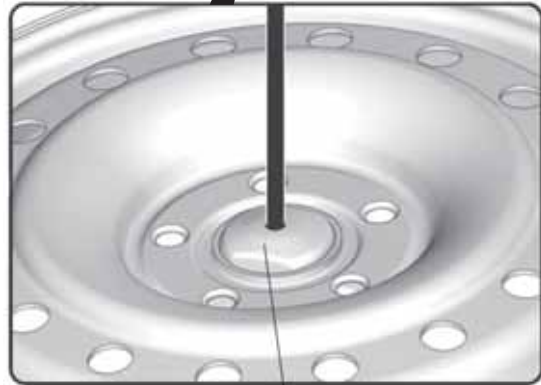

**Bracket position is correct.**

- Using the appropriate tools in the vehicle, tighten the spare tire hoist until it clicks. Failure to do this can result in noise and/or damage to the hoist cable.

19. Install all remaining parts.
20. Check that all wire harnesses are routed properly and all connectors are plugged in.
21. Connect the negative cable to the battery.
22. Press and hold the audio unit power button for 2 seconds to restore the audio and navi (if equipped) system functions.
23. Set the clock on vehicles without navigation.
24. If necessary, restore the system back to normal operation as described in the service information.



**Put a copy of this page in the glove box for your client.**

Install the ball mount to the trailer hitch using a hitch pin clip and hitch pin.  
Whenever you remove the hitch pin clip, the hitch pin, and the ball mount, store them securely in the cargo area. Install the receiver cover into the opening at the end of the trailer hitch.  
When you reinstall the ball mount, store the receiver cover in the cargo area.

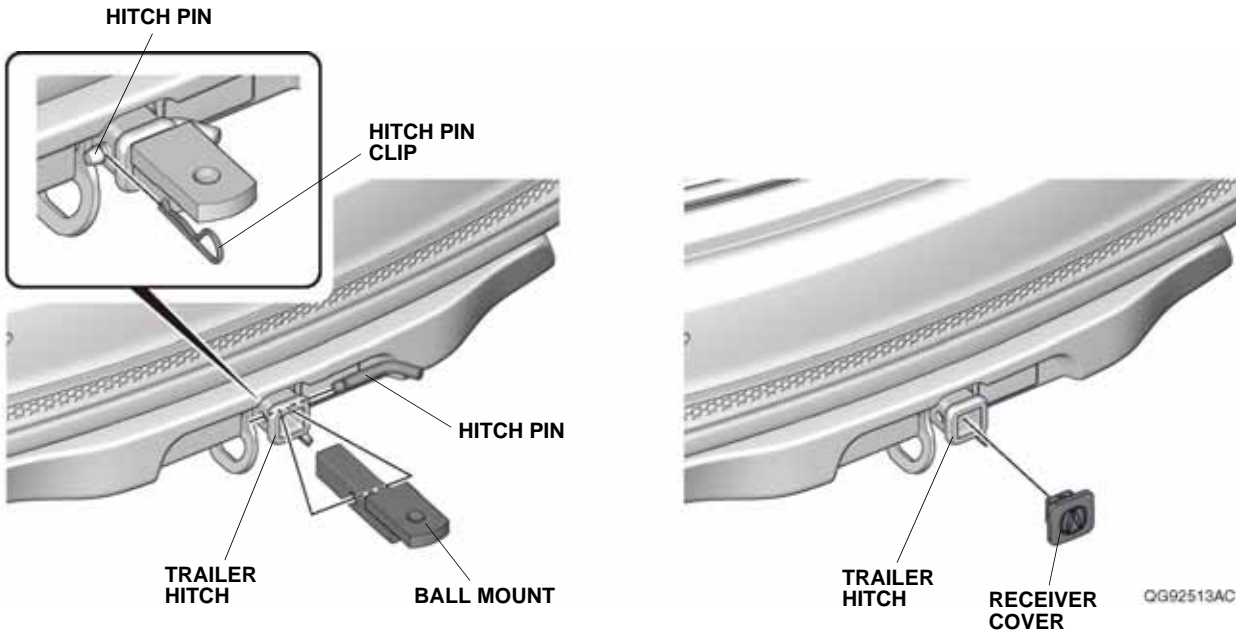

After the first 600 miles (1,000 km) of towing, have your Acura dealer check the tightness of the trailer hitch bolts.