

INSTALLATION INSTRUCTIONS

Accessory
REAR BUMPER APPLIQUE
 P/N 08P48-TZ3-200

Application
 2017 TLX

Publications No.
VERSION 1
 Issue Date
MAY 2016

PARTS LIST

Rear bumper applique



Applicator

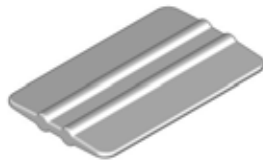

Soft sleeve



Alcohol swab



TOOLS AND SUPPLIES REQUIRED

Shop towel

Spray bottle

3M Protective tape application solution

Illustration of the Rear Bumper Applique on the Vehicle



REAR BUMPER APPLIQUE

QC01801BA

INSTALLATION

Client Information: The information in this installation instruction is intended for use only by skilled technicians who have the proper tools, equipment, and training to correctly and safely add equipment to your vehicle. These procedures should not be attempted by “do-it-yourselfers.”

NOTE:

- Do not damage the body paint finish.
- This kit should be installed only if the ambient air temperature is 15° C (60° F) or above.
- To allow the adhesive to cure, do not wash the vehicle for 24 hours. Please advise the client.

Installing the Rear Bumper Applique

1. Open the trunk lid. Use the alcohol swab to thoroughly clean the area where the rear bumper applique will attach.

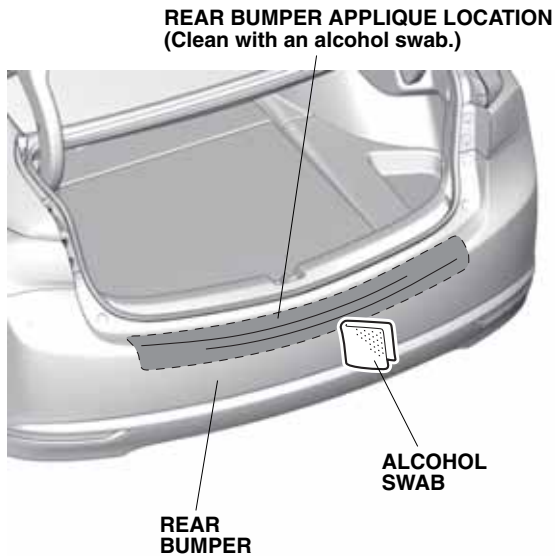

QC01802AA

2. Using a spray bottle with the 3M protective tape application solution, spray the area where the rear bumper applique will attach. Spray some solution on your hands.

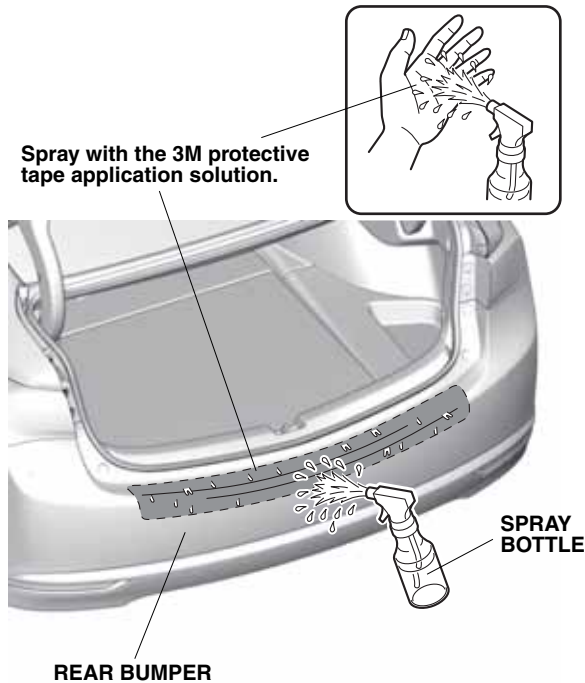

QC01803AA

3. Remove the adhesive backing from the side of the rear bumper applique with the 3M mark.

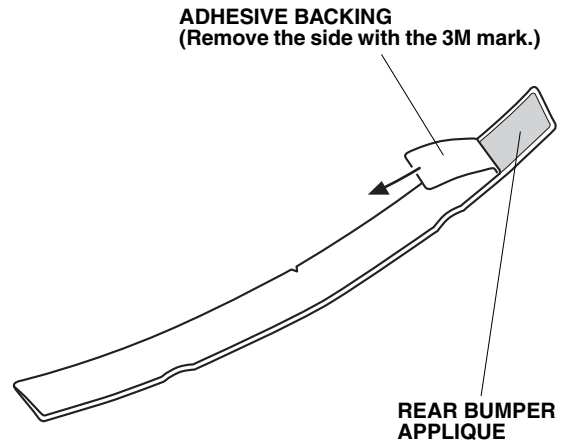

QC01804AA

4. Spray the rear bumper applique with the 3M protective tape application solution.

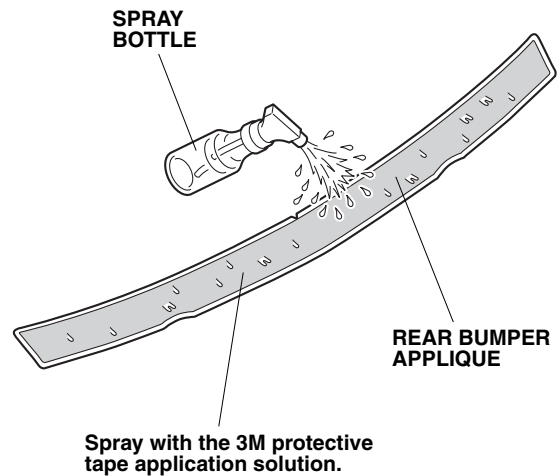

QC01805AA

- Align the notch in the center of the rear bumper applique with the center of the trunk lid anchor. Align the edge of the applique along the edge of the curved surface on the rear bumper. If the vehicle is equipped with parking sensors, make sure that the sensors are aligned evenly. Adjust the position of the applique as needed.

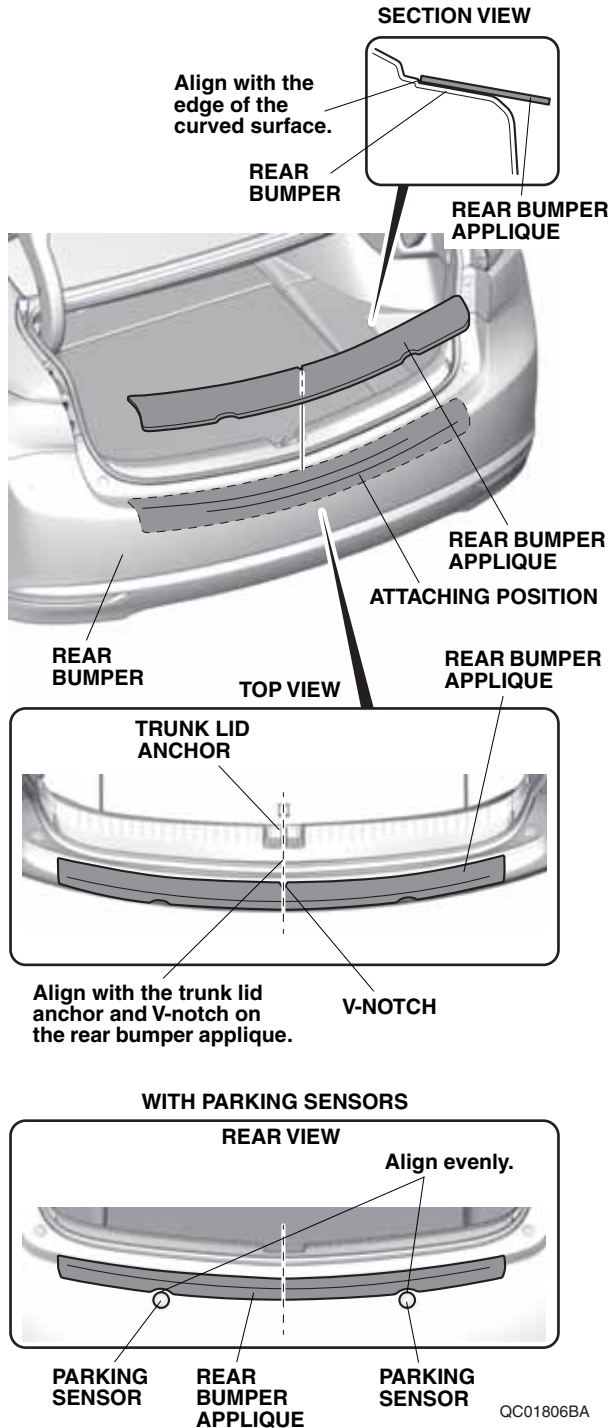

- Insert the applicator into the soft sleeve.

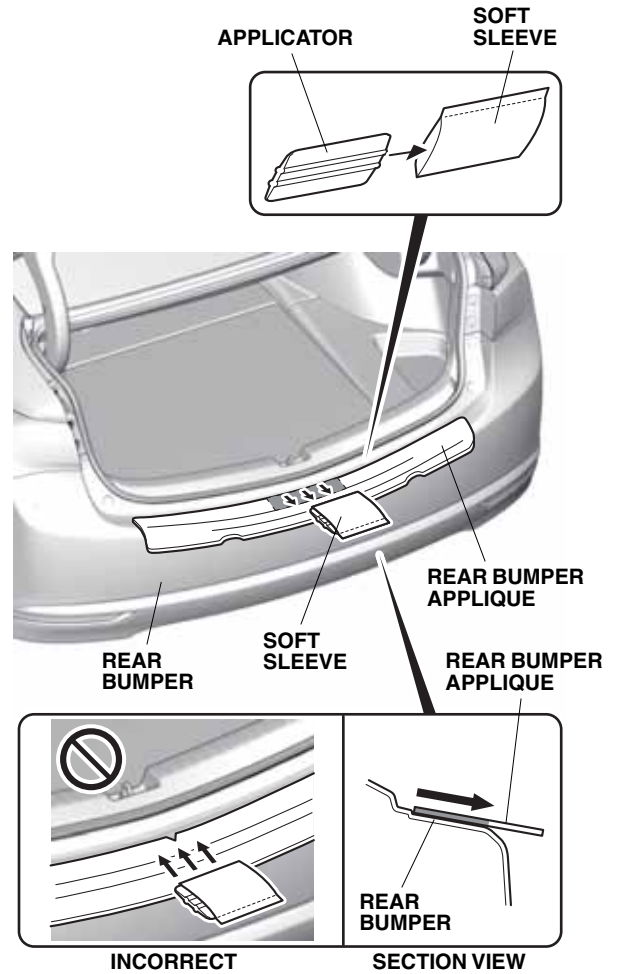

- Starting from the front and working rearward, use the soft sleeve to smooth out the upper section on the center of the applique. Move the soft sleeve in one direction only. If you see an air bubble, stop and gently peel up that section to work out the bubble. Work slowly and keep pressure against the applique.

8. Starting from the center and working outward, use the soft sleeve to smooth the left and right sides of the upper section. Move the soft sleeve in one direction only. If you see an air bubble, stop and gently peel up that section to work out the bubble. Work slowly and keep pressure against the applique.

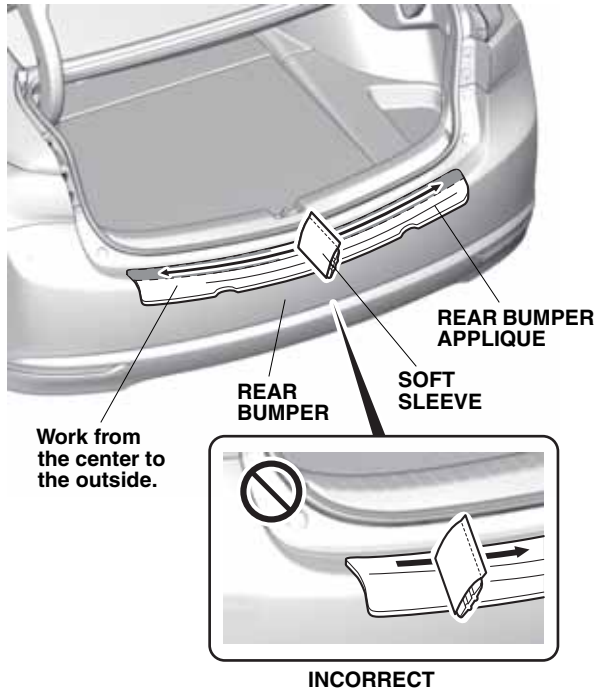

QC02102BA

9. Slowly remove the protective film as shown. Do not pull it upward.

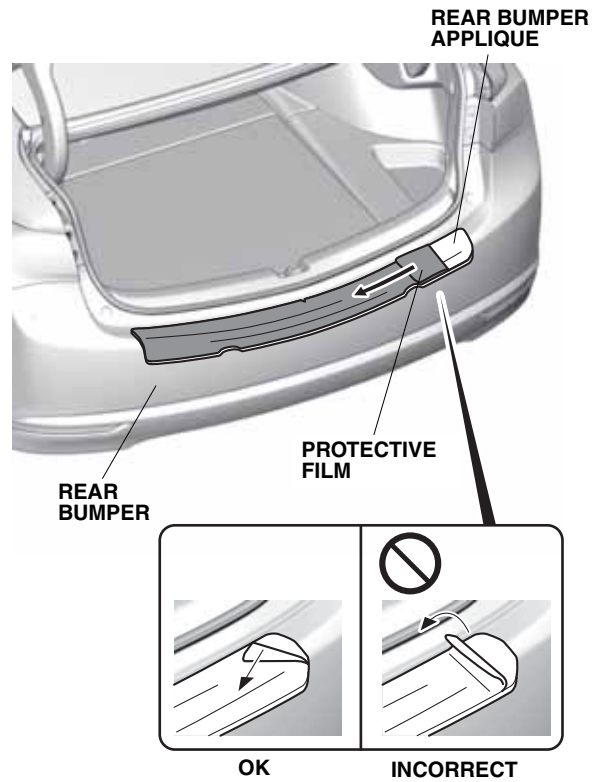

QC02103BA

10. Repeat step 7 to smooth out the center of the lower section of the applique.

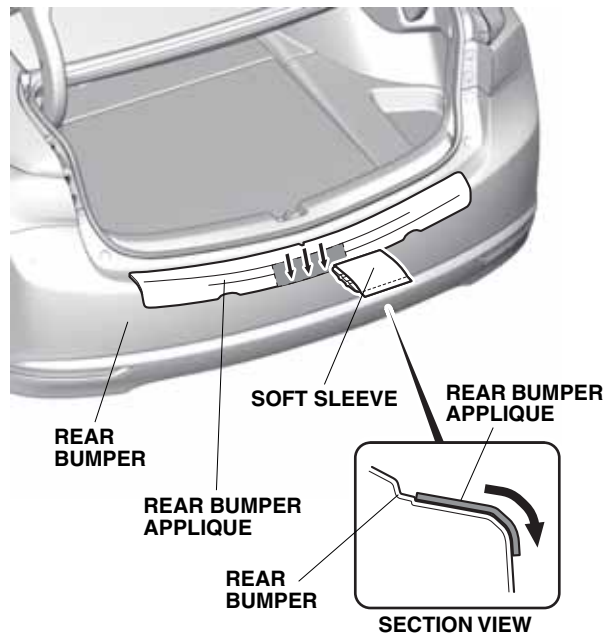

QC02104BA

11. Repeat step 8 to smooth out the left and right sides of the lower section.

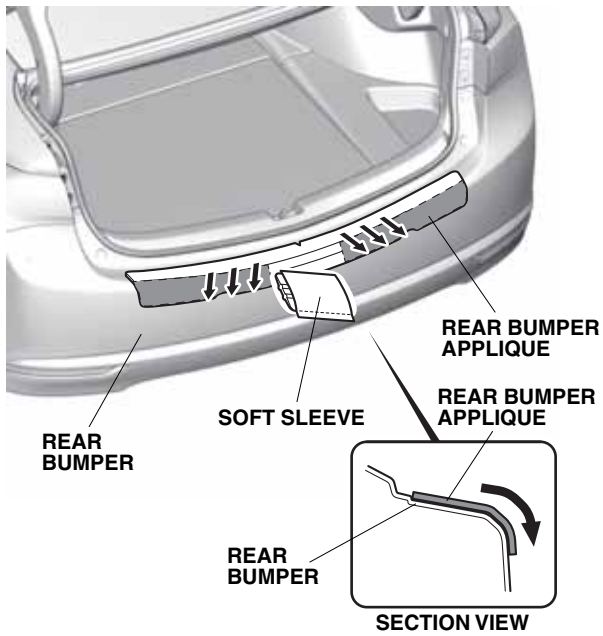

QC02105BA

12. Using a shop towel, wipe off any excess tape application solution. Allow the applique to dry thoroughly.

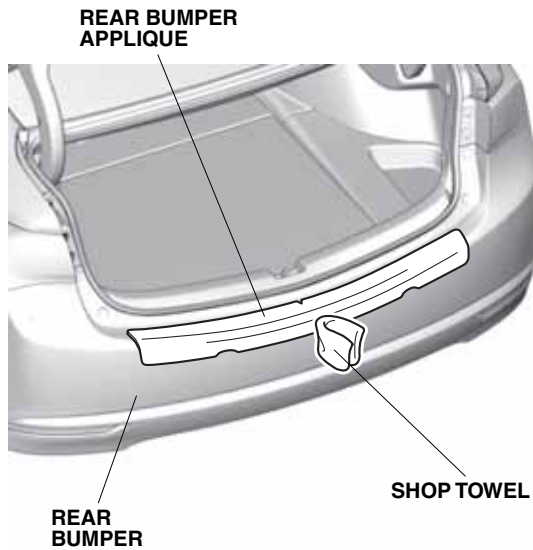

QC02106BA