



INSTALLATION INSTRUCTIONS

Accessory
TRAILER HITCH
P/N 08L92-TX4-200

Application
2017 RDX

Publications No.
VERSION 1
Issue Date
FEB 2016

PARTS LIST

Trailer hitch

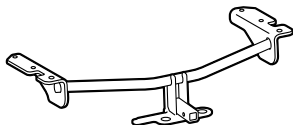

Ball mount

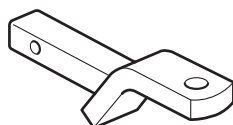

Right plate



Left plate

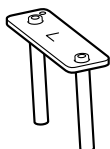

2 Bolts, 12 x 190 mm



2 Bolts, 12 x 175 mm

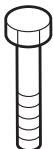

2 Bolts, 12 x 40 mm

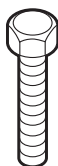

4 Nuts, 12 mm



10 Plain washers, 12 mm



6 Spring washers, 12 mm



2 Spacers



Hitch pin



Hitch pin clip



Receiver cover

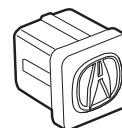

TOOLS AND SUPPLIES REQUIRED

Phillips screwdriver
Small flat-tip screwdriver
19 mm Sockets
Pushpin
Ratchet
3 mm Drill bit
20 mm Hole saw
Eye protection (face shield, safety goggles, etc.)
File
Blanket
Drill
Tape
Utility knife
Torque wrench
Ruler

The following tools are available through the Honda Tool and Equipment Program. On the iN, click on: Service > Service Bay > Tool and Equipment Program, then enter the number under "Search". Or, call 888-424-6857.

Air saw (T/N AT192A)
Trim Tool Set (T/N SOJATP2014)

Illustration of the Trailer Hitch on the Vehicle

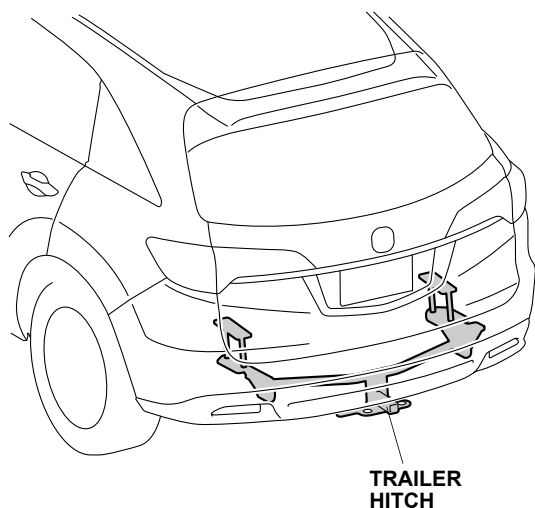

INSTALLATION

Client Information: The information in this installation instruction is intended for use only by skilled technicians who have the proper tools, equipment, and training to correctly and safely add equipment to your vehicle. These procedures should not be attempted by "do-it-yourselfers."

1. Remove the cargo area floor.

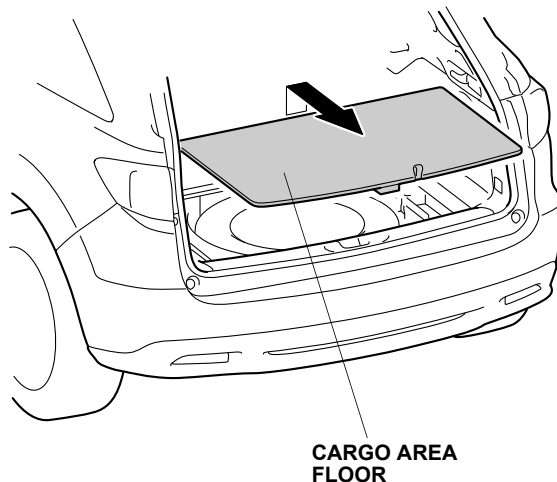

2. Remove the rear bumper.
 - On each side of the vehicle, apply masking tape to the rear bumper, taillight, and rear fender as shown.

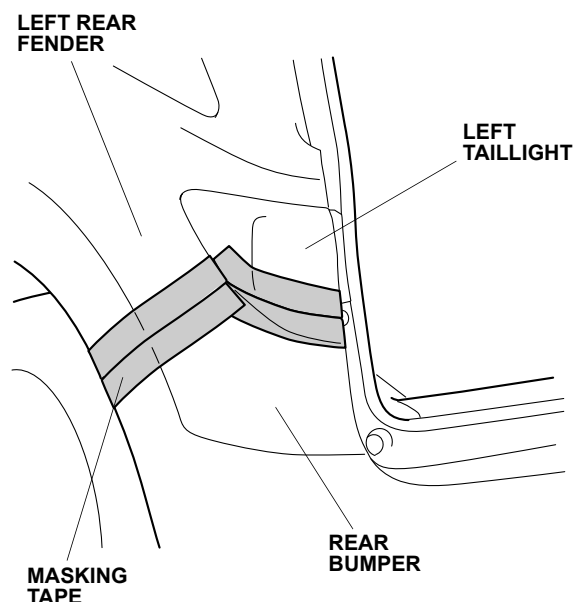

- Remove two covers, two bumper screws, two bolts, four self-tapping screws, and six clips.

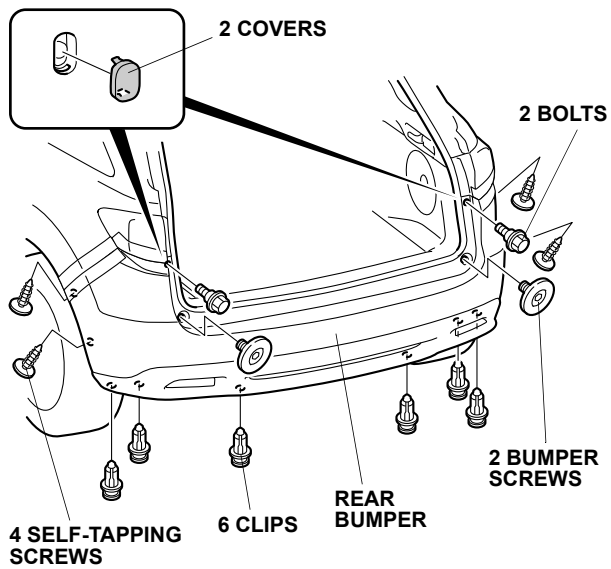

- Release six retaining tabs on each side.

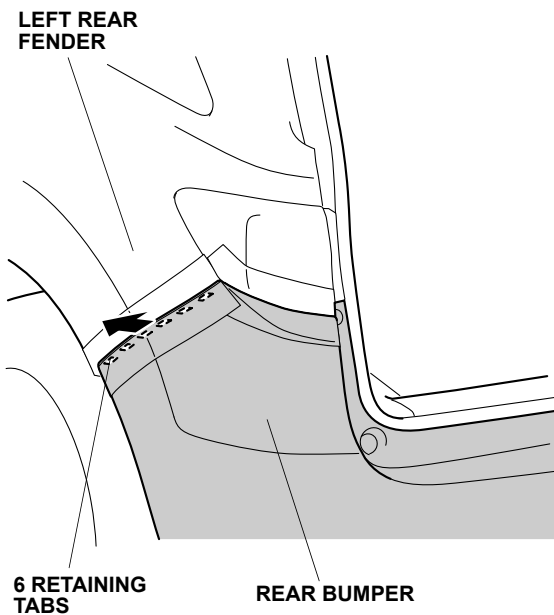

- Release one retaining tab on each side.

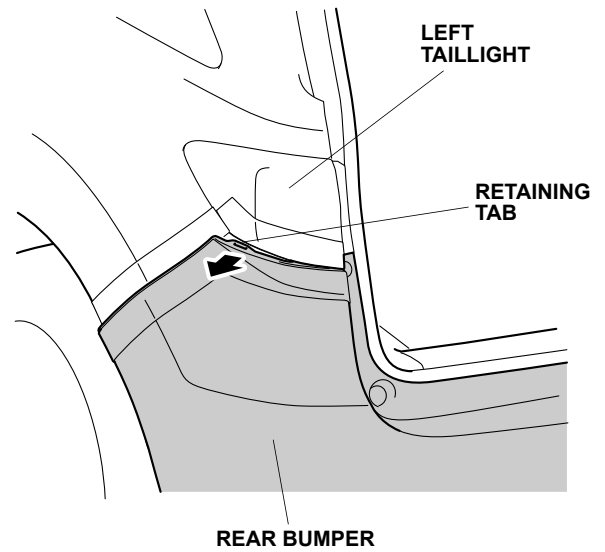

- With the help of an assistant, remove the rear bumper.
- Place the rear bumper on a blanket.

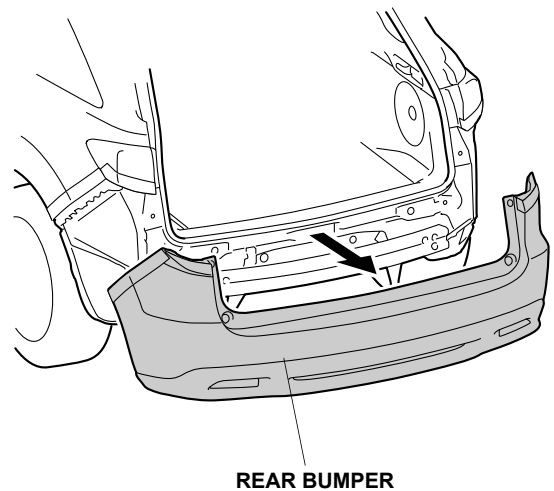

- Release the muffler by removing the muffler hanger bushings from the hangers.

NOTE: Be careful not to damage the muffler.

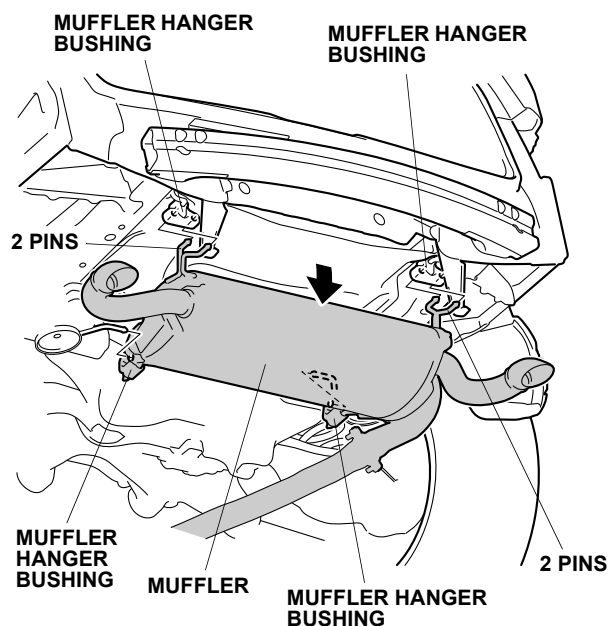

- Using a pushpin, pierce the centers of the two scribe marks on the inside of the rear bumper.

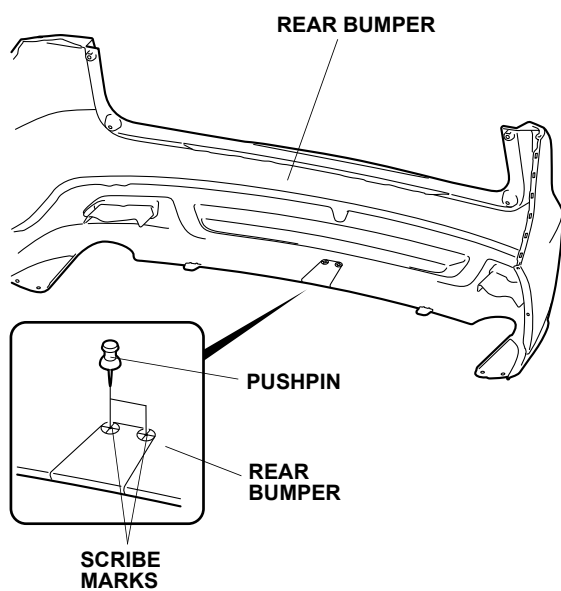

- While wearing eye protection, drill the two pierced marks with a 3 mm drill bit, then enlarge the holes with a 20 mm hole saw.

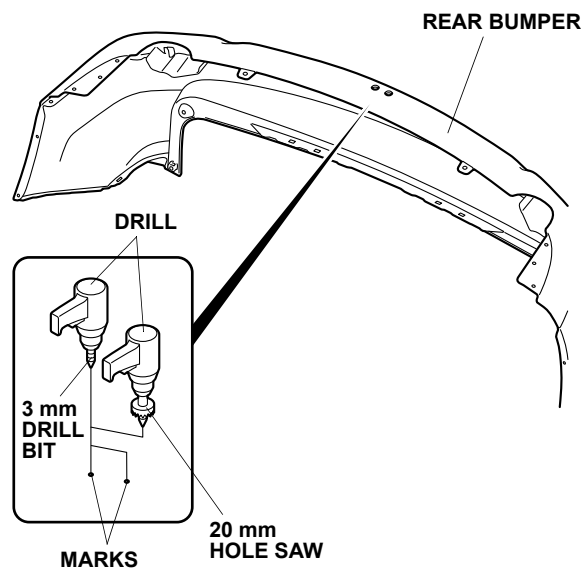

- Using an air saw, cut the rear bumper along the two scribe lines.

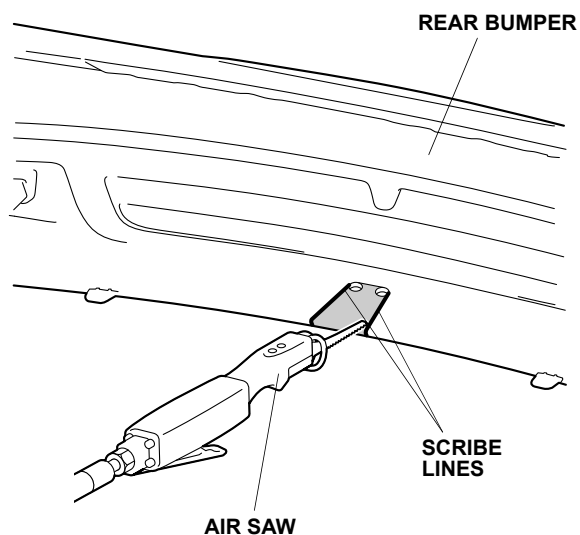

7. Using the air saw, cut the rear bumper between the two 20 mm holes. Remove any burrs.

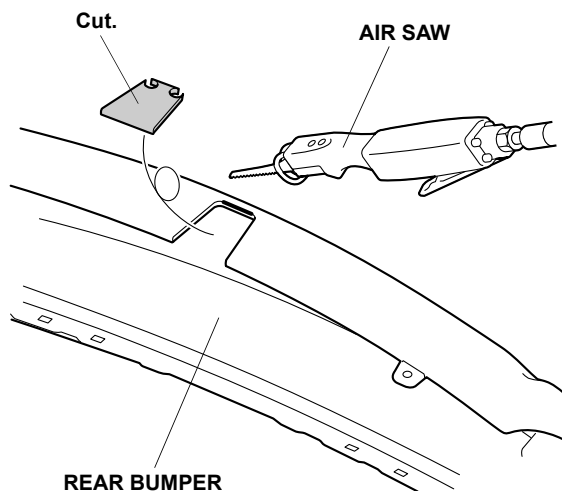

8. Inside the cargo area, use a utility knife to cut the left spacer at the scribe lines.

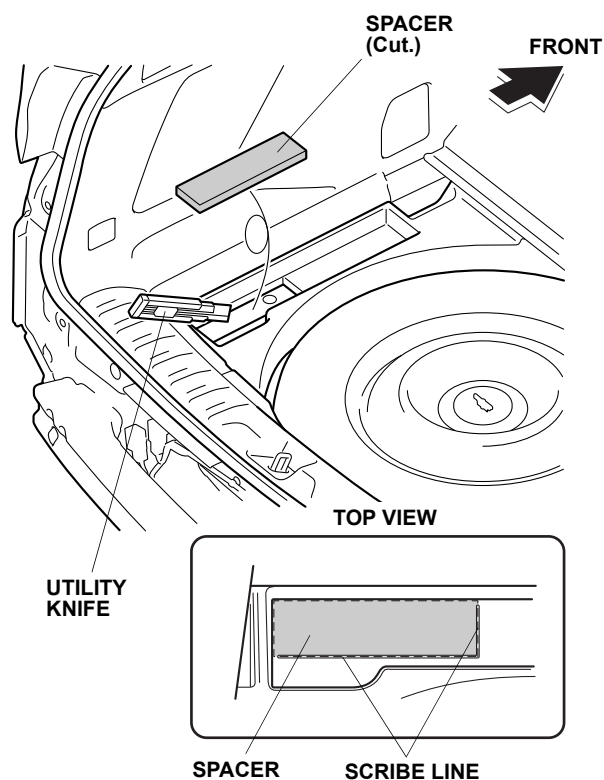

9. Using a utility knife, cut out an additional piece of the left spacer at the measurements shown.

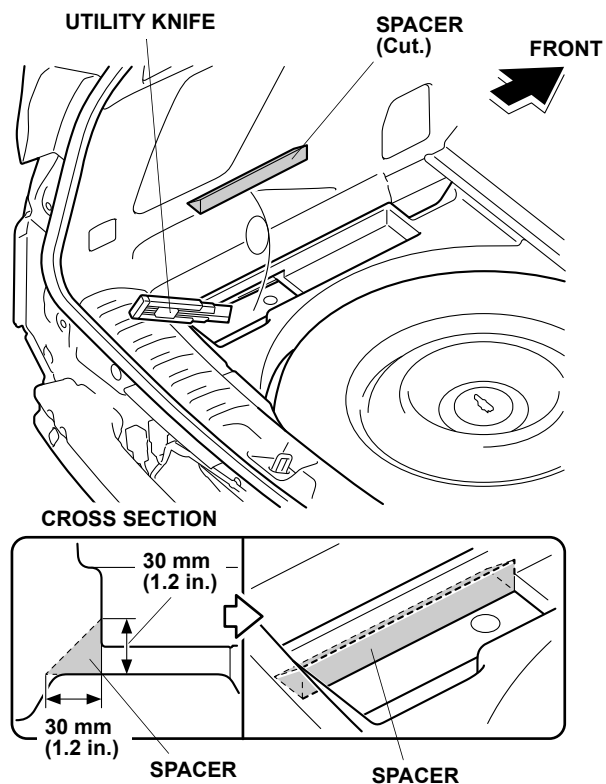

10. Repeat steps 8 and 9 to cut the right spacer.
11. Locate and remove the four vehicle grommets. Discard the four grommets.

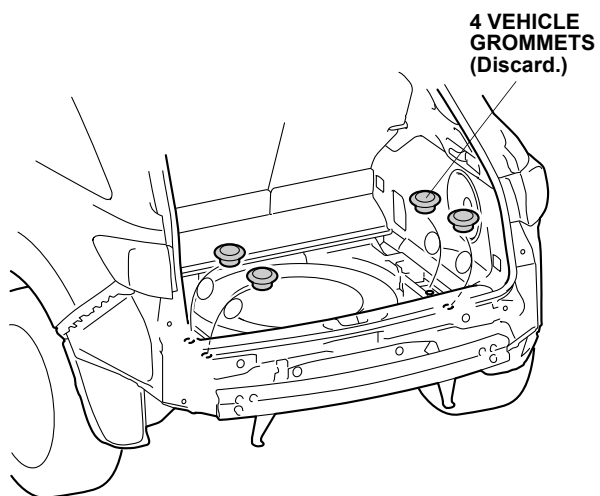

12. Insert the right and left trailer hitch plates through the grommet holes.

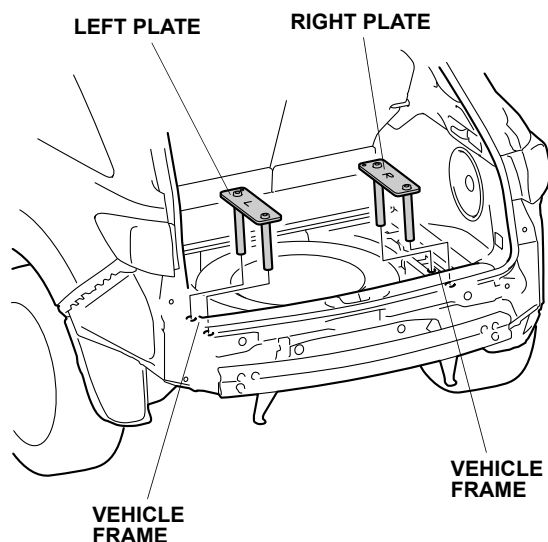

13. With the help of an assistant, insert two spacers between the trailer hitch and the vehicle frame. Mount the trailer hitch using two loosely-installed 12 x 40 mm bolts with spring washers and plain washers. Be careful that the spacers do not fall out during installation.
 NOTE: If there is undercoating in the area where the spacers seat, remove it before installing the spacer. Be careful not to damage the vehicle frame.

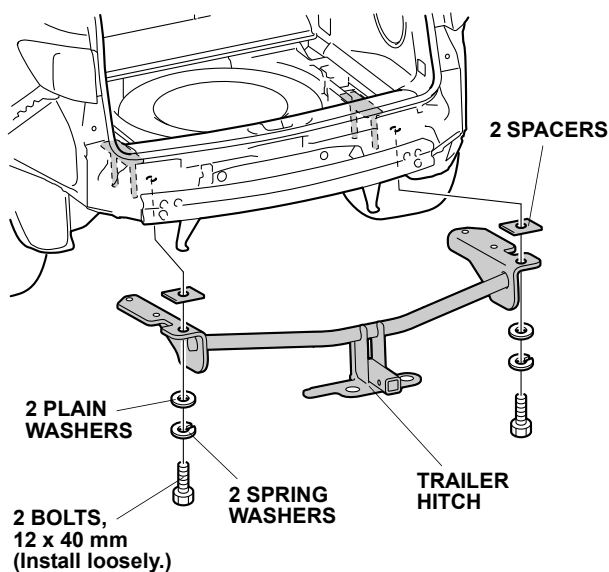

14. Install the trailer hitch to the right and left plates using two 12 x 190 mm bolts with plain washers in the front holes, and two 12 x 175 mm bolts with plain washers in the rear holes. Install one plain washer, one spring washer and one 12 mm nut to each bolt. Do not tighten at this time.

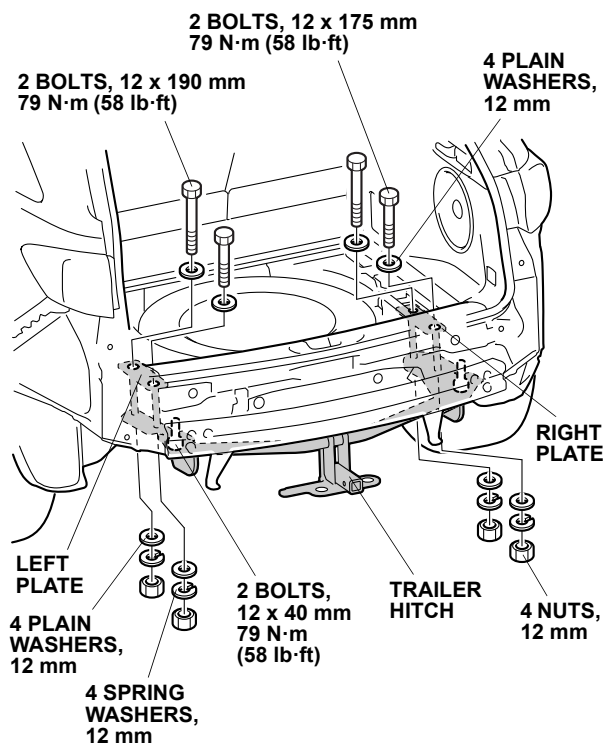

15. Tighten the 12 x 40 mm bolts installed in step 13. Then tighten the 12 x 190 mm bolts and the 12 x 175 mm bolts. Torque all of the 12 mm nuts and bolts to 79 N·m (58 lb·ft).
16. If you are also installing a trailer harness (sold separately), install it before reinstalling any removed parts.

Give a copy of this page to your Client

Whenever you remove the hitch pin clip, the hitch pin, and the ball mount, store them securely in the cargo area. Install the receiver cover into the opening at the end of the trailer hitch. When you reinstall the ball mount, store the receiver cover in the cargo area.

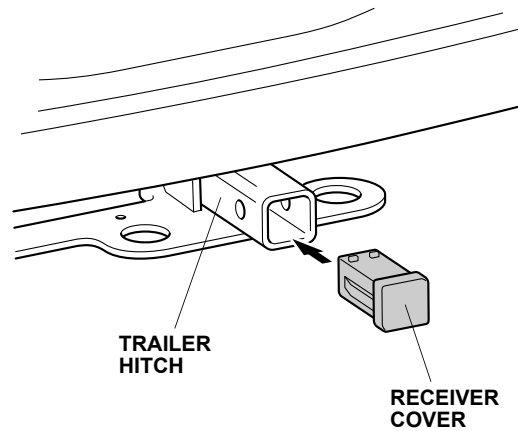

Install the ball mount to the trailer hitch using a hitch pin and hitch pin clip.

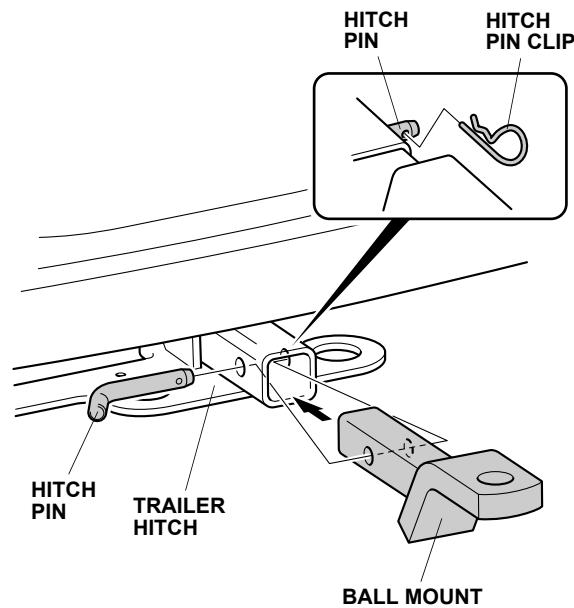

After the first 600 miles (1,000 km) of towing, have your Acura Dealer re-check the tightness of the trailer hitch bolts.