



INSTALLATION INSTRUCTIONS

Accessory
AUTOMATIC DAY/NIGHT MIRROR

Application
**2015 ILX
2015 ILX Hybrid**

Publications No.
BII 51685
Issue Date
MAY 2014

PARTS LIST

**Attachment Kit
P/N 08V03-TX6-200**

Automatic day/night mirror harness

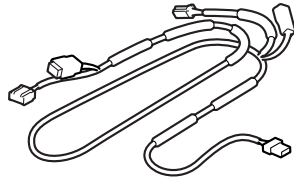

Harness cover

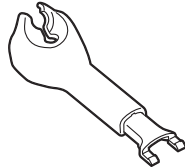

6 Wire ties

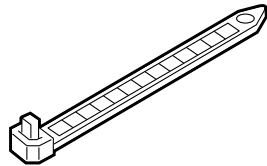

Clip

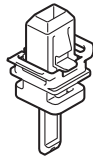

Urethane tape



Fuse label

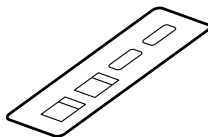

Automatic Day/Night Mirror Kit P/N 08V03-TR0-100A

Automatic day/night mirror

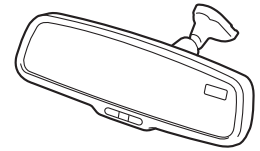

Operating Instructions

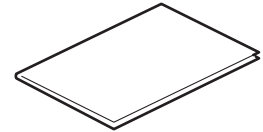

TOOLS AND SUPPLIES REQUIRED

Flat-tip screwdriver

Ratchet

10 mm Socket

Needle nose pliers

Isopropyl alcohol

Shop towel

Ruler

Diagonal cutters

Torque wrench

T20 TORX bit

Flashlight

Tape

The following tools are available through the Honda Tool and Equipment Program. On the iN, click on: Service > Service Bay > Tool and Equipment Program, then enter the number under "Search". Or, call 888-424-6857.

- Trim Tool Set (T/N SOJATP2014)
- Plastic Trim Tool (T/N SILTRIMTL10)

Illustration of the Automatic Day/Night Mirror in the Vehicle

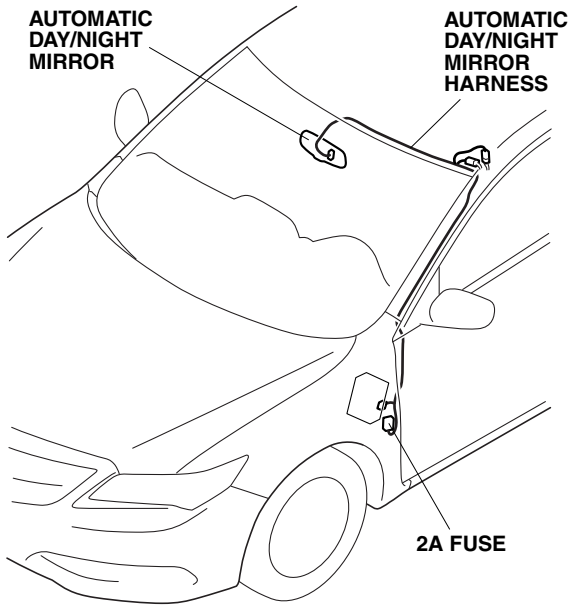

INSTALLATION

Client Information: The information in this installation instruction is intended for use only by skilled technicians who have the proper tools, equipment, and training to correctly and safely add equipment to your vehicle. These procedures should not be attempted by “do-it-yourselfers.”

1. Disconnect the negative cable from the battery.

2. Using a plastic trim tool, remove the left and right lenses from the front roof module (two retaining tabs for each lens). Remove two bolts.

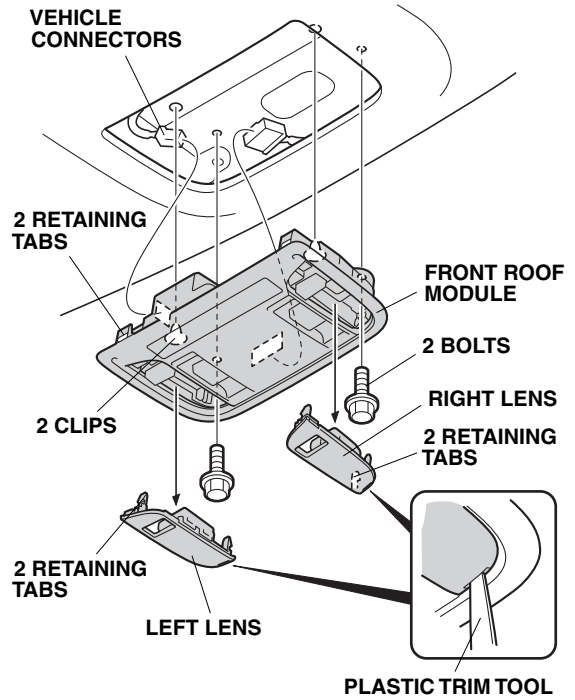

3. Remove the front roof module (two clips, two retaining tabs, and unplug the vehicle connectors).
4. Remove the driver's and passenger's sunvisor holders by turning them 45° in the counterclockwise direction.

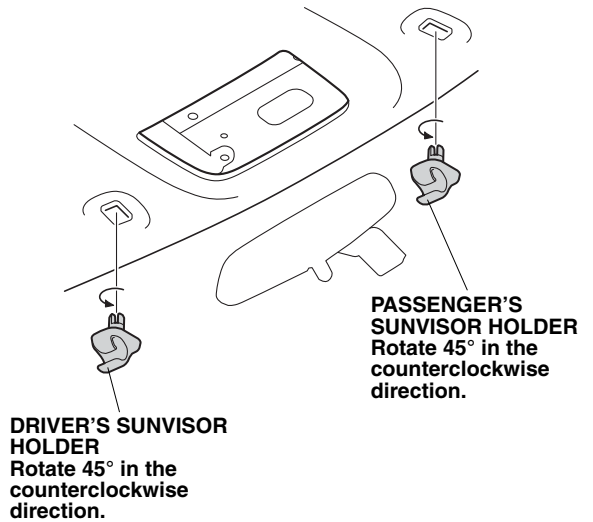

5. Remove the rearview mirror.

Base Model

- Remove the cover (two retaining tabs).
- While holding down the hook as shown, remove the rearview mirror from the mirror mount.

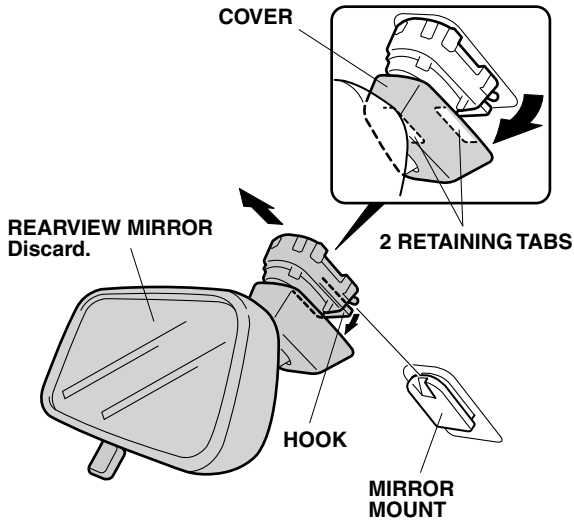

Non Base Model

- Remove the TORX screw.
- Remove the rearview mirror from the mirror mount.

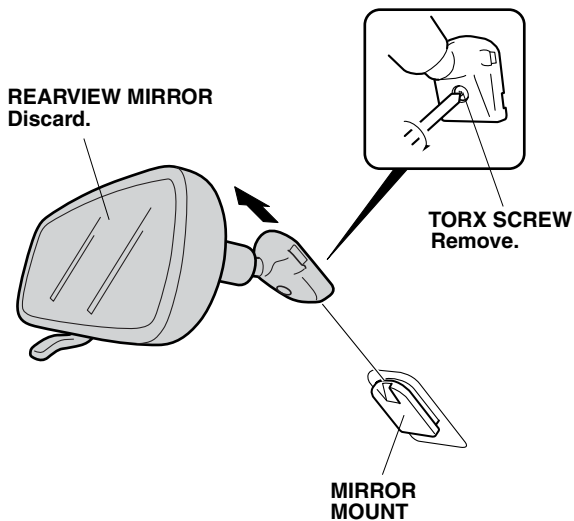

6. Remove the driver's sunvisor:

- Pivot the left sunvisor downward.
- Wrap tape around the tip of flat-tip screwdriver.
- Locate the slot in the bracket cover, and insert the flat-tip screwdriver into the slot. Push in and hold the retaining tab.
- While holding the retaining tab, push up on the sunvisor and rotate it toward the door.

NOTE: If the retaining tab did not stay pushed in, return the sunvisor to its original position and repeat this step.

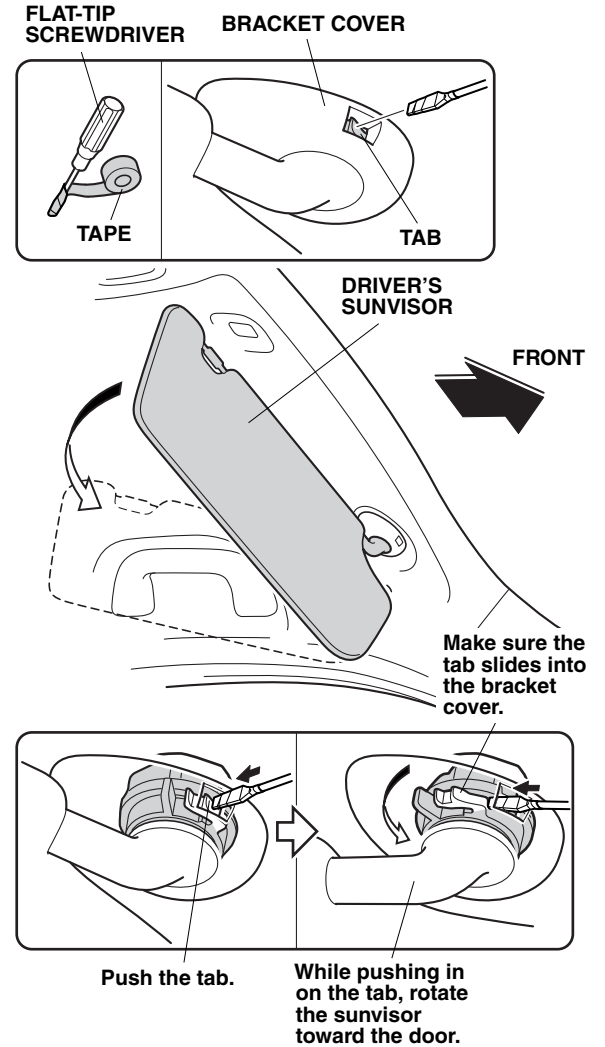

- Unplug the vehicle connector, and remove the driver's sunvisor.

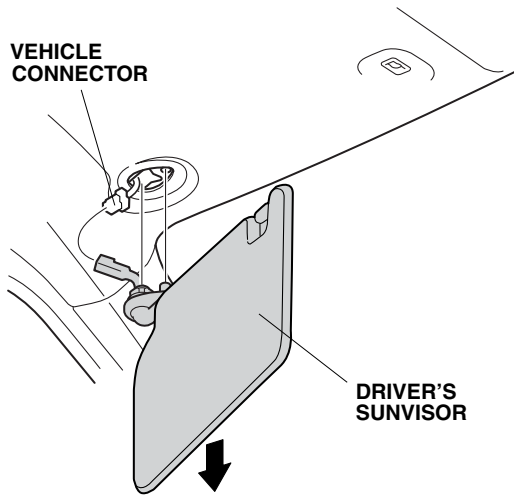

7. Remove the driver's A-pillar trim.
- Pull away the driver's door opening seal from the A-pillar trim.
 - Gently pull the A-pillar trim away from the A-pillar to release the three clips.

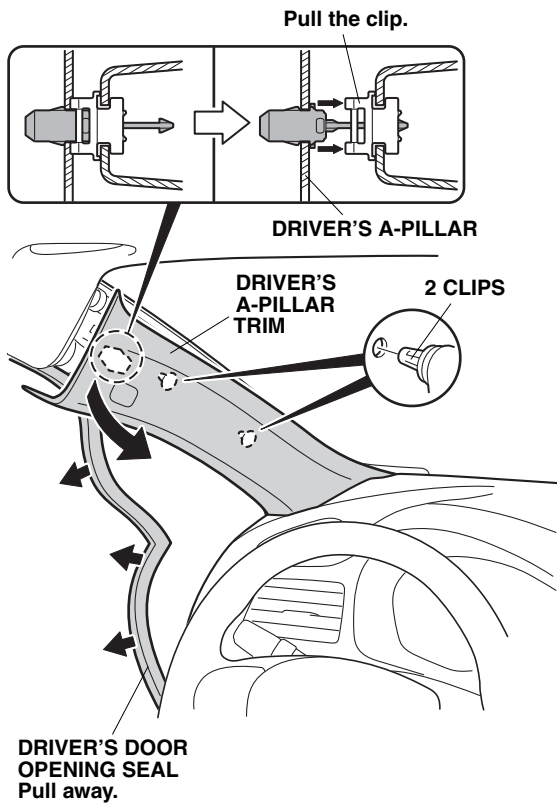

- To prevent clips from falling into the body panel area, carefully insert a shop towel between the driver's A-pillar and the driver's A-pillar trim.

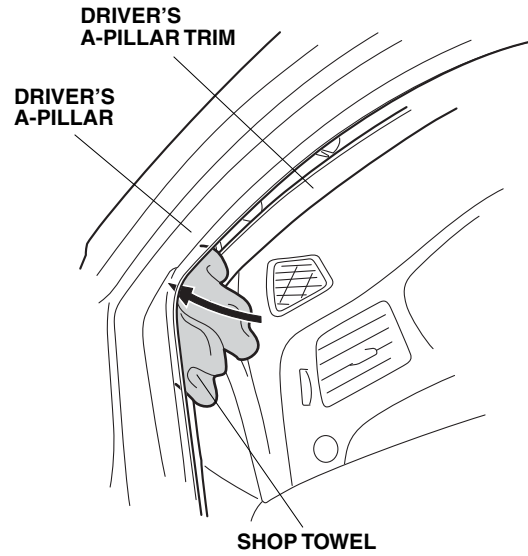

- Slide the driver's A-pillar trim upward, and remove the driver's A-pillar trim.
- Remove the shop towel and any clips.

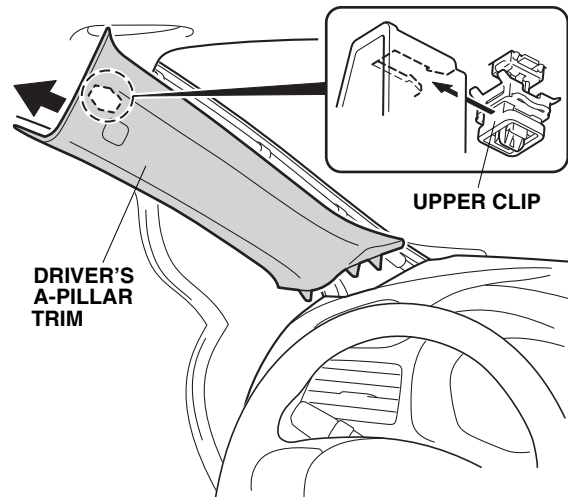

- Remove the remaining upper clip from the driver's A-pillar.

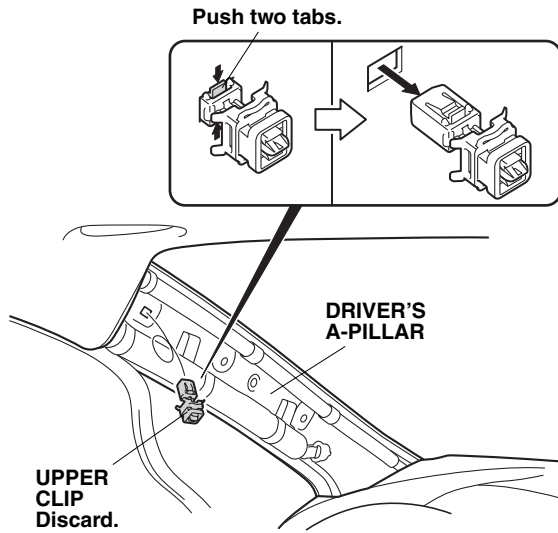

- Install the new clip (supplied) to the driver's A-pillar trim.
NOTE: When reinstalling the A-pillar trim, refer to the Service Manual for the correct overlap procedure.

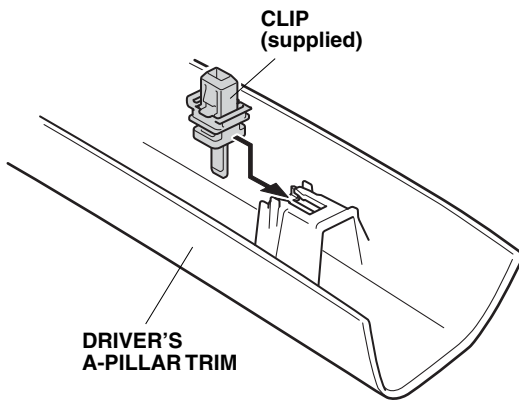

- Pull down the left grab rail and remove two caps (four retaining tabs).

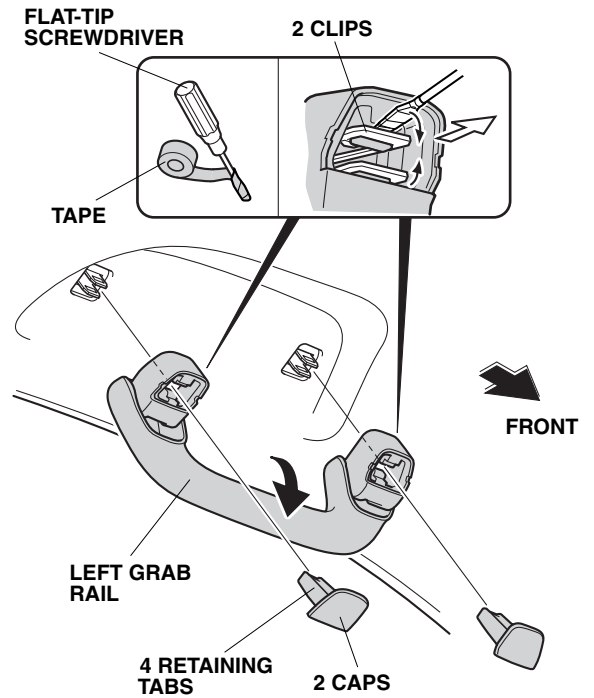

- Using a flat-tip screwdriver wrapped with tape, remove the left grab rail (release two clips).
- Remove the driver's dashboard lower cover (nine clips, and unplug the vehicle connector).

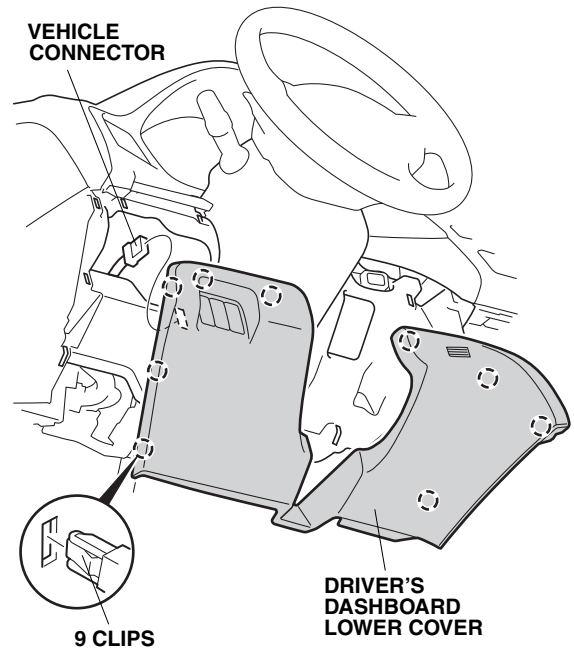

13. Install the automatic day/night mirror on the mirror mount as shown, and tighten the TORX screw.

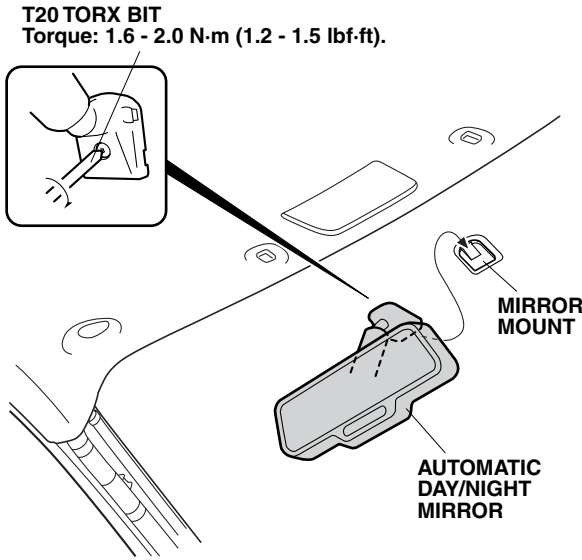

14. Using isopropyl alcohol on a shop towel, thoroughly clean the area where the fuse label will attach.

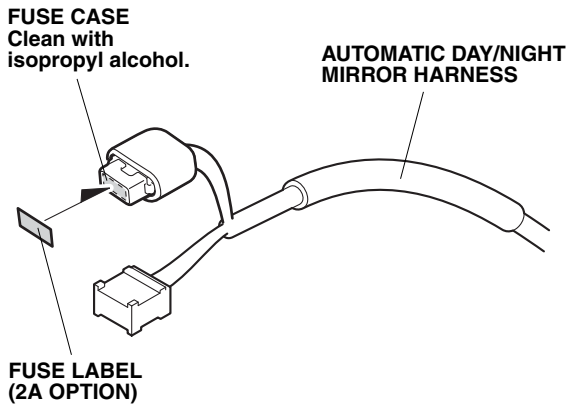

15. Attach the fuse label to the automatic day/night mirror harness fuse case.

Without Another Accessory Harness 6-pin connector

16. Plug the automatic day/night mirror harness 6-pin connector into the fuse box 6-pin connector. Go to step 18.

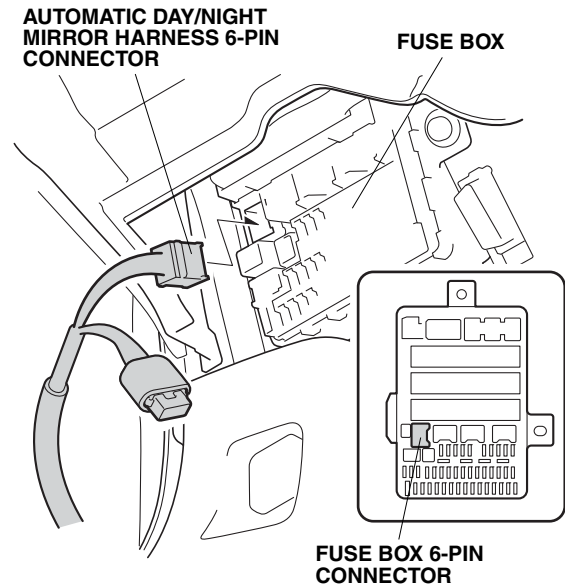

With Another Accessory Harness 6-pin connector

17. If the fuse box 6-pin connector is already used by another accessory, locate the 6-pin connector taped to the other accessory harness. Plug the automatic day/night mirror harness 6-pin connector into the other accessory harness 6-pin connector.

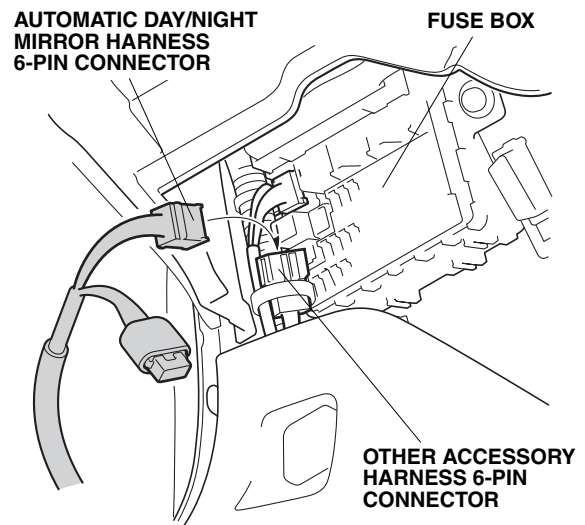

18. Secure the automatic day/night mirror harness to the vehicle harness with two wire ties.

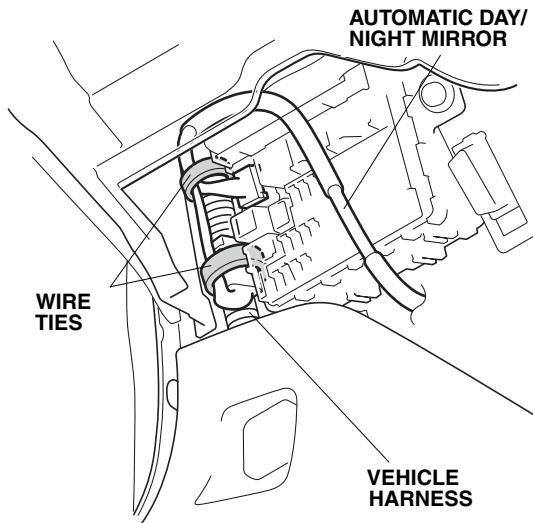

19. Route the automatic day/night mirror harness toward the outside of the vehicle as shown.

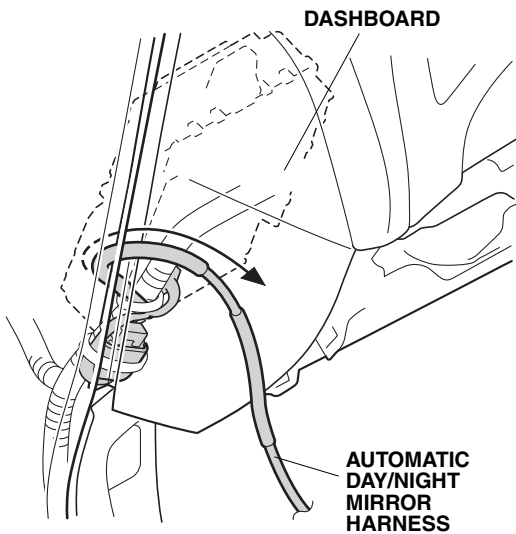

20. Insert the automatic day/night mirror harness between the dashboard and the driver's A-pillar.

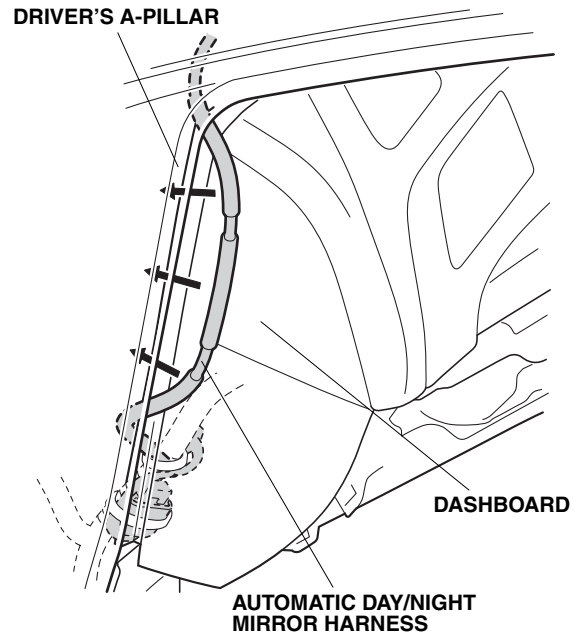

21. Align the green tape on the automatic day/night mirror harness with the vehicle clip, and secure the automatic day/night mirror harness to the vehicle harness with one wire tie as shown.

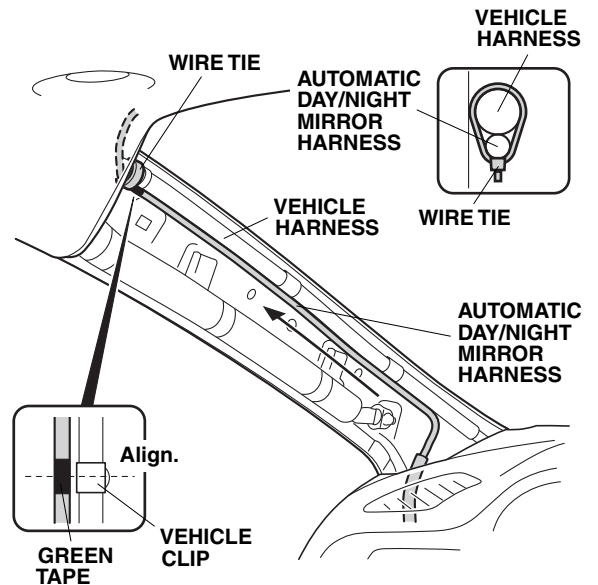

22. Secure the automatic day/night mirror harness to the vehicle harness with three wire ties as shown.

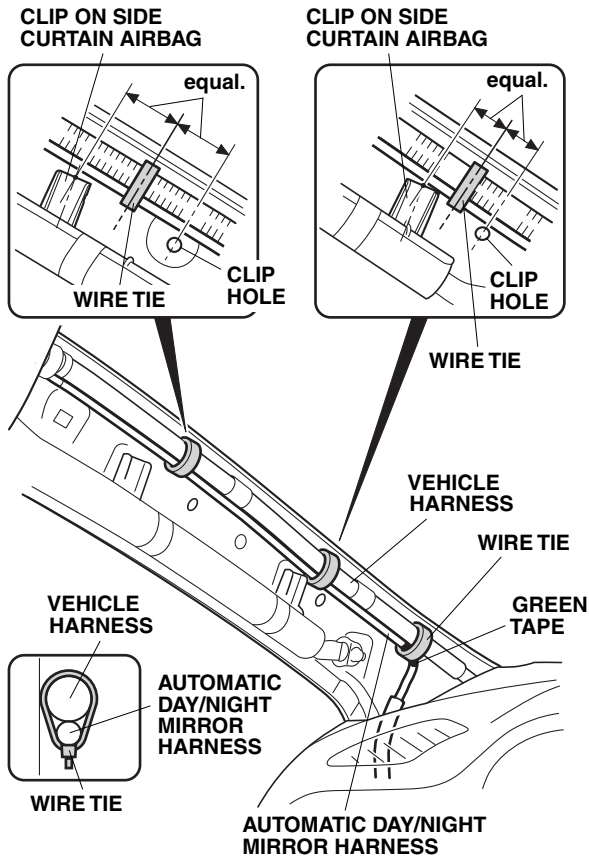

23. Pull the two automatic day/night mirror harness 2-pin connectors out through the hole in the headliner as shown. Be careful not to crease the headliner.

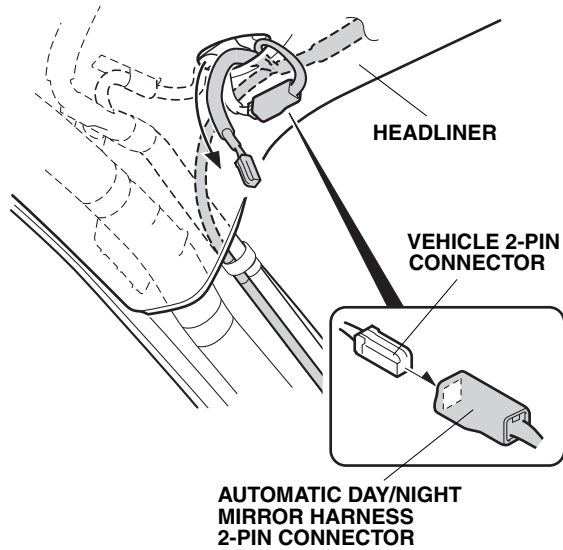

24. Plug the vehicle 2-pin connector into the automatic day/night mirror harness 2-pin connector.

25. Route the automatic day/night mirror harness behind the headliner as shown. Be careful not to crease the headliner.

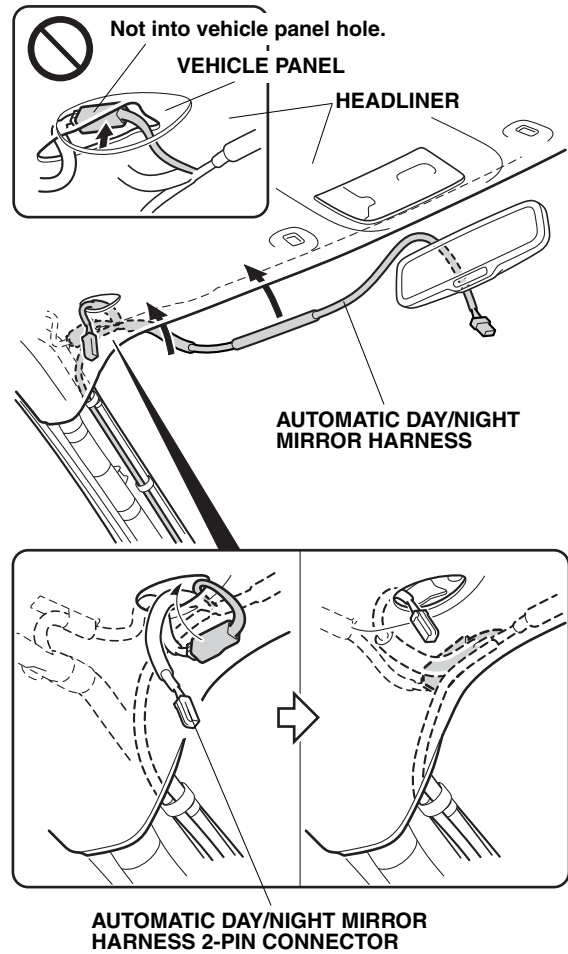

26. Plug the automatic day/night mirror harness 7-pin connector into the automatic day/night mirror.

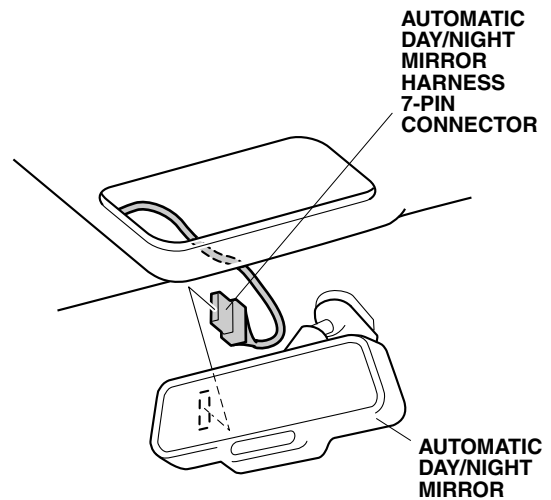

27. Route the automatic day/night mirror harness through the groove in the harness cover. Secure the harness cover to the mirror stay. Slide the harness cover behind the headliner.

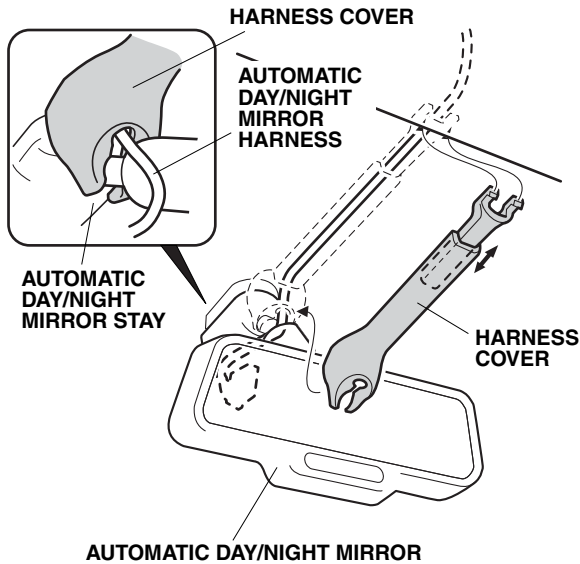

28. Using isopropyl alcohol on a shop towel, thoroughly clean the area where the urethane tape will attach. NOTE: Do not crease the headliner for the following procedure.

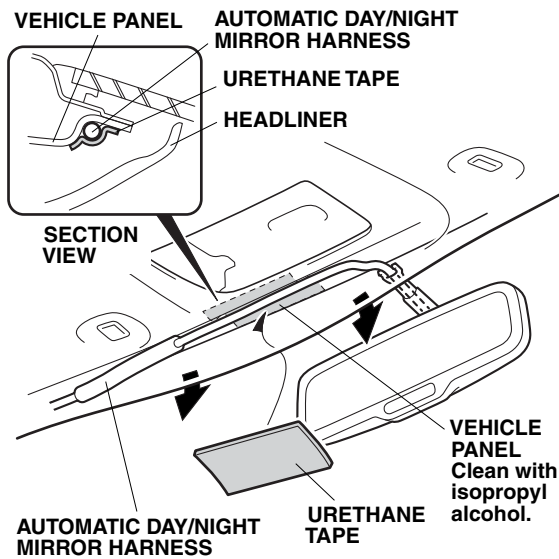

29. Secure the automatic day/night mirror harness to the vehicle panel with one urethane tape as shown. Be careful not to crease the headliner.

30. Plug the automatic day/night mirror harness 2-pin connector into the driver's sunvisor 2-pin connector.

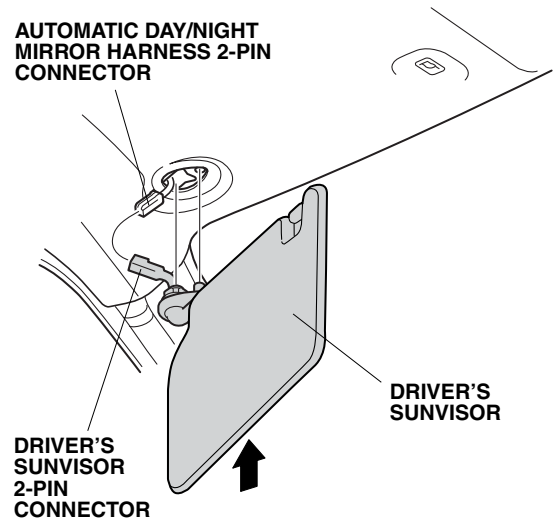

31. Reinstall the driver's sunvisor.
32. Using needle nose pliers, remove the two clips from the vehicle panel.

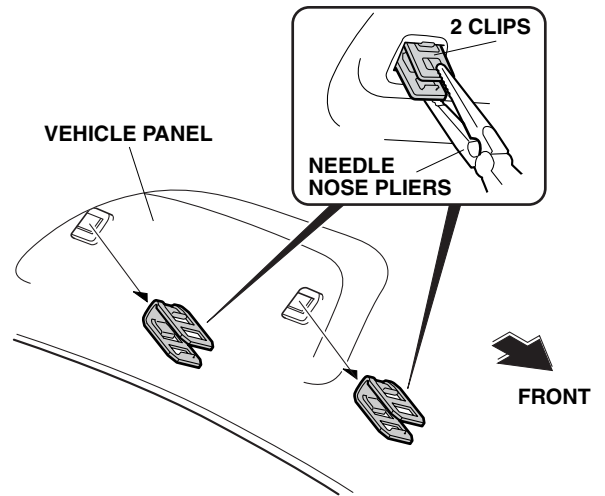

33. Reinstall the left grab rail with two clips. Reinstall the caps.

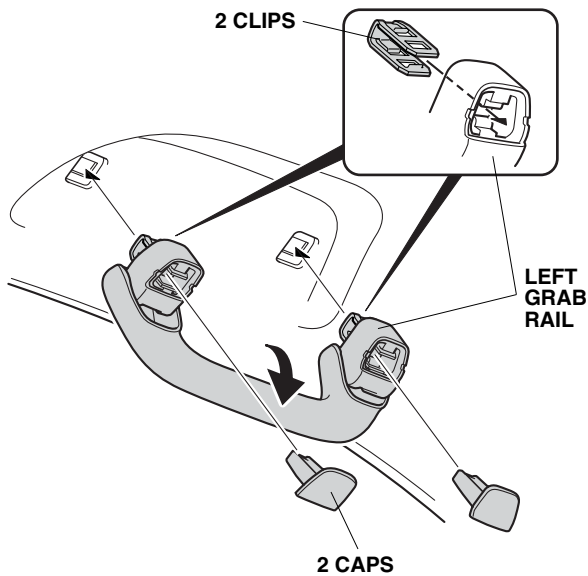

34. Check that all wire harnesses are routed properly and all connectors are plugged in.
35. Check the overlap between the headliner and the driver's A-pillar trim. Refer to the service manual. If necessary, adjust the overlap.
36. Reinstall all removed parts.
37. Reconnect the negative cable to the battery and check the operation of all lights and other electrical accessories.
38. Press and hold the radio power button for two seconds to restore the radio and navi (if equipped) system functions.
39. Reset the clock (non-navi).
40. If the IMA battery level gauge is at zero, start the engine and hold the rpm between 3500 and 4000 (no load) in P or N position until the Charge/Assist meter indicates the IMA system has stopped charging the battery.
41. Do the Function Check.
42. Adjust the zone and calibrate as required.
43. Put the Operating Instructions in the glove box.

FUNCTION CHECK

1. Turn the ignition switch to ON (II), but do not start the engine.

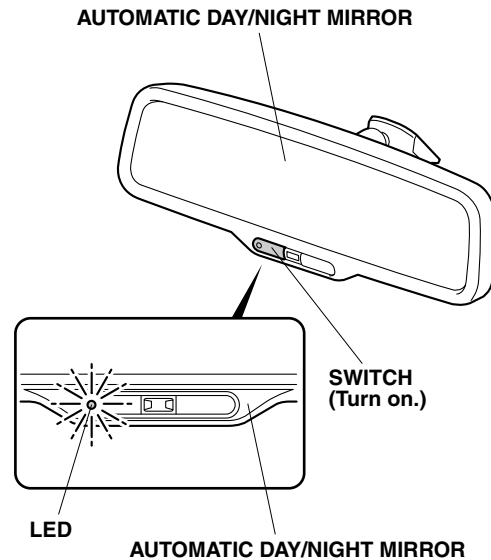

2. Turn on the switch. Check that the LED lights.
3. Cover the front sensor on the automatic day/night mirror with your hand, and use a flashlight to light the rear sensor on the automatic day/night mirror. Make sure the mirror surface dims.

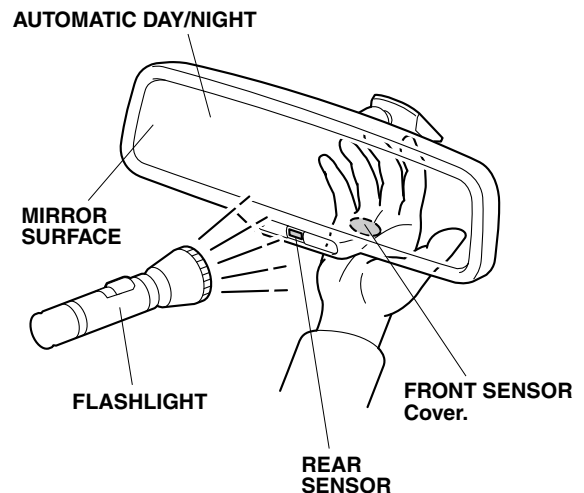

4. Step on the brake pedal, and move the select lever to the "R" position. Repeat step 3, and make sure the mirror surface does not dim.
- Make sure that the parking brake is set securely.
 - If the automatic day/night mirror does not function properly, check the fuse and all connectors.