



# INSTALLATION INSTRUCTIONS

Accessory

LUGGAGE NET  
P/N 08L96-TL2-200

Application

2014 TSX

Publications No.

BII 50192

Issue Date

SEPT 2013

## PARTS LIST

Luggage net

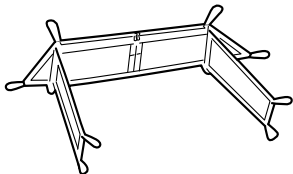

4 "T" anchors



6 Snap hooks



2 D-Rings

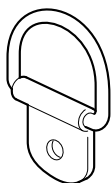

2 Nuts



6 Spring washers



2 Rivet nuts



2 6 x 20 mm Hex bolts



2 6 x 16 mm Hex bolts



2 Plain washers



2 6 x 20 mm Flange bolts

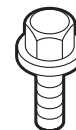

Accessory User's  
Information Manual

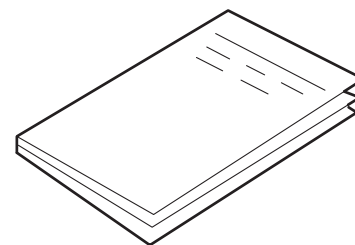

## TOOLS AND SUPPLIES REQUIRED

Pushpin  
Drill  
3 mm, 6.5 mm, and 9 mm Drill bits  
10 mm wrench  
Ratchet  
10 mm Socket  
19 mm Wrench  
Rivet Nut Tool (P/N 07AAE-000A100)  
Hex wrench  
Touch-up paint  
File  
Plastic Trim Tool (T/N SILTRIMTL10)  
Masking tape  
Eye protection (face shield, safety goggles, etc.)

### *Illustration of the Luggage Net in the Vehicle*

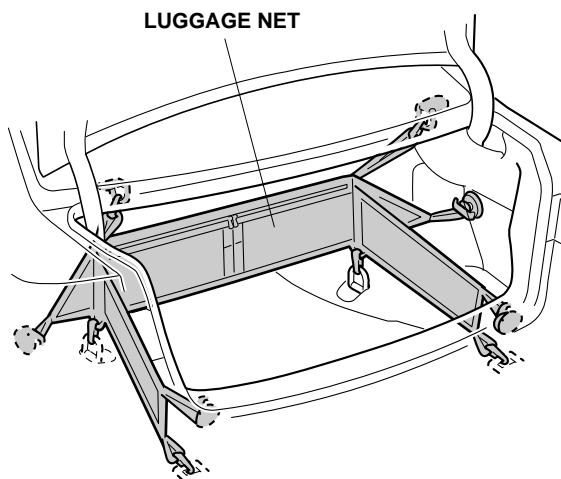

## INSTALLATION

**Client Information:** The information in this installation instruction is intended for use only by skilled technicians who have the proper tools, equipment, and training to correctly and safely add equipment to your vehicle. These procedures should not be attempted by “do-it-yourselfers.”

**NOTE:** Be careful not to damage the body.

1. Open the trunk and remove the spare tire lid (two clips).

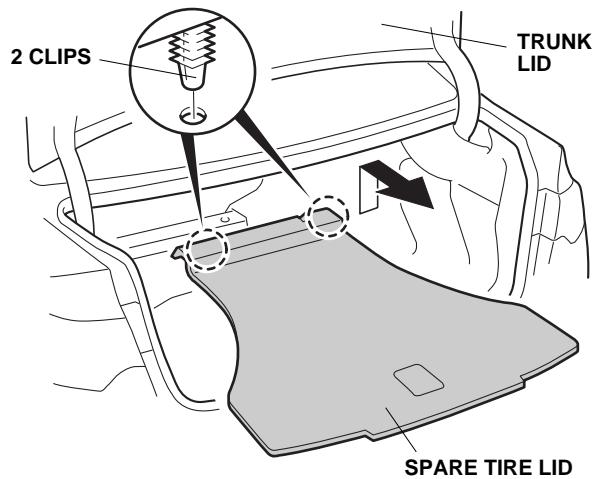

2. Pull away the weatherstrip and remove the trunk rear trim panel (five clips and two hooks).

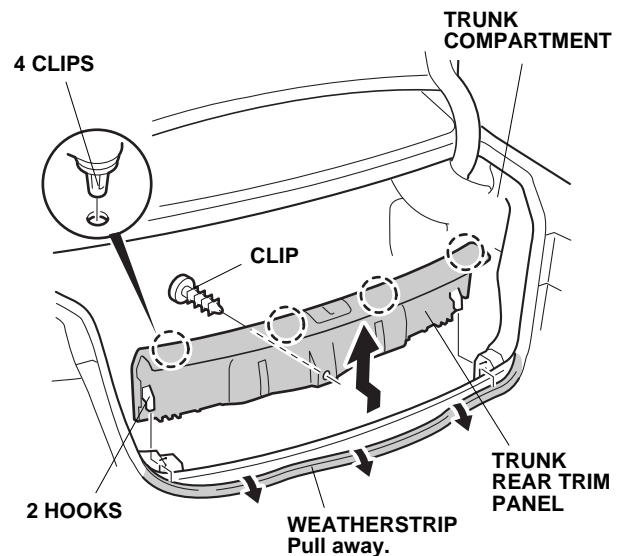

3. Pull the left and right rear seatback lock openers to tilt the left and right rear seatbacks forward.

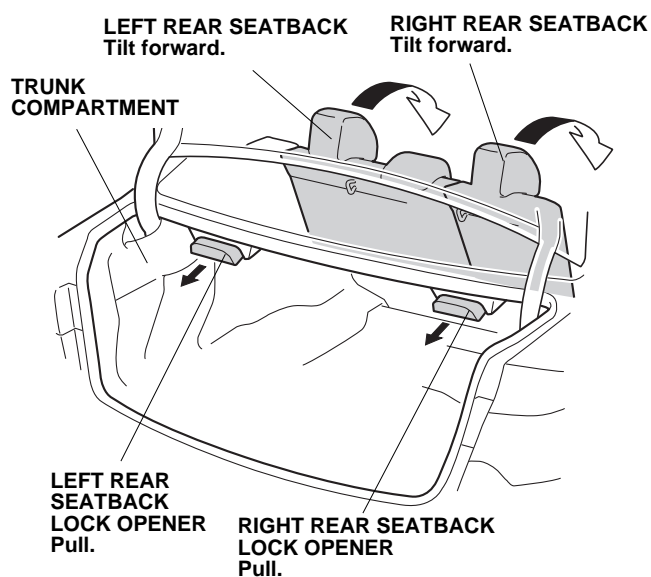

4. Remove the weatherstrip and remove the trunk right side trim panel (five clips and two anchors).

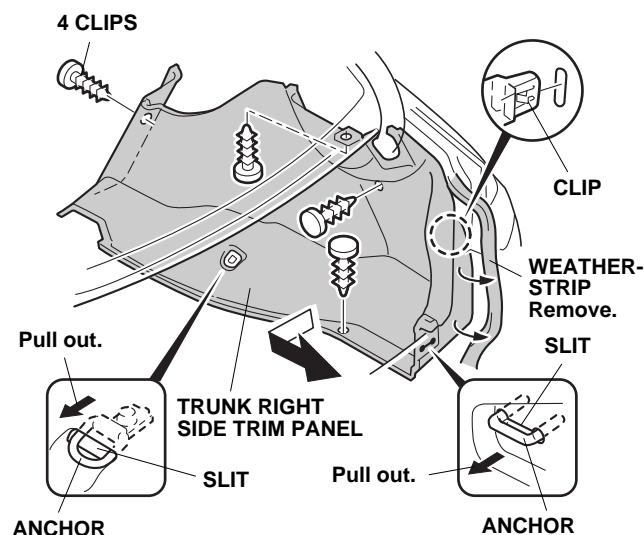

5. On the inside of the trunk right side trim panel, locate the preset mark in the location shown. Using a pushpin, pierce the center of the preset mark.

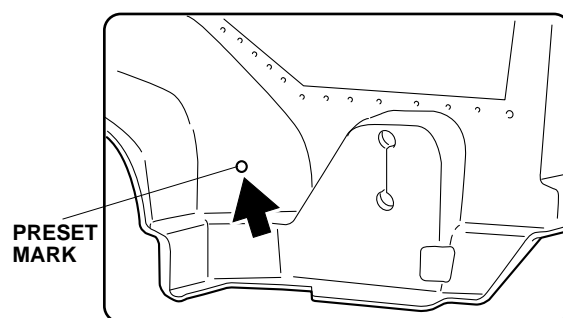
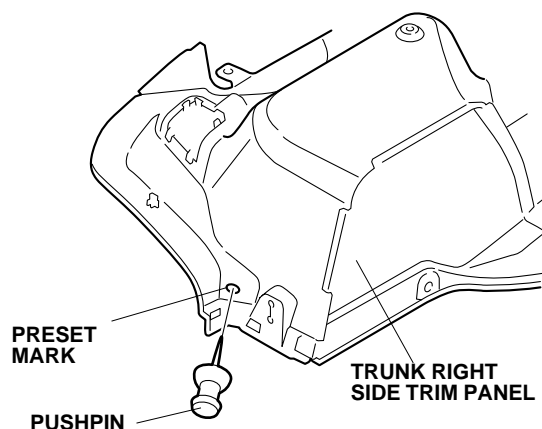

6. While wearing eye protection, drill the pierced mark to 6.5 mm. First drill with a 3 mm drill bit, and finish with a 6.5 mm drill bit.

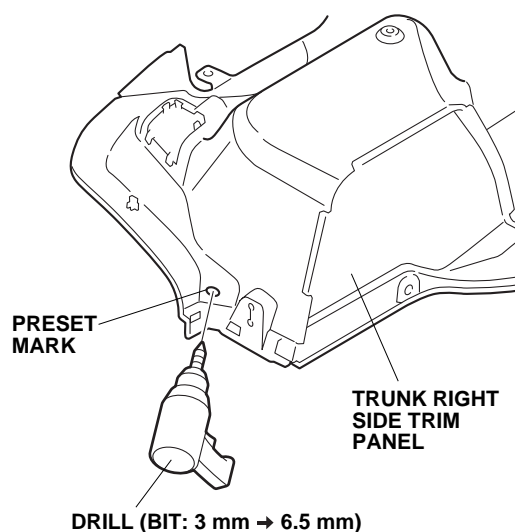

7. Install one 6 x 16 mm hex bolt, spring washer, plain washer, and T-anchor through the hole you just made. Tighten securely.

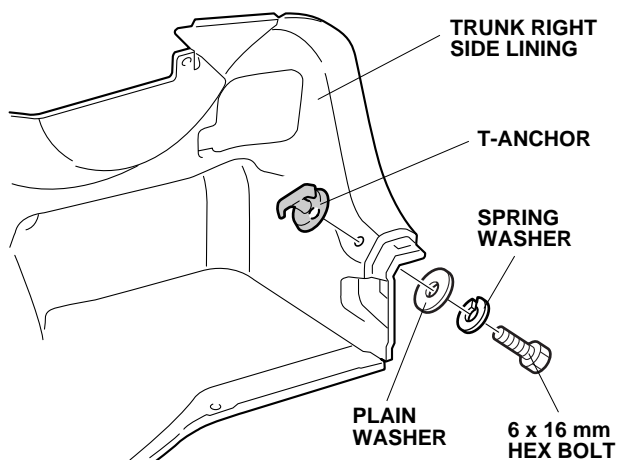

8. Loosen the bolts for the stereo amplifier, then move the amplifier to the side.

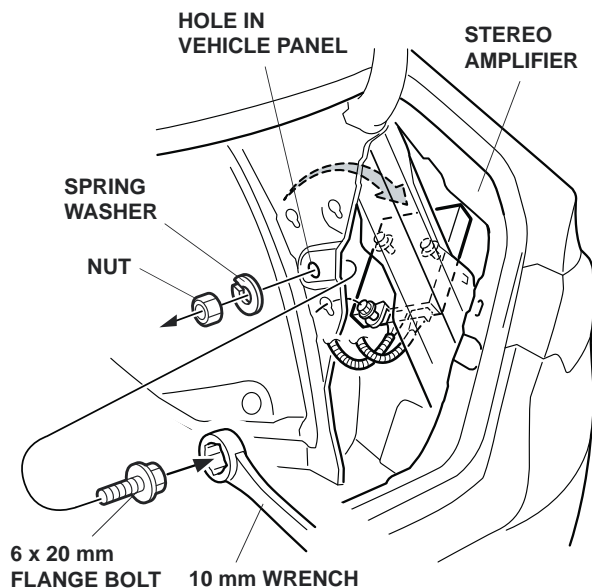

9. Locate the hole in the vehicle panel. Install one 6 x 20 mm flange bolt through the vehicle panel hole, then install a spring washer and nut. Reinstall the stereo amplifier.

10. In the rear metal shelf, locate the hole near the trunk right hinge arm.

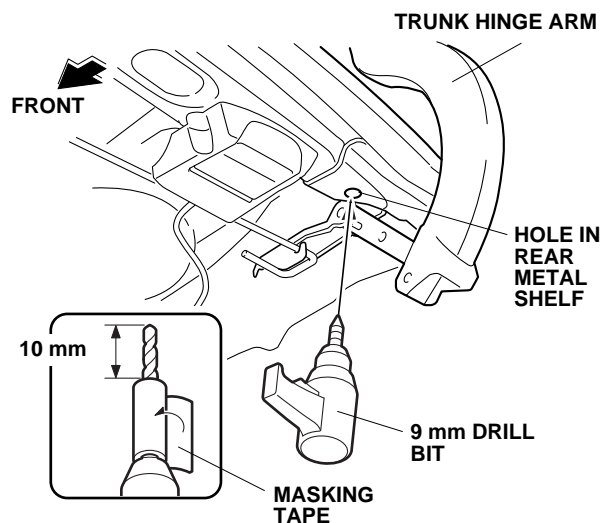

11. While wearing eye protection, enlarge the hole to 9 mm:
  - Wrap tape around the drill bit 10 mm away from the tip.
  - Cover the trunk floor with a blanket to collect shavings.
  - Remove all burrs from the edge of the hole, and apply touch-up paint to the edge of the hole. Allow the touch-up paint to dry before installing the rivet nut.
12. Install one rivet nut into the enlarged hole:
  - Thread one rivet nut onto the mandrel of the rivet nut tool.

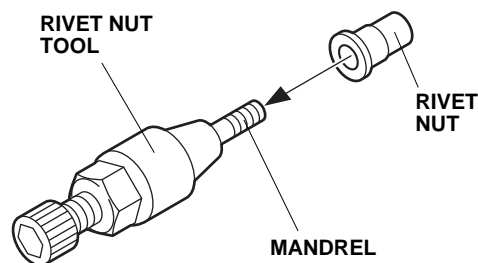

- Insert the rivet nut into the hole you just drilled, and install the hex wrench to the rivet nut tool.

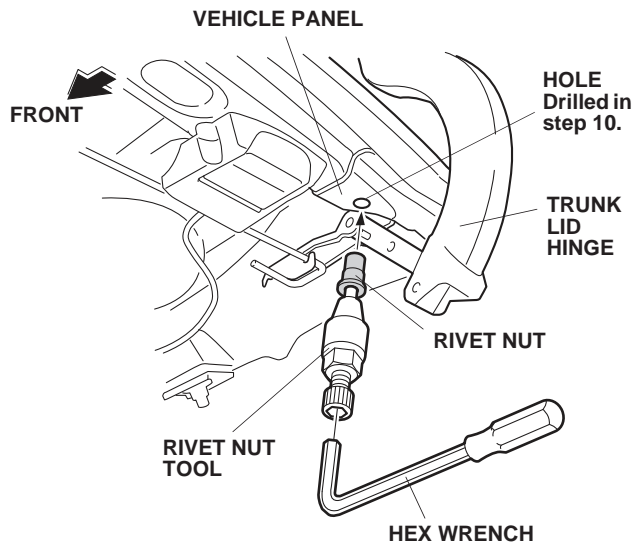

- While holding the tool with the hex wrench, use a 19 mm wrench to turn the tool in a clockwise direction until the rivet nut is fully collapsed.

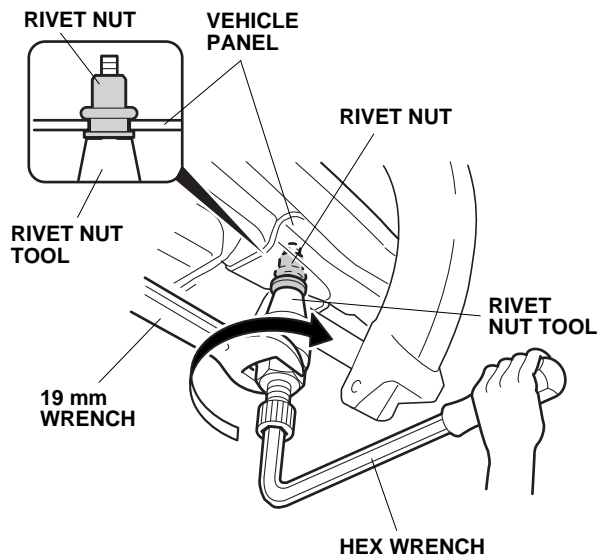

- Remove the tool from the rivet nut by turning the hex wrench counterclockwise.

- Reinstall the trunk right side trim panel. Install an anchor to the 6 x 20 mm flange bolt. Turn the T-anchor in the direction shown.

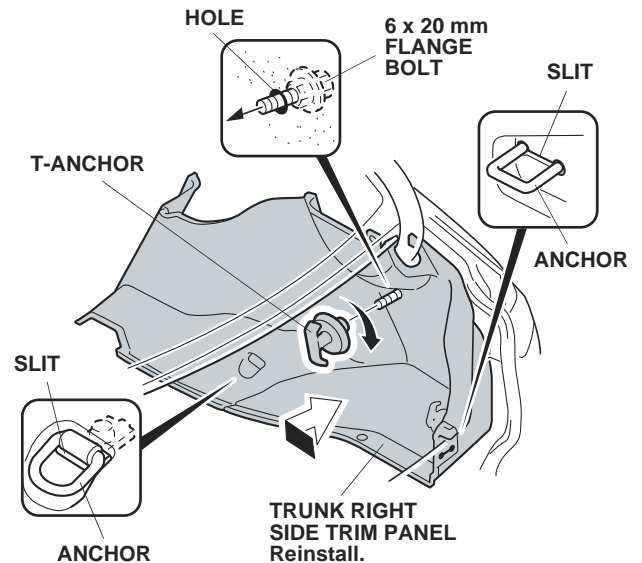

- Install a D-ring to the rivet nut in the rear metal shelf using one 6 x 16 mm hex bolt with a spring washer. Torque the hex bolt to 5 N·m (3.7 lb-ft).

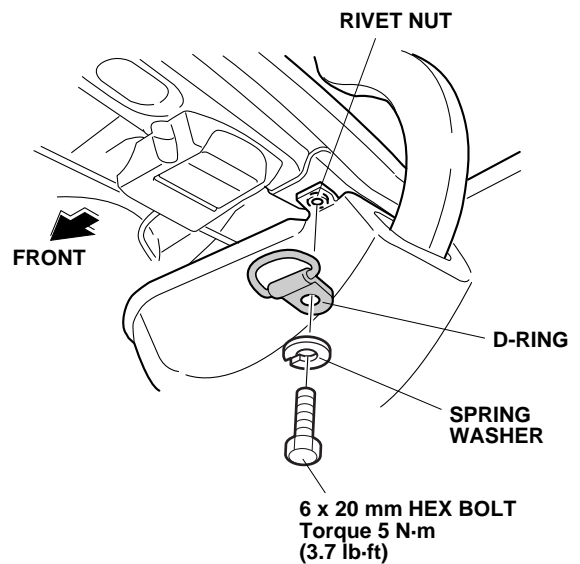

- Remove the trunk left side trim panel, and repeat steps 5 through 14 to install two T-anchors and a D-ring on the left side of the vehicle.

16. Unfold the luggage net and install the six snap hooks to each of the six loops shown.

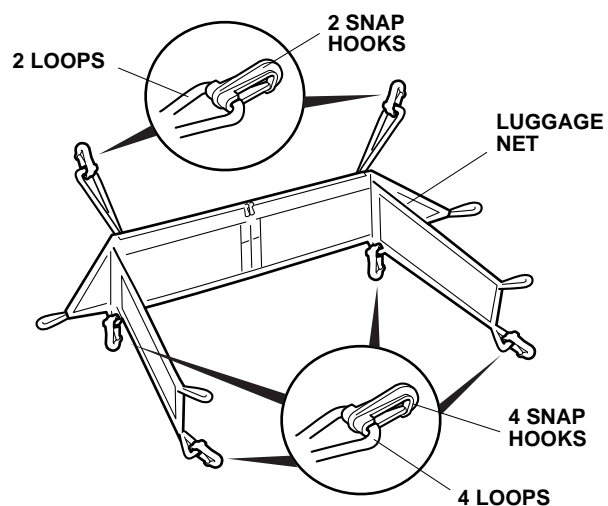

17. Reinstall all removed parts.
18. Secure the six snap hooks and four loops of the luggage net as shown.

