



INSTALLATION INSTRUCTIONS

Accessory
CARGO HOOK
P/N 08L96-TA0-101A

Application
2013 TSX

Publications No.
BII 13474
Issue Date
SEP 2012

PARTS LIST

Cargo hook



Bolt



Plain washer



Spring washer



6 mm Rivet nut



Accessory User's Information Manual

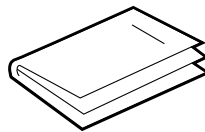

TOOLS AND SUPPLIES REQUIRED

Rivet Nut Tool (P/N 07AAE-000A100)

Hex wrench

19 mm Wrench

Torque wrench

Illustration of the Cargo Hook on the Vehicle

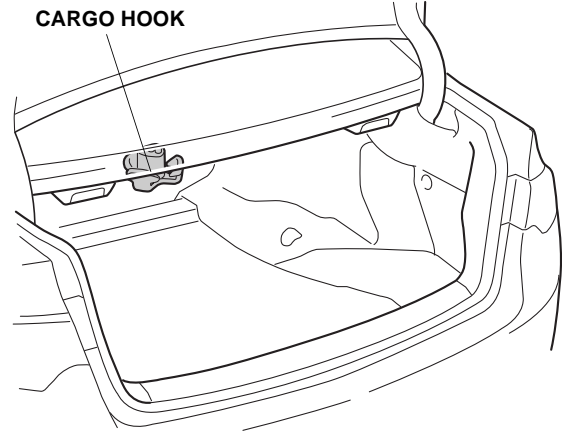

INSTALLATION

NOTE: This instruction shows the cargo hook being installed on the left side of the vehicle. An additional cargo hook (sold separately) can be installed on the right side of the vehicle, unless the vehicle is equipped with a navigation unit or a compass.

1. Thread the 6 mm rivet nut onto the mandrel of the rivet nut tool as shown.

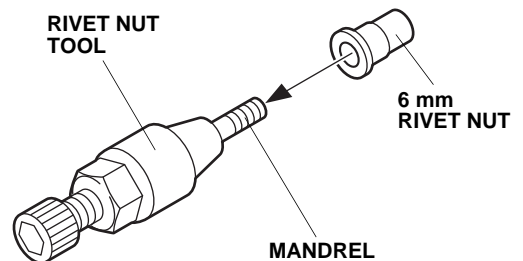

- Open the trunk lid. Insert the 6 mm rivet nut into the hole in the vehicle panel, and attach the hex wrench to the rivet nut tool.

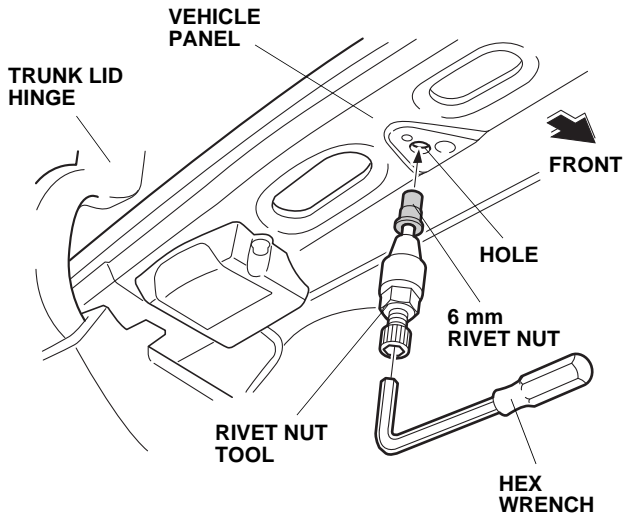

- Hold the rivet nut tool with the hex wrench, and turn the 19 mm wrench clockwise to install the 6 mm rivet nut into the vehicle panel.

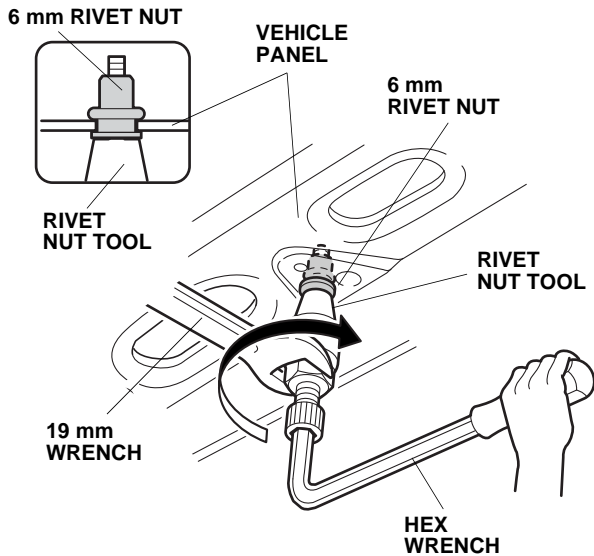

- Remove the rivet nut tool from the 6 mm rivet nut by turning the hex wrench counterclockwise.

- Align the cargo hook pin with the hole in the vehicle panel, and secure the cargo hook to the vehicle panel using the bolt with plain washer and spring washer. Torque the bolt to 4 N·m (3 lb·ft).

