



INSTALLATION INSTRUCTIONS

Accessory

SELECT KNOB
P/N 08U92-TK4-210

Application

2012 ZDX

Publications No.

BII 46589

Issue Date

AUG 2011

PARTS LIST

Select knob



2 Screws



TOOLS AND SUPPLIES REQUIRED

Phillips screwdriver

Torque screwdriver (T/N CDI401SM)
(Available through the American Honda Tool and
Equipment Program: call (888) 424-6857)

Plastic trim tool (T/N SILTRIMTL10)

Illustration of the Select Knob on the Vehicle

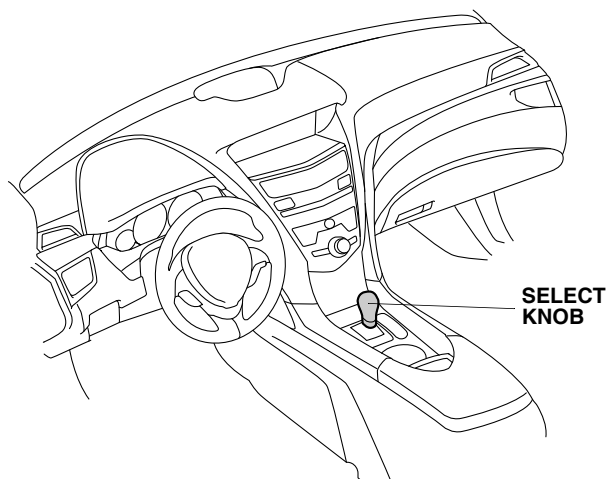

INSTALLATION

Client Information: The information in this installation instruction is intended for use only by skilled technicians who have the proper tools, equipment, and training to correctly and safely add equipment to your vehicle. These procedures should not be attempted by “do-it-yourselfers.”

NOTE:

- Do not damage the vehicle during installation.
- Observe all safety notes and precautions in the service manual in addition to those in this installation instruction.

1. Remove the cover (two retaining tabs).

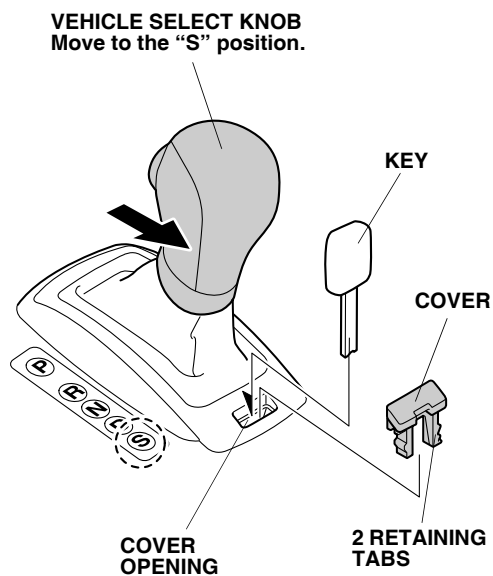

2. Insert a key into the cover opening and move the vehicle select knob to the “S” position.

3. Release the shift boot (two retaining tabs).

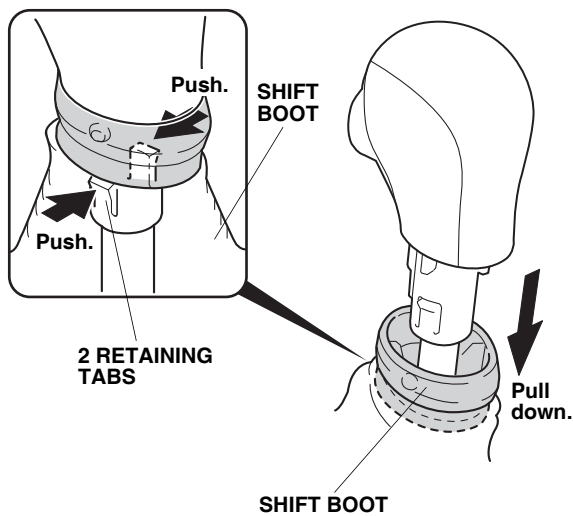

4. Remove the select knob cover (two retaining tabs).

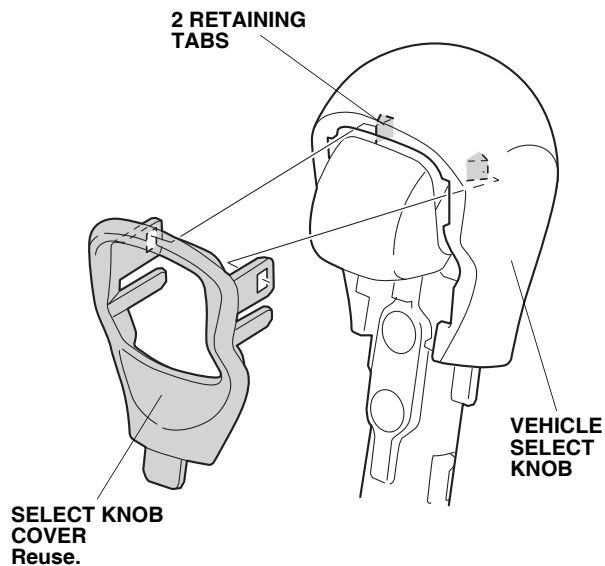

5. Remove the select knob (two screws).

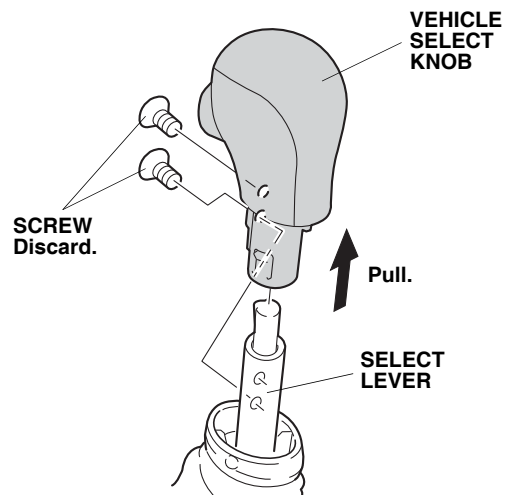

6. Using a torque screwdriver, install the accessory select knob to the select lever with two screws. Torque the screws to 1.6 N·m (14.4 in·lbs). Do not overtighten the screws.

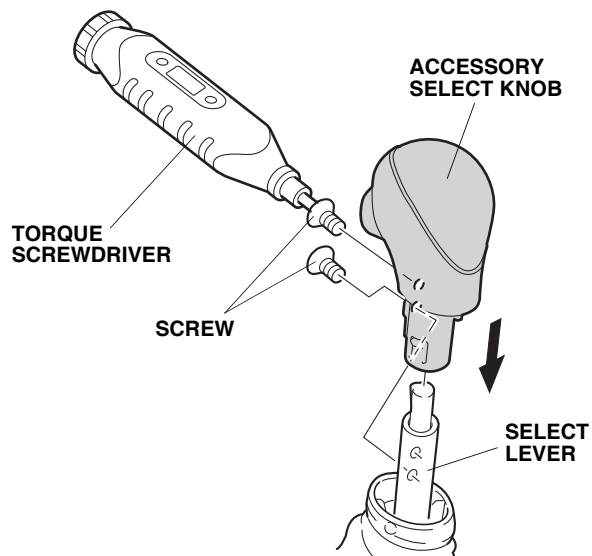

7. Install the select knob cover to the accessory select knob with two retaining tabs.

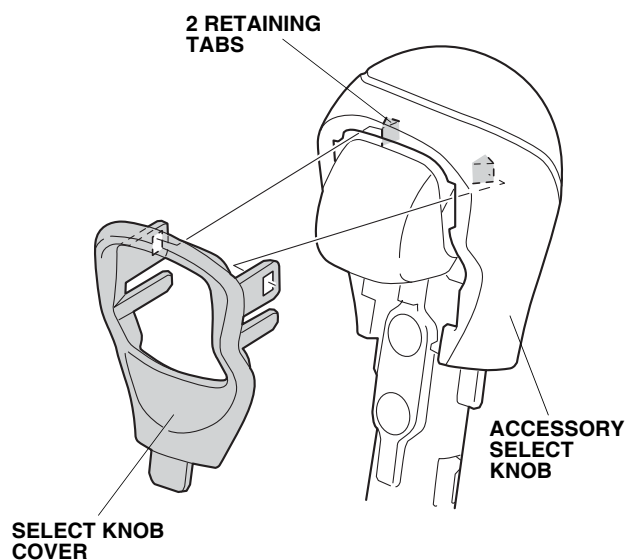

8. Secure the shift boot to the accessory select knob with two retaining tabs.

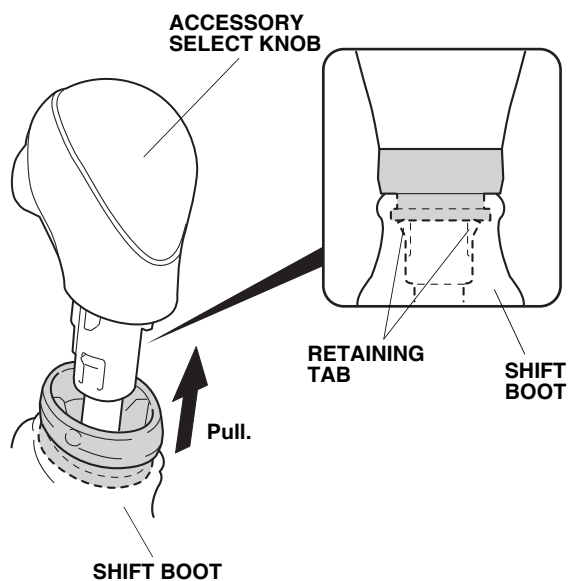

USE AND CARE

- Use a sponge or soft cloth with a solution of mild liquid dishwashing soap and water to clean the select knob.
- Rinse the knob completely with water, then wipe it clean with a shop towel.
- Never use organic solvents such as benzene, thinner, or gasoline to clean the select knob.