



# ACURA INSTALLATION INSTRUCTIONS

Accessory	Application	Publications No.
<b>INTERIOR PANELS</b>	<b>2012 RDX</b>	<b>BII 46136</b>
		Issue Date
		<b>AUG 2011</b>

## PARTS LIST

Front passenger side panel

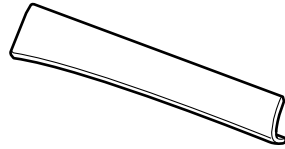

Right driver side panel



Left driver side panel

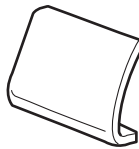

## TOOLS AND SUPPLIES REQUIRED

Isopropyl alcohol

Shop towel

Masking tape

## INSTALLATION

1. Clean the existing front passenger side panel with isopropyl alcohol.
2. Peel back 1-2 inches (2-6 cm) of the adhesive backings and temporarily attach them to the front surface of the front passenger side panel with masking tape. Remove the entire center adhesive backing from the front passenger side panel.

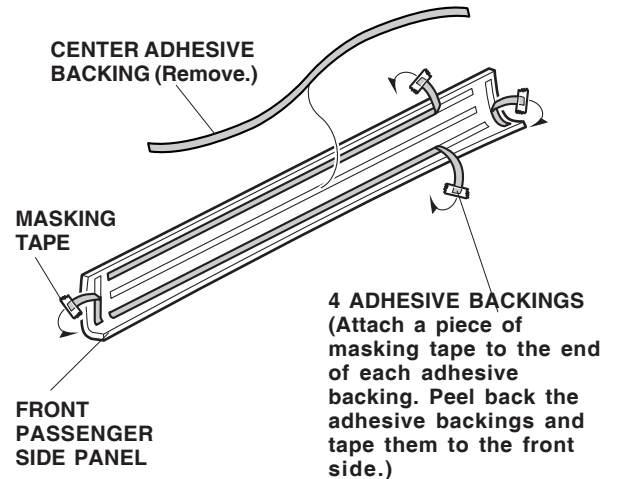

3. Position the front passenger side panel on the existing panel. Gently press on the front passenger side panel with the palm of your hand while removing the adhesive backings.

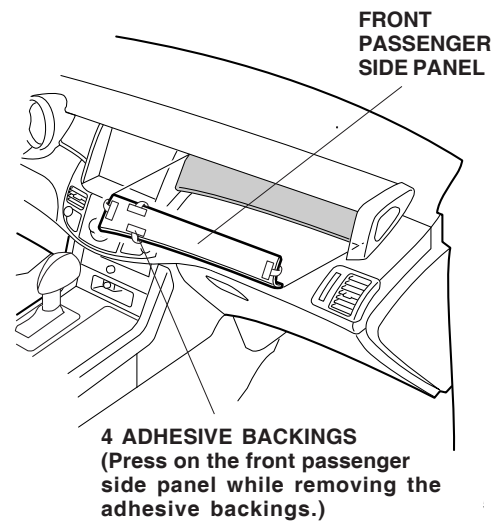

4. Press and hold the side panel for 30 seconds.

- Using isopropyl alcohol on a shop towel, clean the right driver side panel where the new side panel will attach.
- Peel back 1-2 inches (2-6 cm) of the adhesive backings and temporarily attach them to the front surface of the right driver side panel with masking tape.

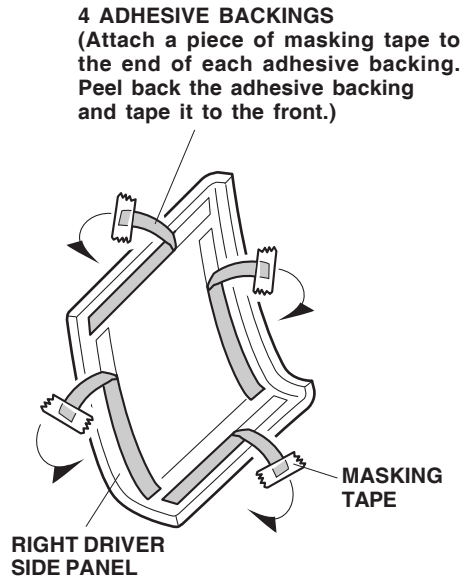

- Position the right driver side panel on the surface. Press on the right driver side panel firmly with the palm of your hand while removing the adhesive backings.

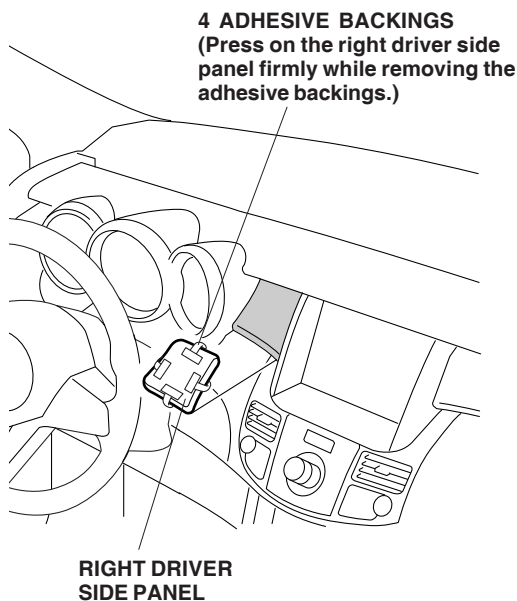

- Using Isopropyl alcohol, clean the area where the left driver side panel will be installed.
- Attach a piece of masking tape to an end of each adhesive backing. Peel back 1-2 inches (2-6 cm) of the adhesive backings and temporarily attach them to the front surface of the left driver side panel with masking tape.

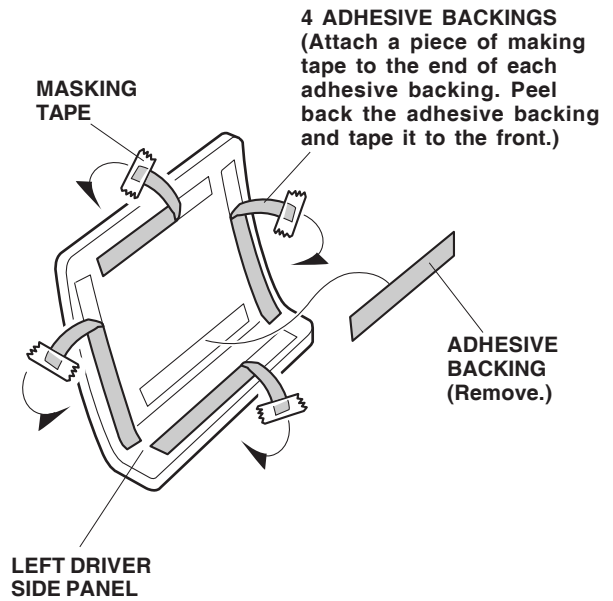

- Position the left driver side panel on the surface. Press on the left driver side panel firmly with the palm of your hand while removing the adhesive backings.

