



INSTALLATION INSTRUCTIONS

Accessory

**FULL NOSE MASK
P/N 08P35-TK4-200**

Application

2011 TL

Publications No.

BII 44594

Issue Date

AUG 2010

PARTS LIST

Bumper mask

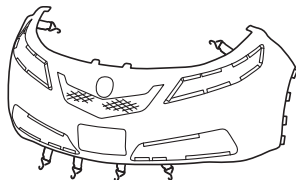

Hood mask

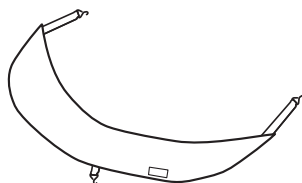

4 Clips

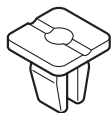

4 Snap-screws

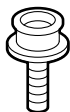

Storage bag

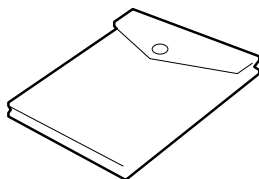

TOOLS AND SUPPLIES REQUIRED

Phillips screwdriver

Flat-tip screwdriver

Scissors

High-quality paste wax

INSTALLATION

NOTE:

- The full nose mask cannot be installed with the front under spoiler.
 - Make sure the vehicle and the nose mask are clean and completely dry before installation. If moisture under the mask is allowed to dry, it may cloud the paint. If the mask gets wet, remove it and allow it to air-dry completely.
 - Make sure any repainted surfaces are cured.
 - Make sure the hood and nose of the vehicle have been waxed with a high-quality paste wax.
 - Make sure you install the nose mask securely. If the nose mask starts to flap or comes loose while driving, safely pull off the highway, stop the vehicle, and secure or remove the mask.
1. If your state law requires the display of both license plates, cut out the piece of the bumper mask that covers the front license plate:
 - Face the inside of the mask toward you.
 - Carefully cut out the license plate section with scissors at the top seam, and remove the overcast stitching.

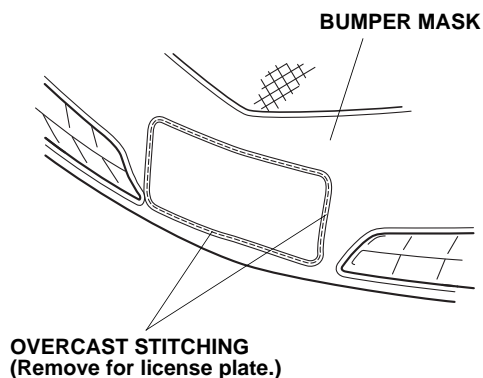

Installing the Hood Section

2. Open the hood.
3. Fit the corners of the mask around the hood, and adjust the hood mask so that it fits smoothly over the edges.

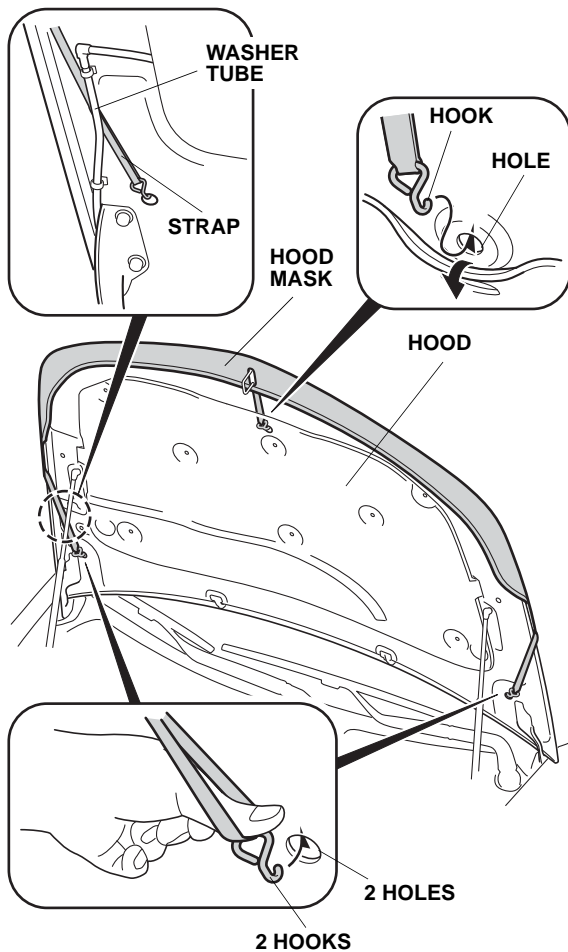

4. Attach the three hooks to the positions shown.

5. Set the deflector as shown.

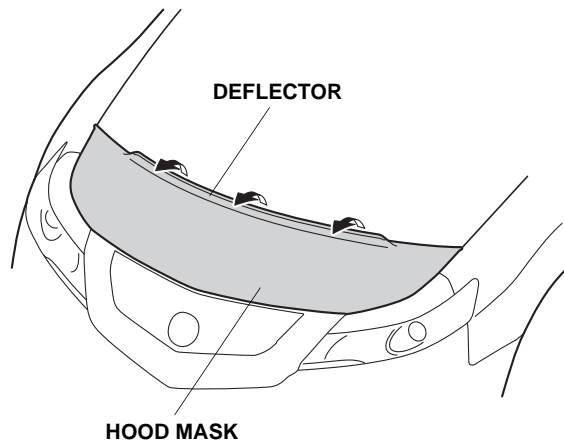

Installing the Bumper Section

6. Remove the upper grille cover (four clips and two hooks).

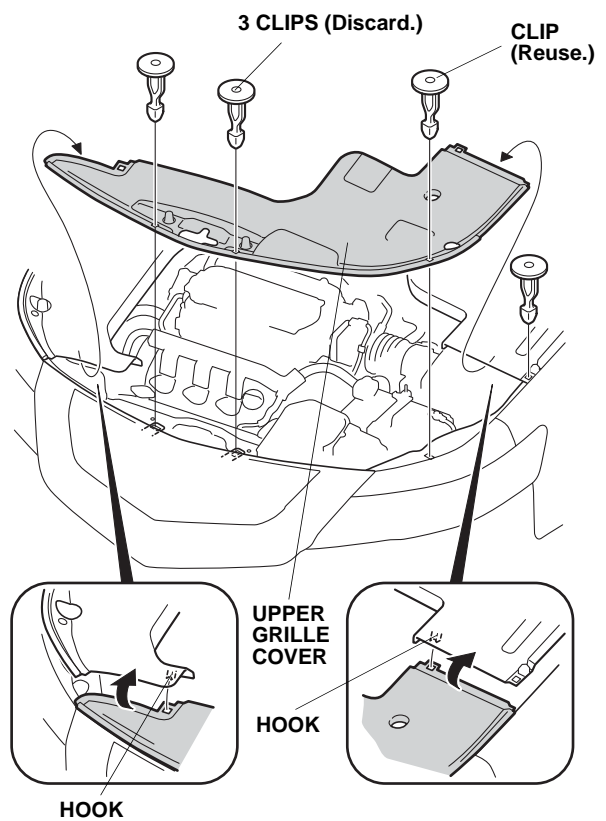

7. Remove the two clips, and raise the right upper fender trim.

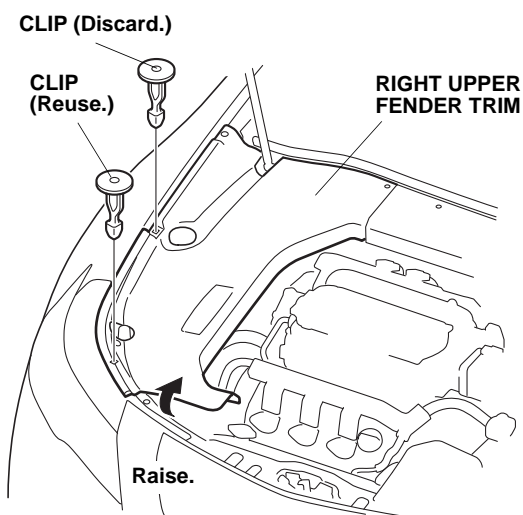

8. Remove and discard four clips.

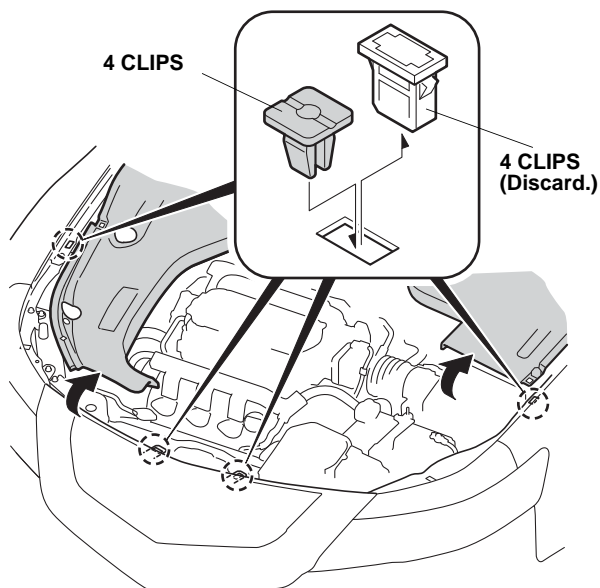

9. Install four new clips from the kit.
10. Reinstall the upper grille cover.

11. Install the four snap-screws and two clips into the holes where you removed the clips.

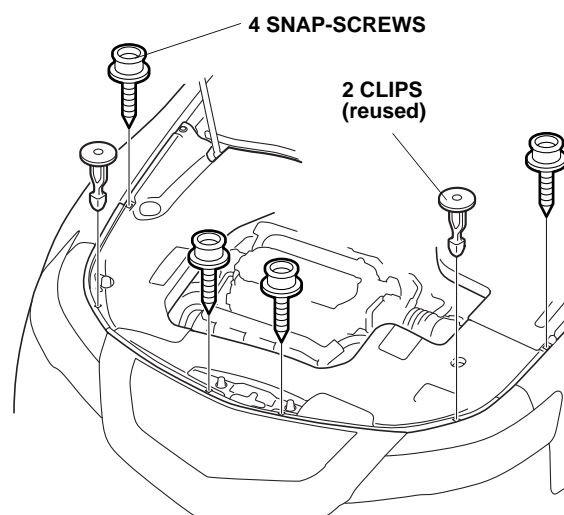

12. On each side, attach the hook to the hole in the fender as shown.

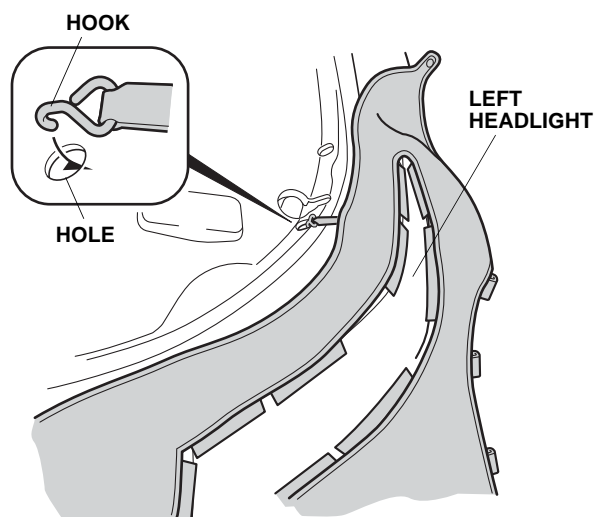

13. Insert the nine tabs around each headlight.

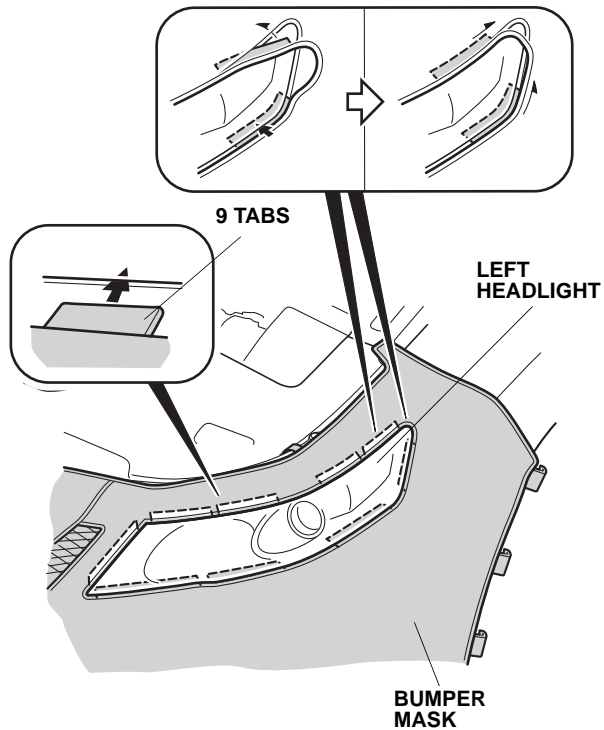

14. Attach the four plastic hooks to the front fender.

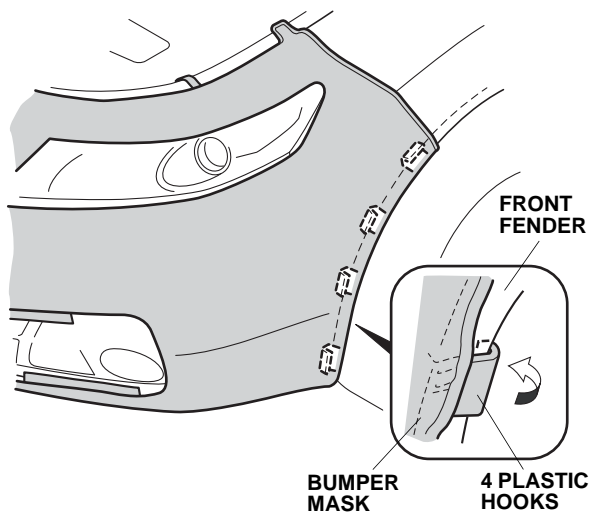

15. Attach the plastic hooks to the other fender the same way.

16. On each side, insert the four tabs around the lower grille.

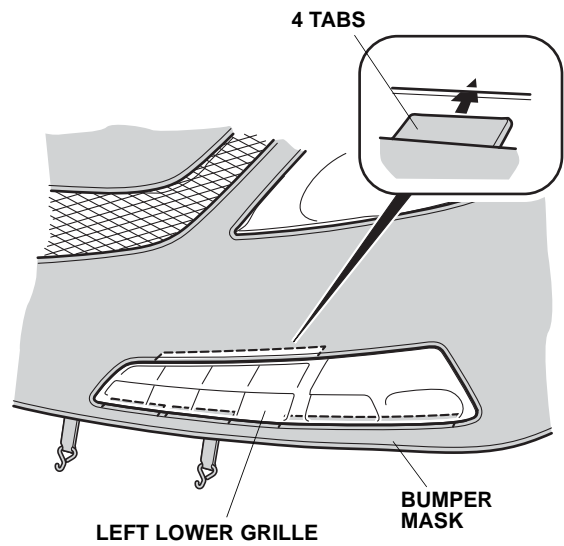

17. Along the top of the nose mask, snap the four snaps to the four snap-screws.

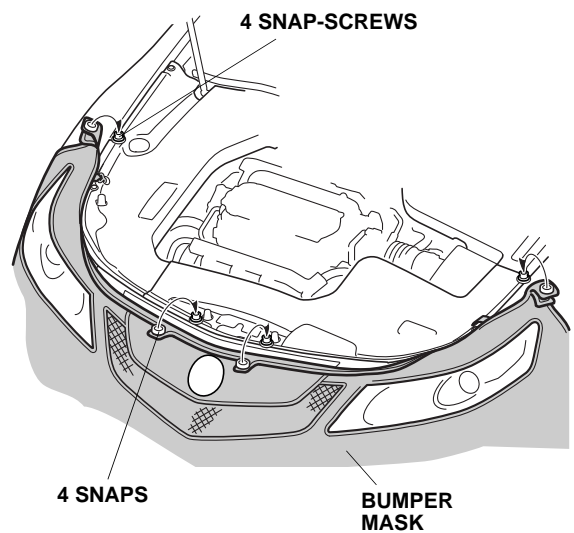

18. Attach the four hooks along the bottom of the mask to the bumper in the areas shown.

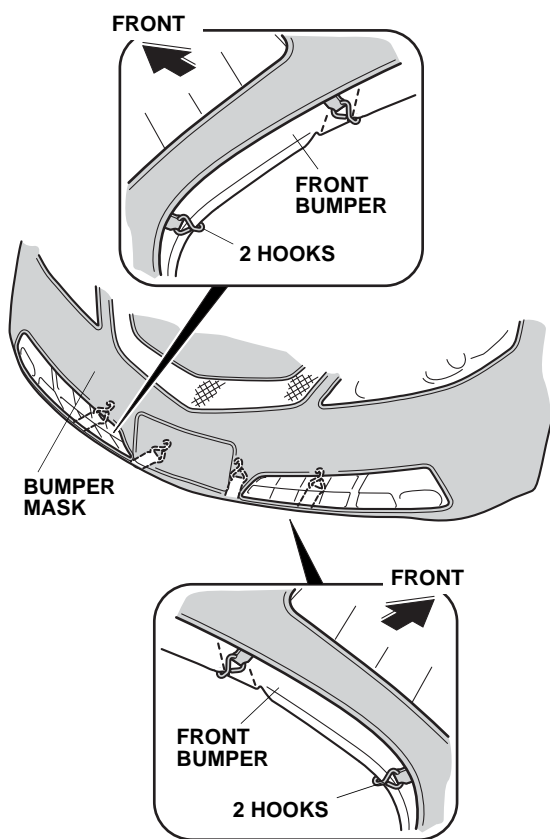

CLEANING THE NOSE MASK

Use a sponge or cloth and a solution of mild liquid dishwashing soap and water to clean the vinyl and the flannel backing. Rinse the mask completely with clean water, and hang it to dry, out of direct sunlight. Make sure the mask is completely dry before you reinstall it.