



ACURA INSTALLATION INSTRUCTIONS

Accessory	Application	Publications No.
INTERIOR PANELS	2011 RDX	BII 43531
		Issue Date
		JULY 2010

PARTS LIST

Front passenger side panel

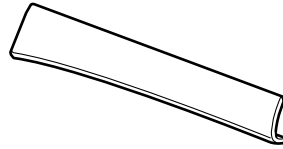

Right driver side panel



Left driver side panel

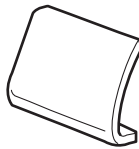

TOOLS AND SUPPLIES REQUIRED

Isopropyl alcohol

Shop towel

Masking tape

INSTALLATION

1. Clean the existing front passenger side panel with isopropyl alcohol.

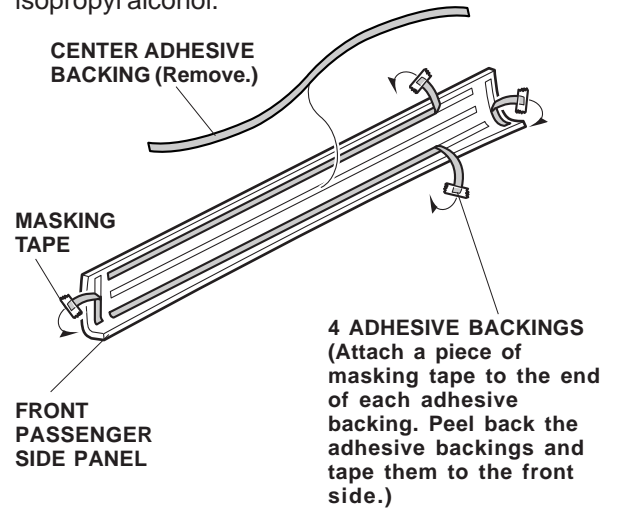

2. Peel back 1-2 inches (2-6 cm) of the adhesive backings and temporarily attach them to the front surface of the front passenger side panel with masking tape. Remove the entire center adhesive backing from the front passenger side panel.
3. Position the front passenger side panel on the existing panel. Gently press on the front passenger side panel with the palm of your hand while removing the adhesive backings.

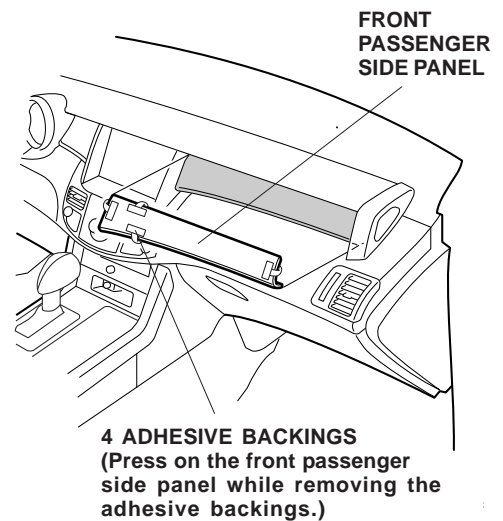

4. Press and hold the side panel for 30 seconds.

- Using isopropyl alcohol on a shop towel, clean the right driver side panel where the new side panel will attach.

4 ADHESIVE BACKINGS
(Attach a piece of masking tape to the end of each adhesive backing. Peel back the adhesive backing and tape it to the other side.)

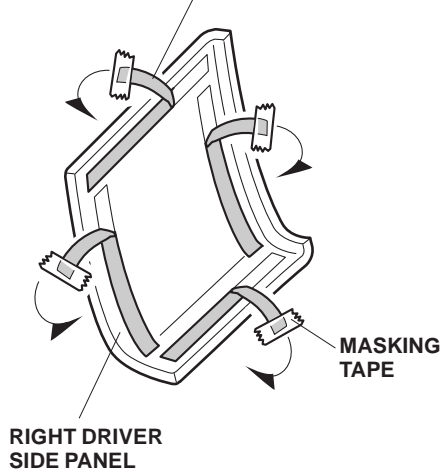

- Peel back 1-2 inches (2-6 cm) of the adhesive backings and temporarily attach them to the front surface of the right driver side panel with masking tape.
- Position the right driver side panel on the surface. Press on the right driver side panel firmly with the palm of your hand while removing the adhesive backings.

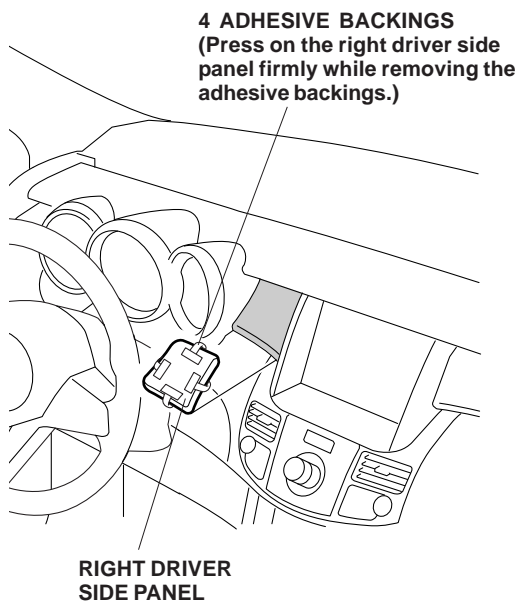

- Using Isopropyl alcohol, clean the area where the left driver side panel will be installed.

4 ADHESIVE BACKINGS
(Attach a piece of making tape to the end of each adhesive backing. Peel back the adhesive backing and tape it to the other side.)

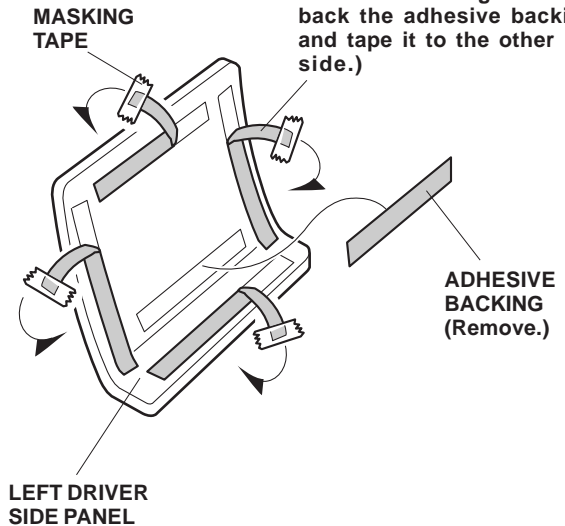

- Attach a piece of masking tape to an end of each adhesive backing. Peel back 1-2 inches (2-6 cm) of the adhesive backings and temporarily attach them to the front surface of the left driver side panel with masking tape.
- Position the left driver side panel on the surface. Press on the left driver side panel firmly with the palm of your hand while removing the adhesive backings.

