



INSTALLATION INSTRUCTIONS

Accessory
DOOR EDGE GUARDS

Application
2011 MDX

Publications No.
BII 43666
Issue Date
AUG 2010

PARTS LIST

Right front door edge guard

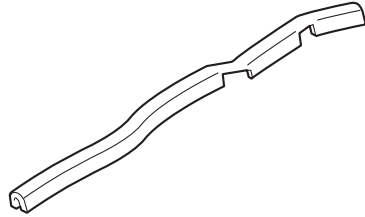

Left front door edge guard

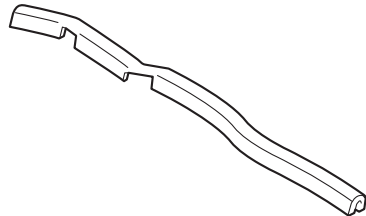

Right rear door edge guard



Left rear door edge guard



Seam sealant cutting tool

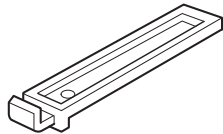

TOOLS AND SUPPLIES REQUIRED

Rubber mallet
Felt-tip pen
Touch-up paint

INSTALLATION

Client Information: The information in this installation instruction is intended for use only by skilled technicians who have the proper tools, equipment, and training to correctly and safely add equipment to your vehicle. These procedures should not be attempted by "do-it-yourselfers."

NOTE: The door edge guards will not fit on vehicles equipped with body side molding.

1. Clean and wax the areas to be covered. Use a high quality paste wax.
2. Identify each door edge guard by holding it up to the door and matching its contour with the door edge.
3. Using the bends for reference, position each door edge guard against the inside edge of the front door. Mark the sealant at the top and bottom ending points of each door edge guard.

Front Door:

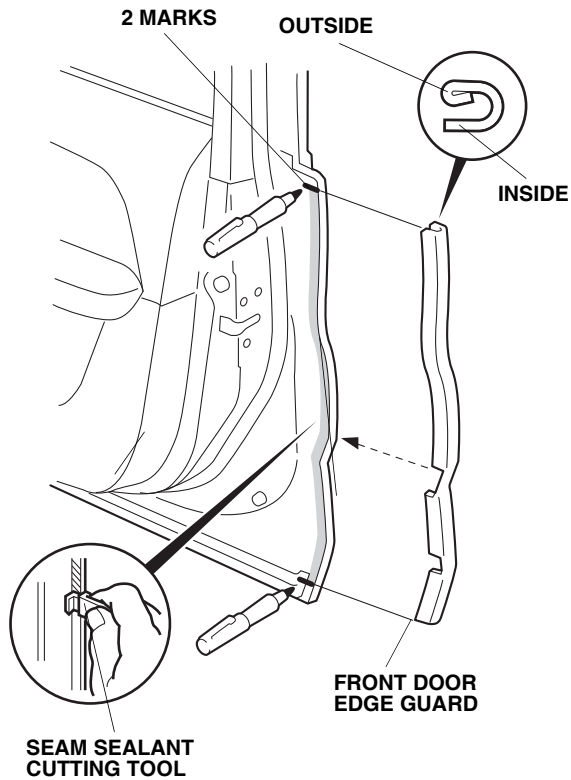

Rear Door:

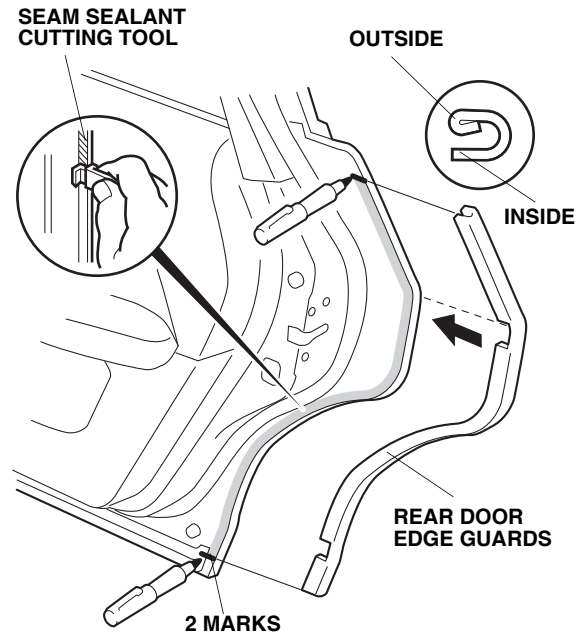

4. Position the cutting edge of the seam sealant cutting tool against the door edge and trim the seam sealant from mark to mark
NOTE: The cutting tool cuts in only one direction. Move it upward on the right side of the vehicle and downward on the left side.
5. Apply touch-up paint to the door, and let it dry.

6. Position the door edge guard on the door edge using the bends for reference. Starting at the feature line, use a rubber mallet to tap the door edge guard into position with a series of light taps.

NOTE: Be sure to use a series of light taps. Once in place, do not remove, reposition, or reinstall the door edge guard. It will not hold securely.

Front Door:

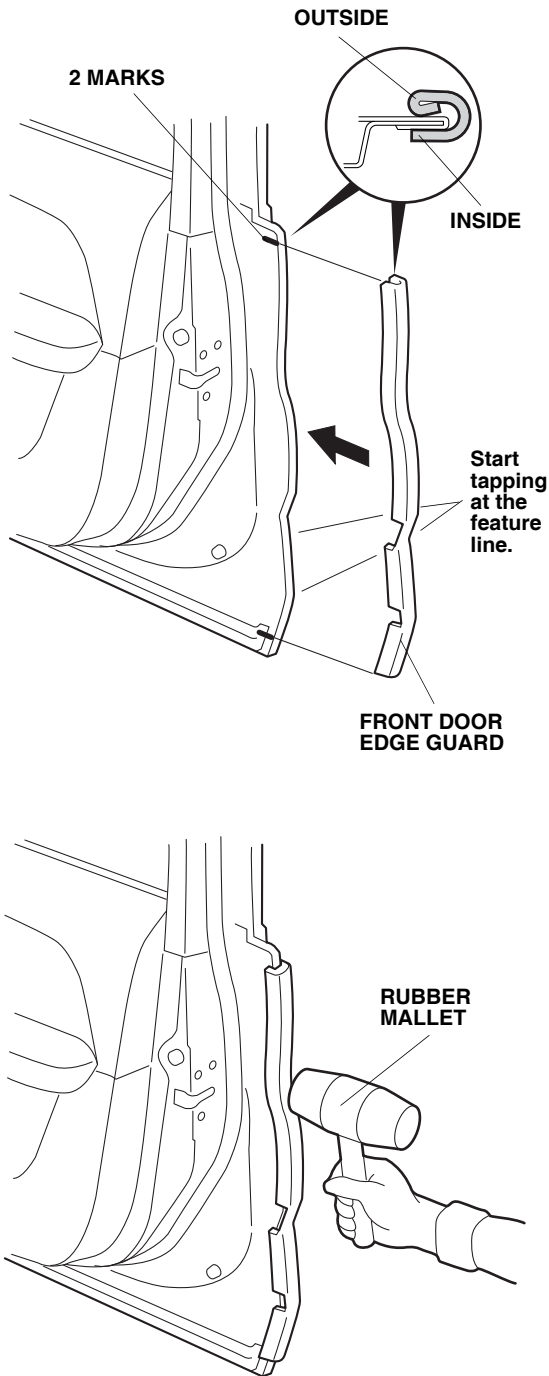

Rear Door:

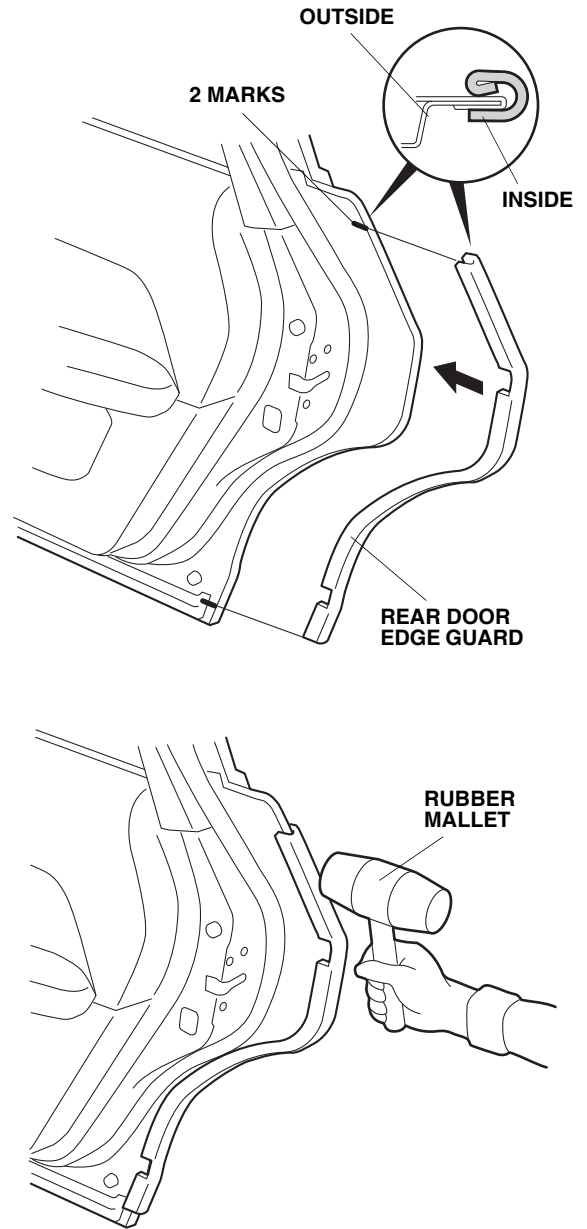

7. Repeat steps 1 through 6 to install the door edge guards on the other side of the vehicle.