



INSTALLATION INSTRUCTIONS

Accessory
CARGO LINERS
P/N 08P42-SZN-200

Application
2010 ZDX

Publications No.
BII 42759
Issue Date
DEC 2009

PARTS LIST

Left front cargo liner

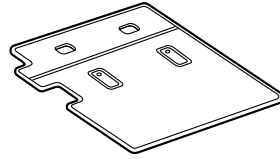

Right front cargo liner

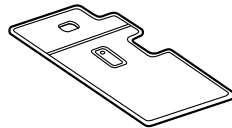

Rear cargo liner

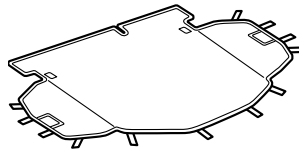

Bag

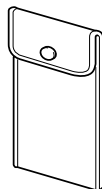
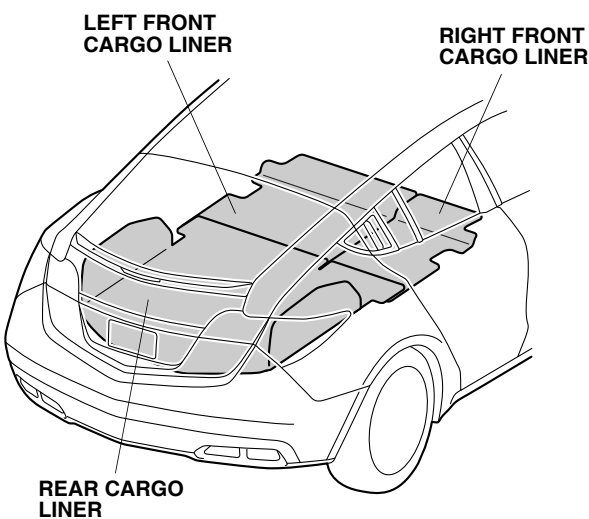

Illustration of the Cargo Liners Installed in the Vehicle



INSTALLATION

Client Information: The information in this installation instruction is intended for use only by skilled technicians who have the proper tools, equipment, and training to correctly and safely add equipment to your vehicle. These procedures should not be attempted by “do-it-yourselfers.”

NOTE: Be careful not damage the interior panels during installation.

1. Fold the rear seats as described in the vehicle owner’s manual.

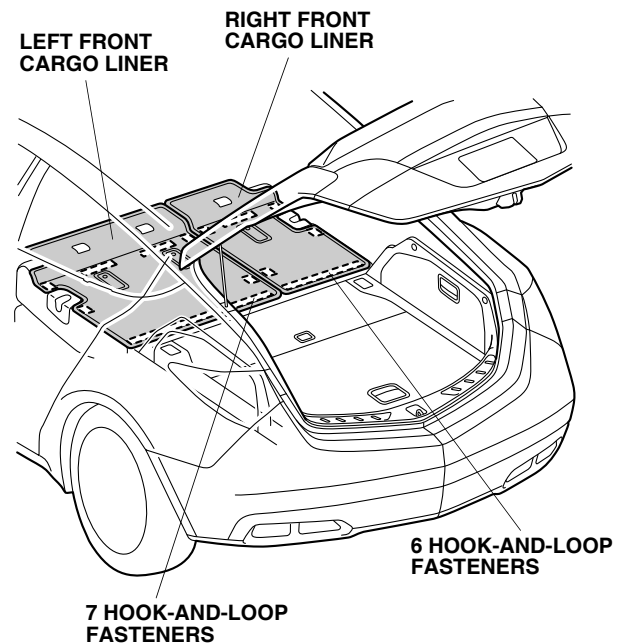

2. Install the left front cargo liner and right front cargo liner to the rear seats with thirteen hook-and-loop fasteners.

- Secure the rear cargo liner to the rear seat flap with two hook-and-loop fasteners.

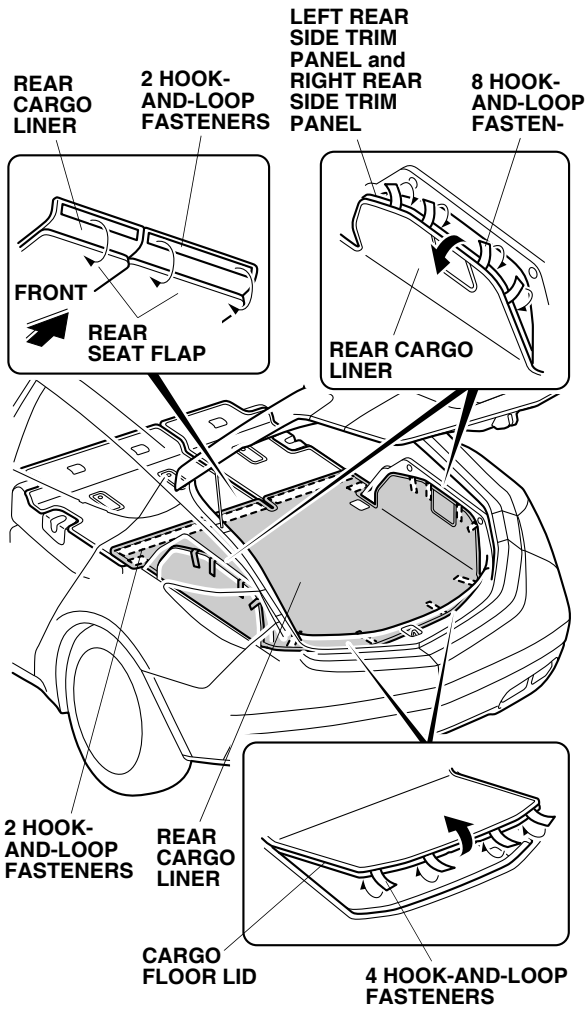

- Secure the rear cargo liner to the left and right rear side trim panels with eight hook-and-loop fasteners.
- Secure the cargo liner to the cargo floor lid with four hook-and-loop fasteners.
- Secure the cargo liner to the cargo floor with two hook-and-loop fasteners.

USE AND CARE

If the cargo liner is not in use, store the cargo liner in the bag for safe-keeping.