



INSTALLATION INSTRUCTIONS

Accessory
SPLASH GUARDS

Application
2010 TSX

Publications No.
BII 41550
Issue Date
MAY 2009

PARTS LIST

Left front splash guard

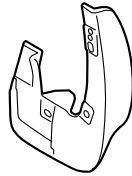

Right front splash guard

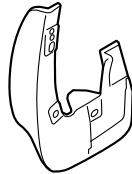

12 Self-tapping screws

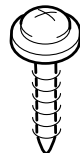

Left rear splash guard



Right rear splash guard



TOOLS AND SUPPLIES REQUIRED

Stubby Phillips screwdriver

Pushpin

Illustration of the Splash Guards Installed on the Vehicle

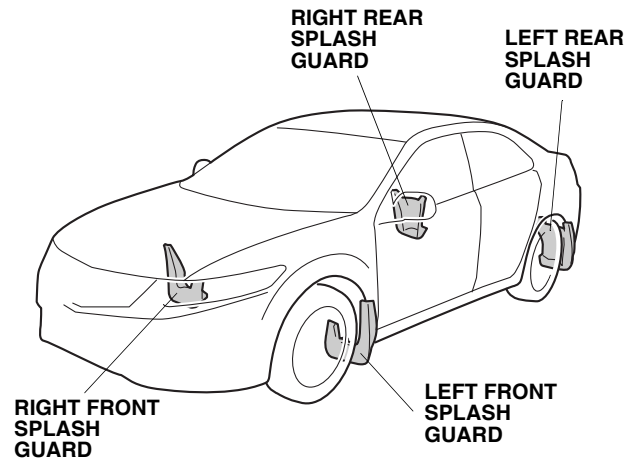

INSTALLATION

NOTE:

1. These instructions show the left splash guards being installed. The same procedure applies to installing the right splash guards.
2. Clean and wax the areas to be covered with a high-quality paste wax.

Installing the Front Splash Guard

- Turn the steering wheel fully counterclockwise.
- Using a pushpin, pierce the center of the three vehicle clips in the left front inner fenderwell.

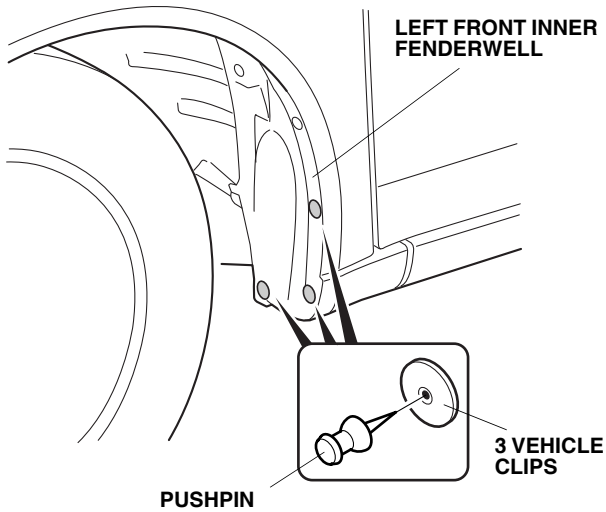

- Secure the left front splash guard with three self-tapping screws, in the order shown below. If there is a gap between the left front splash guard and the vehicle, loosen the three self-tapping screws, and retighten them while pushing in on the splash guard.
- Repeat steps 3 thru 5 to install the left front splash guard.

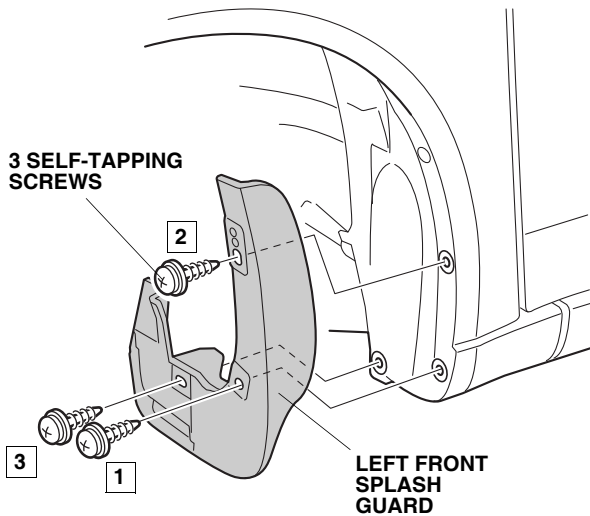

Installing the Rear Splash Guard

- Remove the three self-tapping screws from the left rear inner fenderwell.

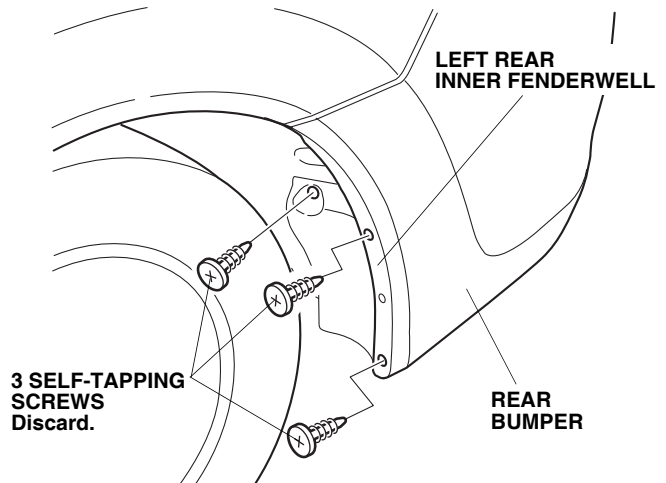

- Secure the left rear splash guard with three new self-tapping screws, in the order shown below. If there is a gap between the left rear splash guard and the vehicle, loosen the three self-tapping screws and retighten them while pushing in on the splash guard.
- Repeat steps 7 and 8 to install the left rear splash guard.

