



INSTALLATION INSTRUCTIONS

Accessory

LUGGAGE NET
P/N 08L96-TL2-200

Application

2010 TSX

Publications No.

BII 41542

Issue Date

MAY 2009

PARTS LIST

Luggage net

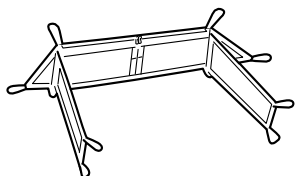

4 "T" anchors



6 Snap hooks

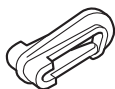

2 D-Rings

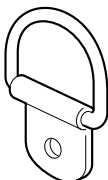

2 Nuts



6 Spring washers



2 Rivet nuts



2 6 x 20 mm Hex bolts



2 6 x 16 mm Hex bolts



2 Plain washers



2 6 x 20 mm Flange bolts



Accessory User's Information Manual

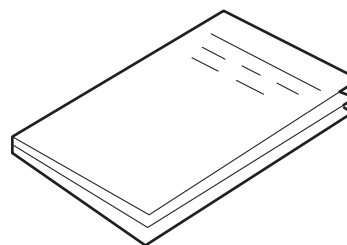

TOOLS AND SUPPLIES REQUIRED

Pushpin
Drill
3 mm, 6.5 mm, and 9 mm Drill bits
10 mm wrench
Ratchet
10 mm Socket
19 mm Wrench
Rivet Nut Tool (P/N 07AAE-000A100)
Hex wrench
Touch-up paint
File
Plastic Trim Tool (T/N SILTRIMTL10)
Masking tape
Eye protection (face shield, safety goggles, etc.)

Illustration of the Luggage Net Installed on the Vehicle

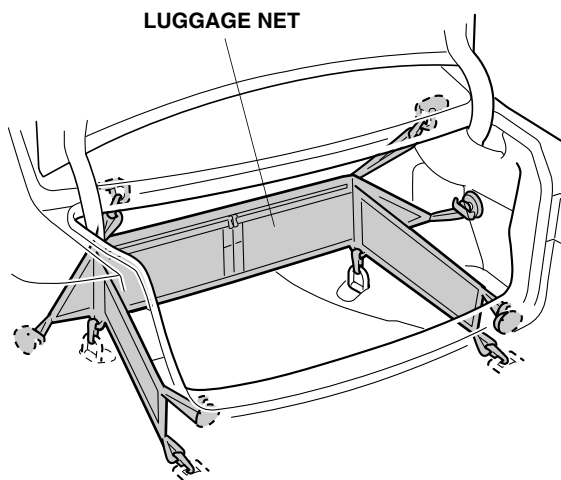

INSTALLATION

Client Information: The information in this installation instruction is intended for use only by skilled technicians who have the proper tools, equipment, and training to correctly and safely add equipment to your vehicle. These procedures should not be attempted by "do-it-yourselfers."

NOTE: Be careful not to damage the body.

1. Open the trunk, and remove the spare tire lid (two clips).

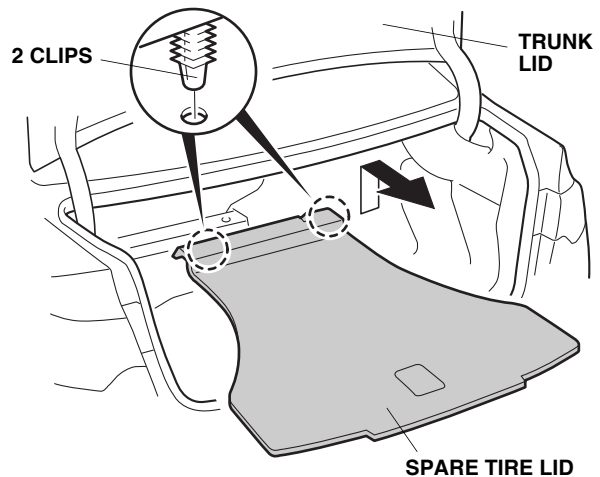

2. Pull away the weatherstrip and remove the trunk rear trim panel (five clips and two hooks).

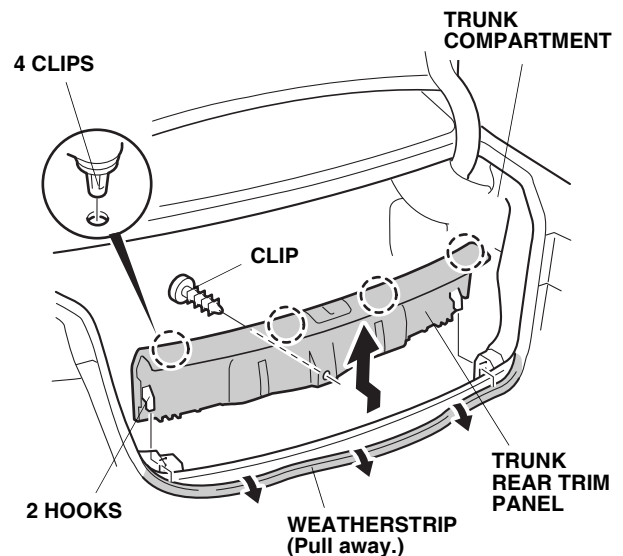

3. Pull the left and right rear seatback lock openers to tilt the left and right rear seatback forward.

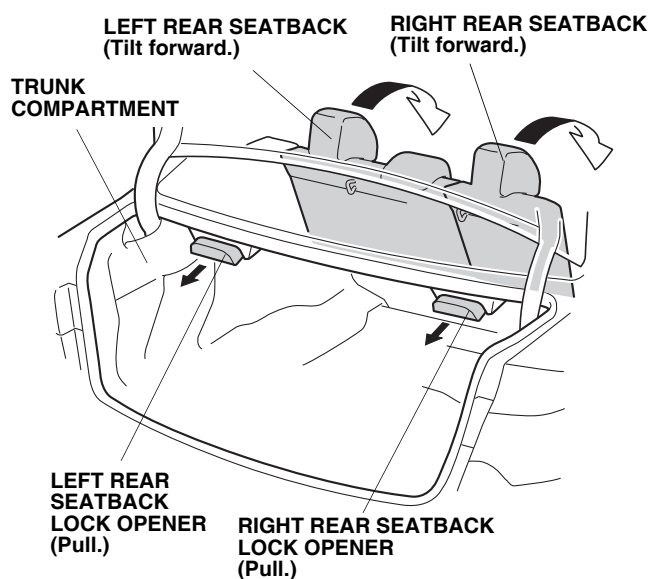

4. Remove the weatherstrip and remove the right trunk side trim panel (five clips and two anchors).

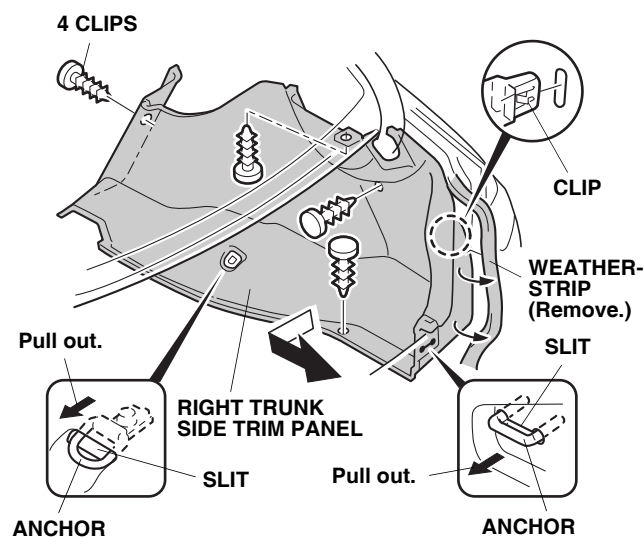

5. On the inside of the right trunk side trim panel, locate the preset mark in the location shown. Using a pushpin, pierce the center of the preset mark.

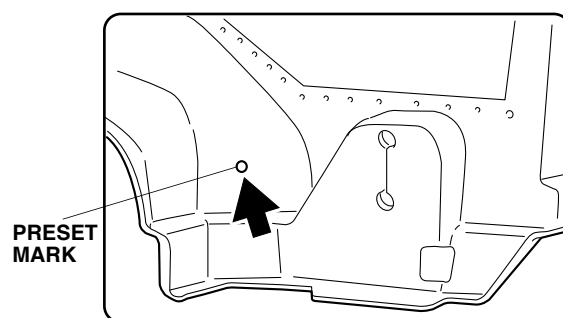
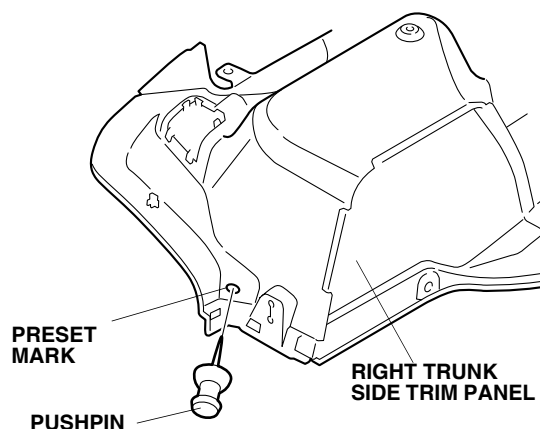

6. While wearing eye protection, drill the pierced mark to 6.5 mm. First drill with a 3 mm drill bit and finish with a 6.5 mm drill bit.

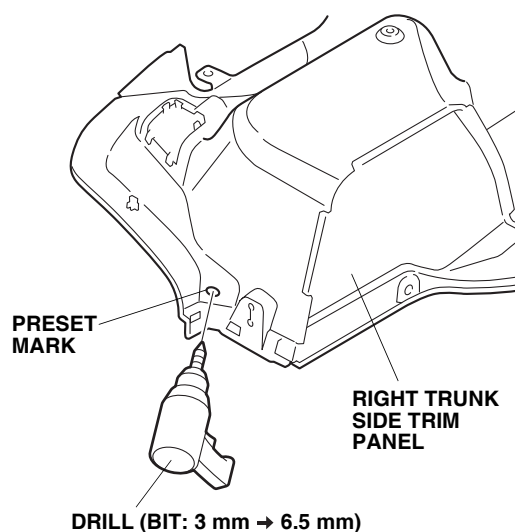

7. Install one 6 x 16 mm hex bolt, spring washer, plain washer, and T-anchor through the hole you just made. Tighten securely.

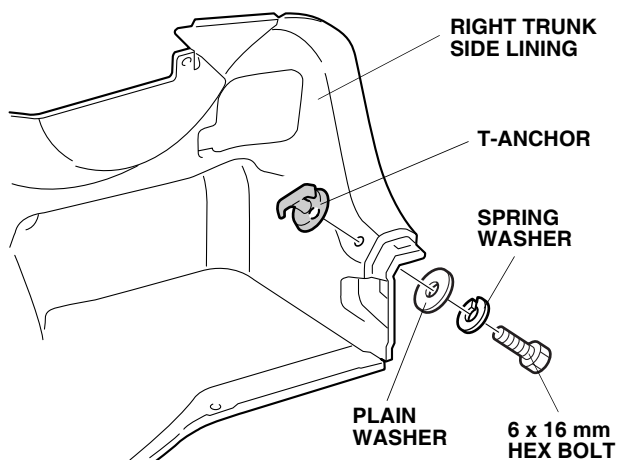

8. Loosen the bolts for the stereo amplifier, then set the amplifier to the side.

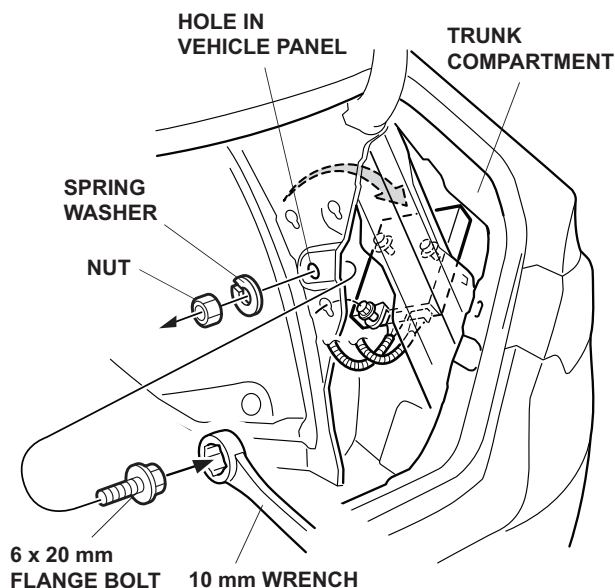

9. Locate the hole in the vehicle panel. Install one 6 x 20 mm flange bolt through the vehicle panel hole, then install a spring washer. Reinstall the stereo amplifier and a nut, and tighten. Be careful not to drop the bolt.

10. In the rear metal shelf, locate the hole near the trunk hinge arm.

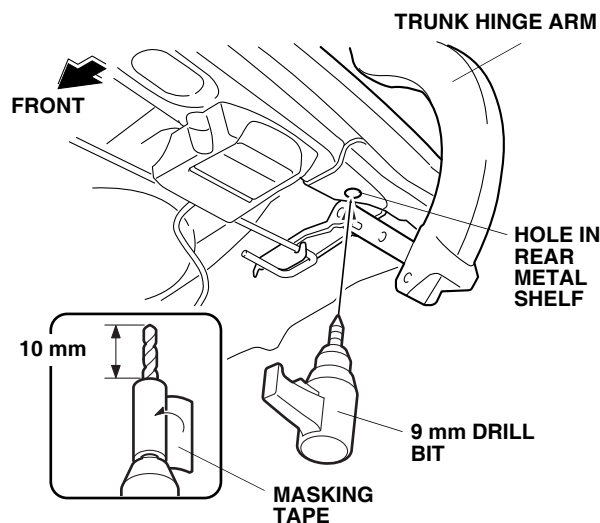

11. While wearing eye protection, enlarge the hole to 9 mm:
 - Wrap tape around the drill bit 10 mm away from the tip.
 - To prevent metal shavings from falling into the trunk area, cover the trunk area with a blanket.
 - Remove all burrs from the edges of the hole, and apply touch-up paint to the edges of the hole. Allow the touch-up paint to dry before installing the rivet nut.
12. Install one rivet nut into the enlarged hole:
 - Thread one rivet nut onto the mandrel of the rivet nut tool.

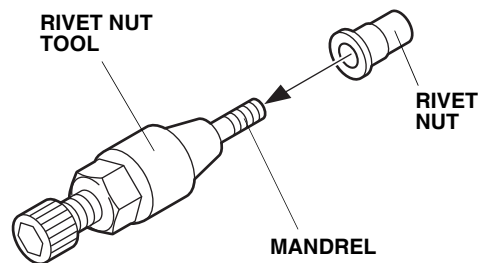

- Insert the rivet nut into the hole you just drilled, and install the hex wrench to the rivet nut tool.

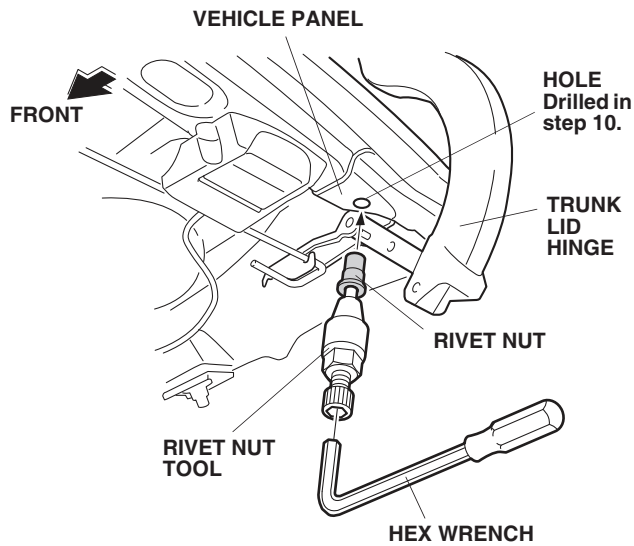

- While holding the tool with the hex wrench, use a 19 mm wrench to turn the tool in a counterclockwise direction until the rivet nut is fully collapsed.

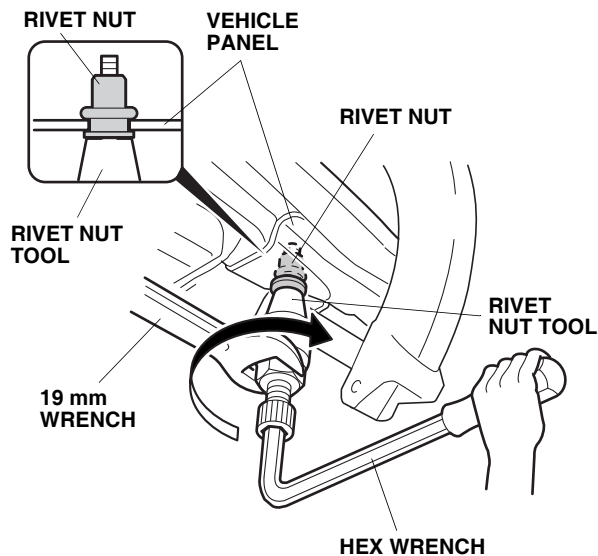

- Remove the tool from the rivet nut by turning the hex wrench clockwise.

- Reinstall the right trunk side trim panel, and install an anchor to the 6 x 20 mm flange bolt. Turn the T-anchor in the direction shown.

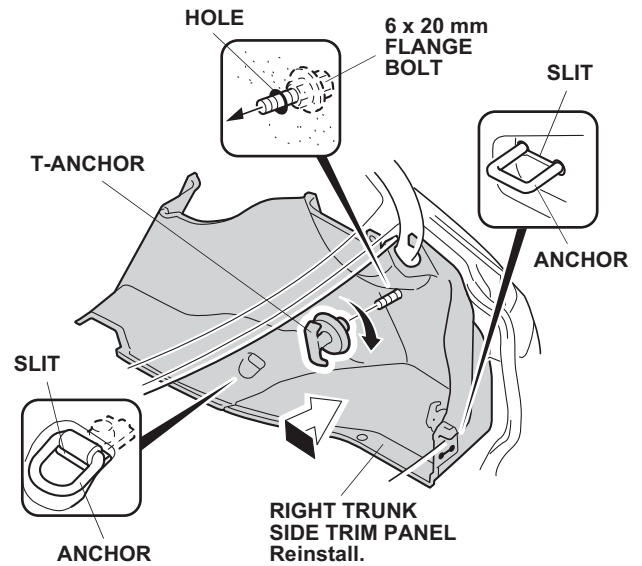

- Install a D-the ring to the rivet nut in the rear metal shelf using one 6 x 16 mm hex bolt with a spring washer. Torque the hex bolt to 5 N·m (3.7 lb·ft).

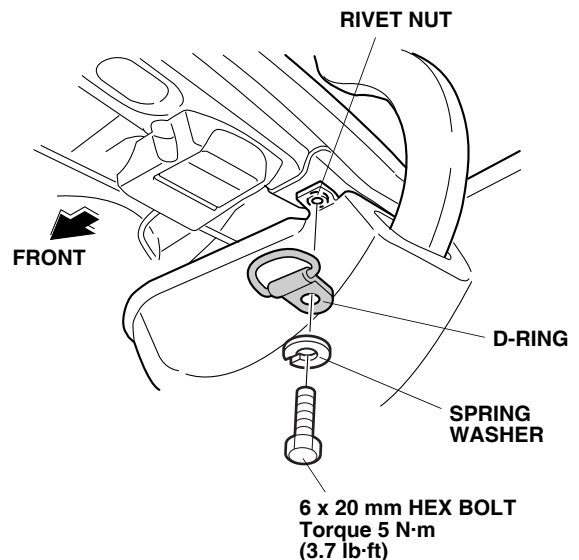

- Remove the left trunk side trim panel, and repeat steps 5 through 13 to install a T-anchor and a D-ring on the left side of the vehicle.

16. Unfold the luggage net and install the six snap hooks to each of the six loops shown.

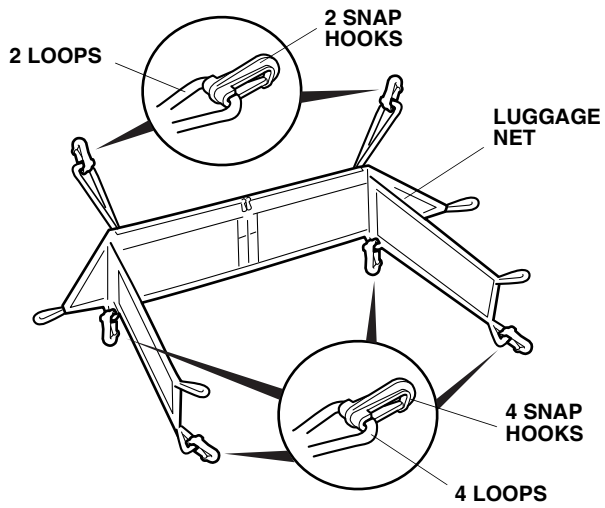

17. Reinstall all removed parts.
18. Secure the six snap hooks and four loops of the luggage net as shown.

