



INSTALLATION INSTRUCTIONS

Accessory
SPLASH GUARDS
P/N 08P00-TL2-200

Application
2009 TSX

Publications No.
BII 39066
Issue Date
APRIL 2008

PARTS LIST

Left front splash guard



Right front splash guard

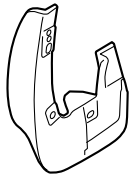

12 Self-tapping screws

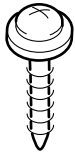

Left rear splash guard



Right rear splash guard

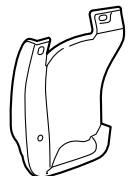

TOOLS AND SUPPLIES REQUIRED

Stubby Phillips screwdriver

Pushpin

Illustration of the Splash Guards Installed on the Vehicle

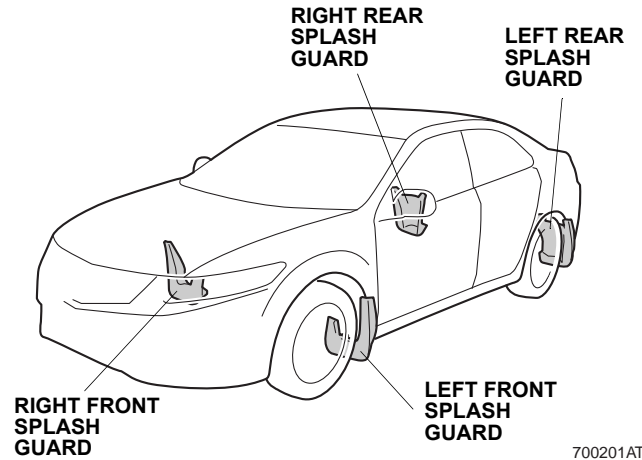

INSTALLATION

NOTE:

1. These instructions show the left splash guards being installed. The same procedure applies to installing the right splash guards.
2. Clean and wax the areas to be covered with a high quality paste wax.

Installing the Front Splash Guard

3. Turn the steering wheel fully counterclockwise.
4. Using a pushpin, pierce the center of the three vehicle clips in the left front inner fenderwell.

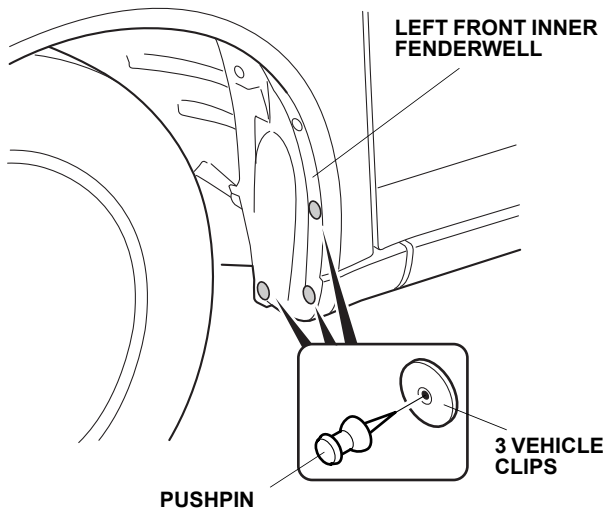

771201AT

5. Install the left front splash guard using three self tapping screws. Do not tighten the self-tapping screws yet.

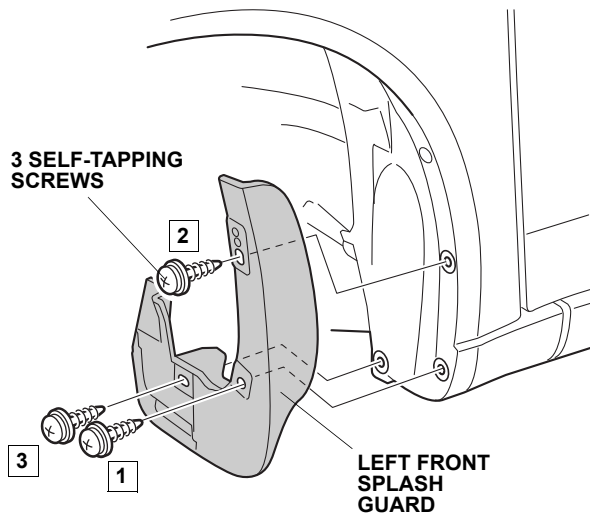

771202AT

6. While holding the left front splash guard against the left front inner fender, tighten the 5 x 25 mm self tapping screws in the order shown
7. Turn the steering wheel all the way clockwise, and repeat steps 2 through 6 to install the right front splash guard.

Installing the Rear Splash Guard

8. Remove the three self-tapping screws from the left rear inner fenderwell.

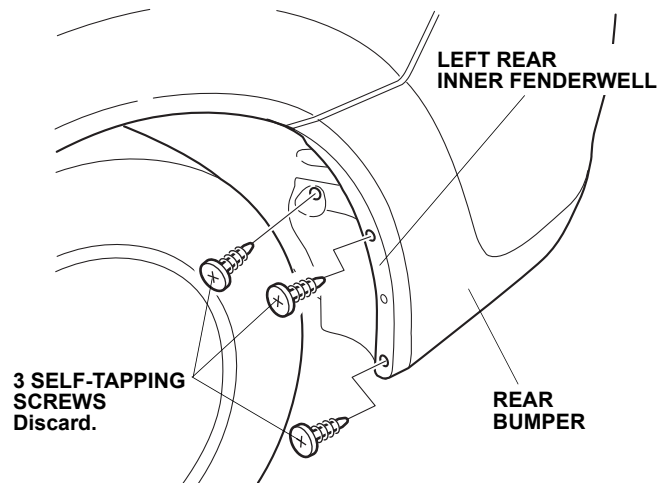

771301AT

9. Secure the left rear splash guard with three new self tapping screws. Do not tighten the self-tapping screws yet

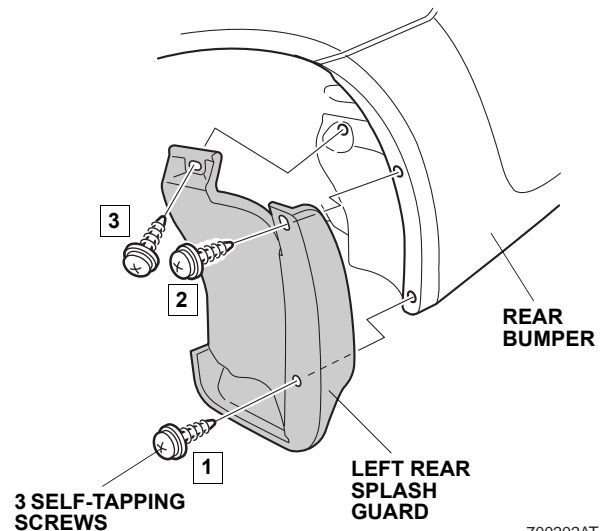

700202AT

10. While holding the left rear splash guard against the left rear bumper, tighten the self-tapping screws in the order shown.
11. Repeat steps 7 through 10 to install the right rear splash guard.