



# INSTALLATION INSTRUCTIONS

Accessory  
**BACKUP SENSOR**

Application  
**2008 RL**

Publications No.  
**BII 36407**  
Issue Date  
**MAY 2007**

## PARTS LIST

### Backup Sensor Attachment Kit P/N 08V67-SJA-200A

Control unit

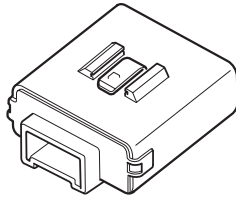

Beeper

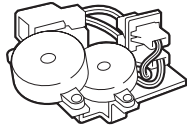

Backup sensor harness

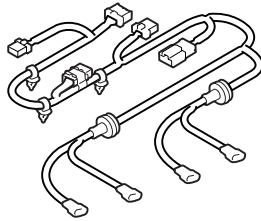

Control unit bracket

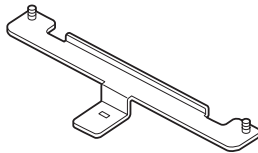

Short bracket

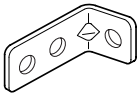

3 Flange nuts



Washer bolt



Flange bolt

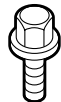

8 Wire ties

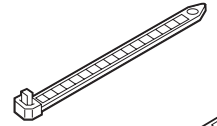

2 Long wire ties

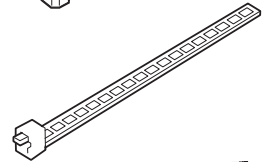

4 Wire ties with clip

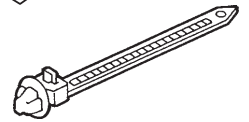

Spring nut



Accessory owner's information manual

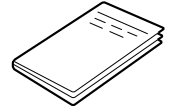

Fuse label

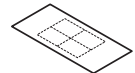

EPT sealer

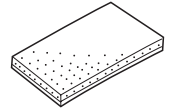

### Back-up Sensor Kit

P/N 08V67-SHJ-1XX

P/N 08V67-S3V-2XX

**NOTE: Refer to Parts Information Bulletin (PIB) B06-0008 for the proper color sensors.**

2 Center sensors

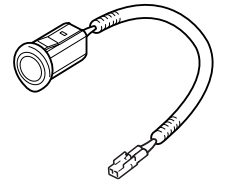

2 Corner sensors

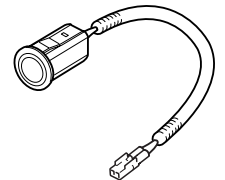

2 Spacers

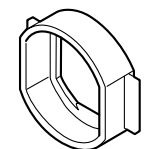

## TOOLS AND SUPPLIES REQUIRED

Phillips screwdriver  
Flat-tip screwdriver  
Ratchet  
8 mm and 10 mm Sockets  
Torque wrench  
Pushpin  
Drill  
3 mm Drill bit  
22 mm and 26 mm Hole saws  
Masking tape  
Tape measure (metric)  
Eye protection (safety goggles, face shield, etc.)  
10 mm Combination wrench  
Blanket  
File  
Diagonal cutters

## Illustration of the Backup Sensor Installed on the Vehicle

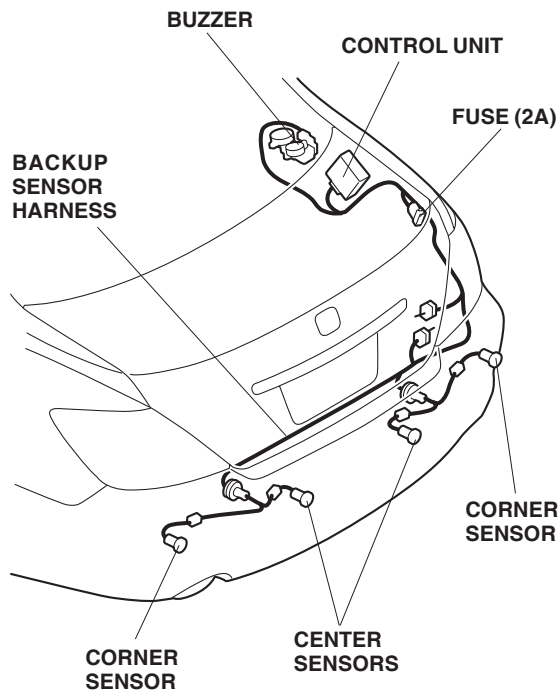

## INSTALLATION

**Client Information:** The information in this installation instruction is intended for use only by skilled technicians who have the proper tools, equipment, and training to correctly and safely add equipment to your vehicle. These procedures should not be attempted by “do-it-yourselfers.”

1. Make sure you have the anti-theft codes for the radio and navigation system, then write down the radio station presets.
2. Disconnect the negative cable from the battery.

### Installing the Sensors in the Bumper

3. Remove the two self-tapping screws and the four clips that secure the rear bumper. Remove the rear bumper. Set the bumper on a blanket.

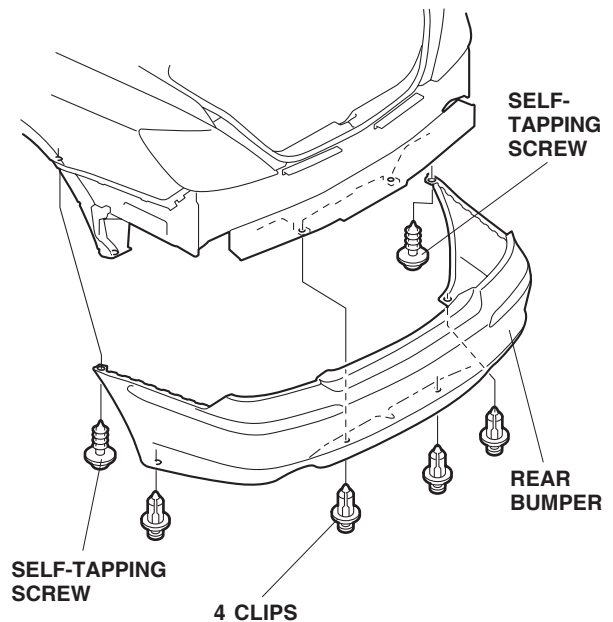

4. On the inside of the rear bumper, locate the four cross marks (without the circles). Using a pushpin, pierce through the rear bumper at each of the four marks.

NOTE: There are several markings on the inside of the rear bumper, make certain that you locate the proper cross marks.

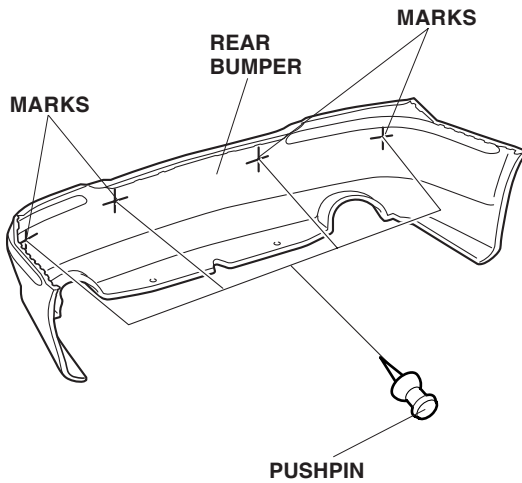

5. While wearing eye protection, drill a 3 mm hole through each of the four marks on the rear bumper.

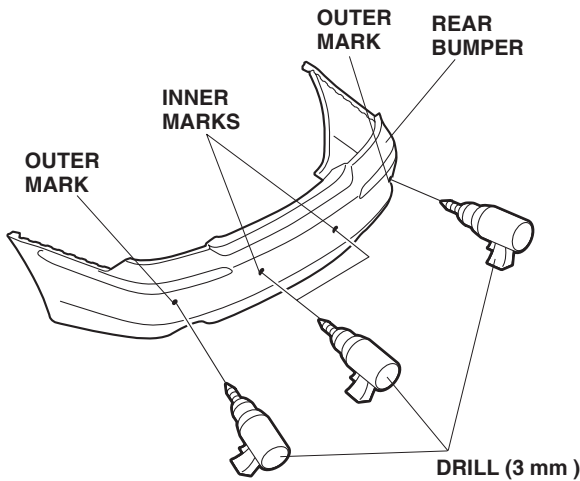

6. While wearing eye protection, drill a 22 mm hole through each of the two outer marks, and a 26 mm hole through each of the two inner marks. Remove any burrs from the edges of the holes.

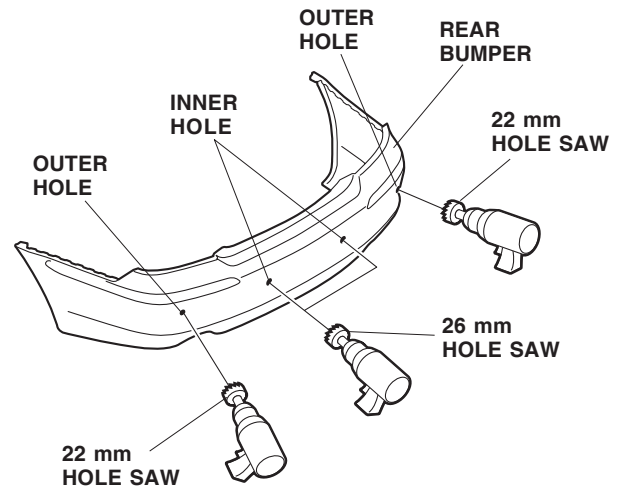

- Slide the two corner sensors into the two 22 mm holes with the harness towards the bottom. Do not push on the center of the sensors; that may cause damage.

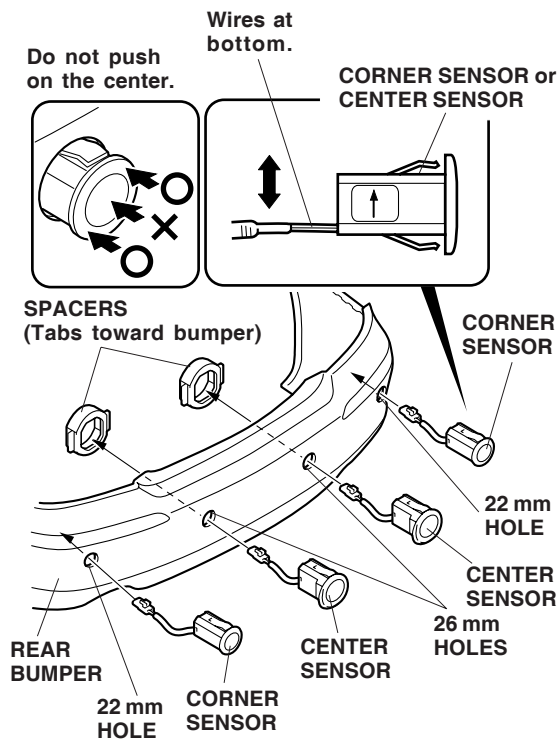

- Slide the two center sensors into the 26 mm holes with the harness towards the bottom. Secure the two center sensors with a spacer behind the bumper. Do not push on the center of the sensor; that may cause damage.

### Routing the Backup Sensor Harness

- Open the trunk lid, and remove the spare tire lid.

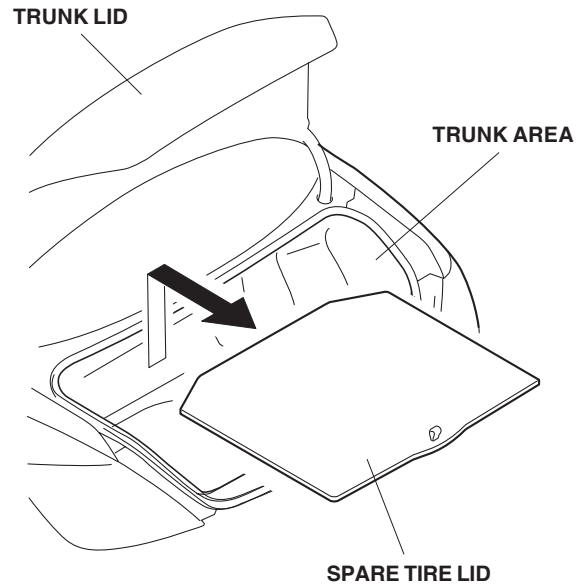

- Remove the weatherstrip as needed, and remove the rear trim panel (four clips and two retaining tabs).

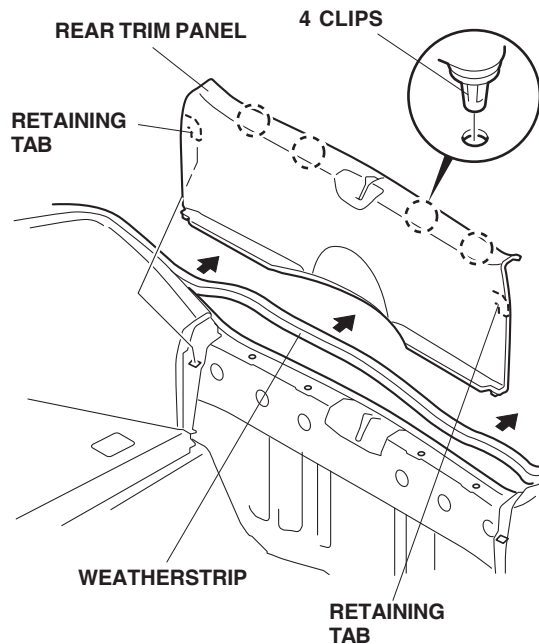

11. Remove the trunk hook (one clip). Open the covers on the tie-down hooks. Remove the screws and the tie-down hooks.

- Insert a plastic trim tool at the edge of the tie-down hook cover and pry it open.
- Take care not to damage the tie-down hook cover when opening it.

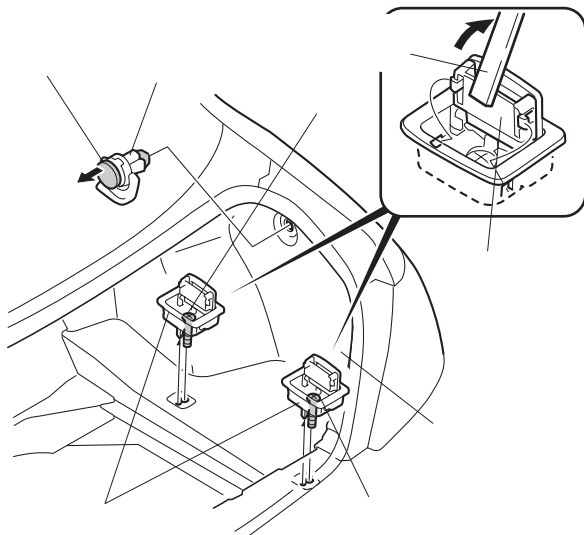

12. Remove the right weatherstrip in the area shown. Remove one clip and pull back the trunk front lining where the clip has been removed.

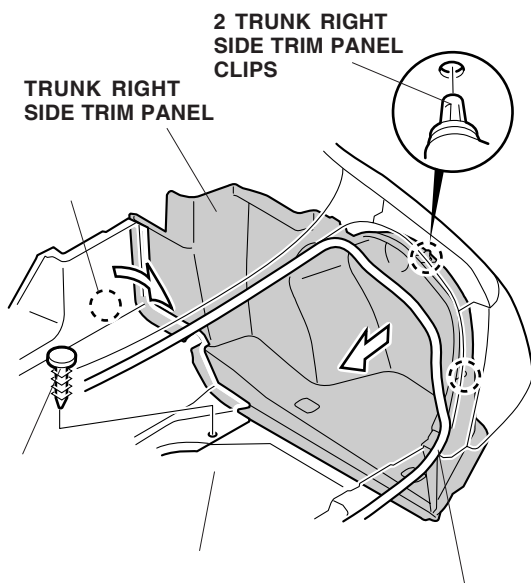

14. Remove one retaining tab, disconnect the vehicle connector, and remove the trunk light.

