

<h1>INSTALLATION INSTRUCTIONS</h1>	Accessory SIDE STEPS P/N 08L33-S3V-200F	Application 2003 MDX	Publications No. BII 24566
			Issue Date SEP 2002

PARTS LIST

Left side step

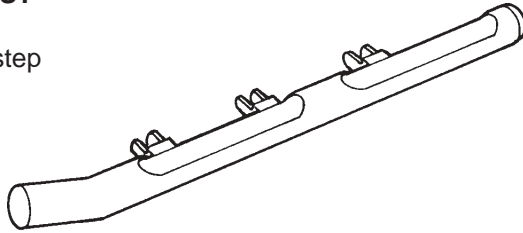

Right side step

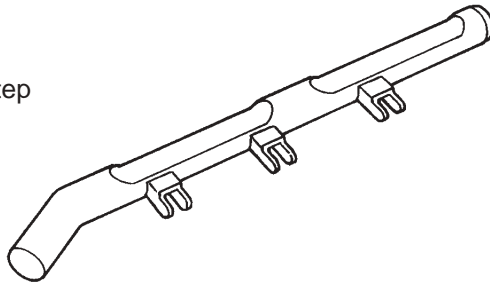

6 "A" Brackets

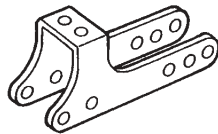

6 "B" Brackets

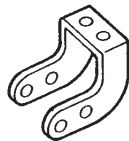

24 Long flange bolts



48 Short flange bolts



48 Flange nuts



TOOLS REQUIRED

- Ratchet
- 13 mm Socket
- 13 mm Combination wrench
- Torque wrench

INSTALLATION

NOTE:

- Thoroughly clean the bottom of the body from the rear of the front wheels to the front of the rear wheels.
- Be extremely careful not to damage the body paint finish.
- These instructions show the left side step being installed; the same procedure applies to installing the right side step.

1. For the two front bracket assemblies, use brackets "A" and "B", four short flange bolts and four flange nuts. Leave the nuts and bolts loose at this time.

Front Bracket Assembly:

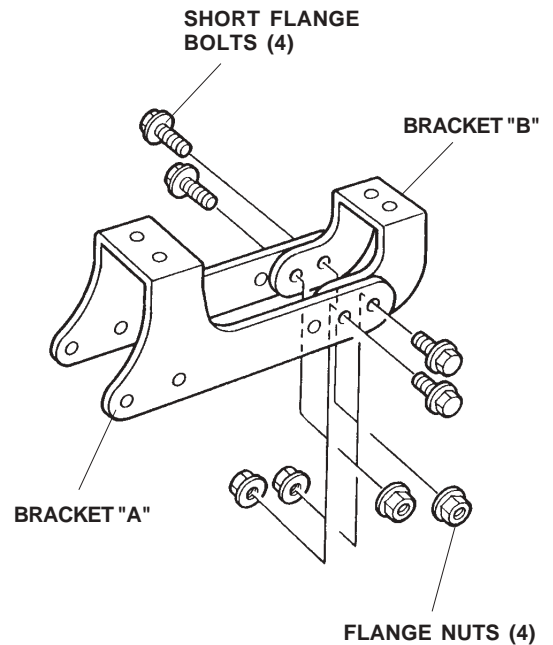

- To assemble four center and rear bracket assemblies, use brackets "A" and "B", four short flange bolts and four flange nuts. Leave the nuts and bolts loose at this time.

Center and Rear Bracket Assembly:

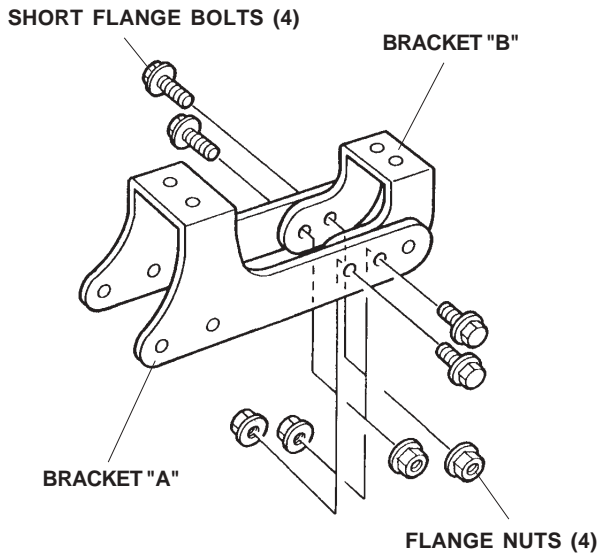

- On the left side of the vehicle, attach one bracket assembly at the front, one at the center, and one at the rear along the body using 12 long flange bolts. Thread the long flange bolts in about 3 or 4 threads.

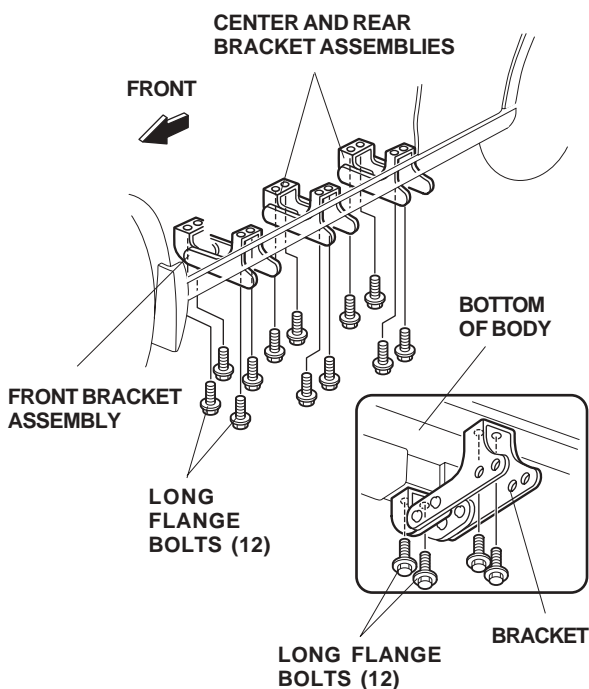

- Attach the left side step to the bracket assemblies using 12 short flange bolts and 12 flange nuts. Torque the flange bolts to 24 N•m (18 lb-ft).

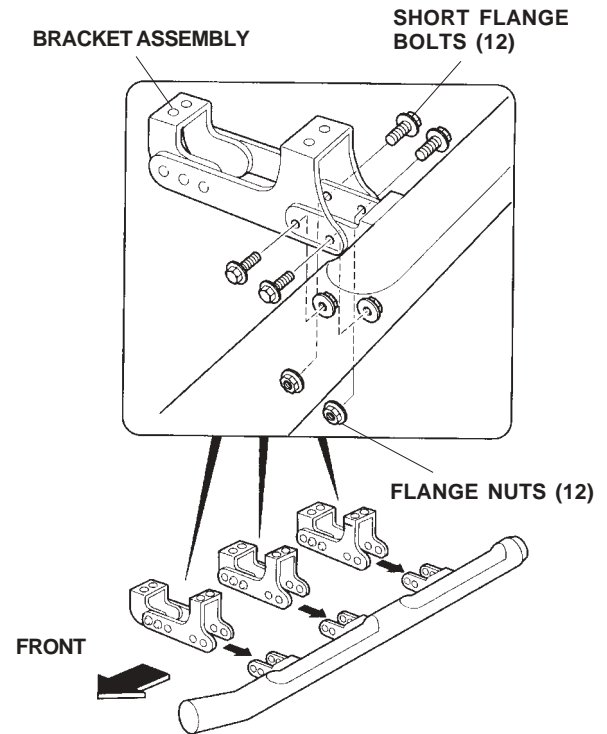

- Adjust the location of the left side step so that the clearance is even between the side step and the body. Torque the short flange bolts you installed in steps 1 and 2 to 24 N•m (18 lb-ft).

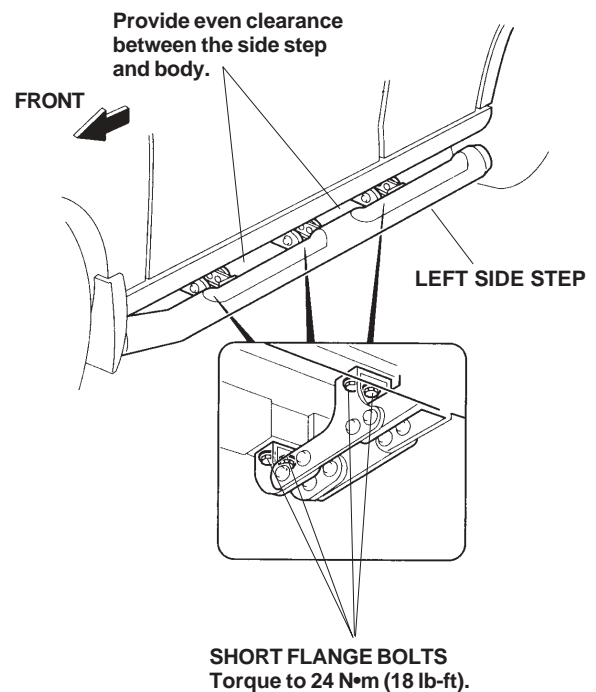

- Repeat steps 1 through 5 to install the right side step on the vehicle.