

PARTS LIST

Left fog light



Right fog light



Left fog light cover

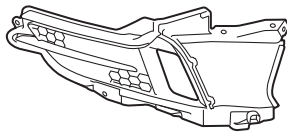

Right fog light cover

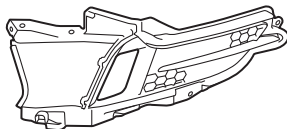

Combination light switch

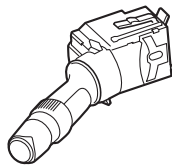

Relay

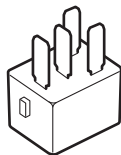

6 Wire ties with clip

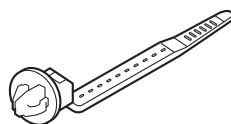

Fog light harness

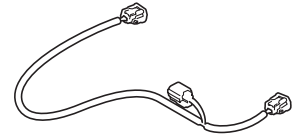

Ground harness

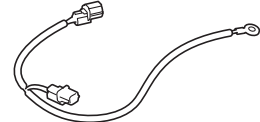

12 Wire ties
(Some may not be used)

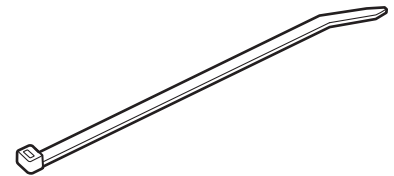

6 Self-tapping screws



2 Wire ties with holder

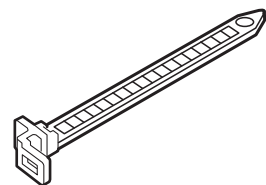

TOOLS AND SUPPLIES REQUIRED

Phillips screwdriver
Ratchet
10 mm Socket
10 mm Open end wrench
Diagonal cutters
Masking tape
Blanket
Container
Shop towel
Drill
3 mm, 6 mm, 8 mm, and 10 mm Drill bits
Ruler
Pushpin
File

The following tools are available through the Acura Tool and Equipment Program. On the iN, click on: Service > Service Bay > Tool and Equipment Program, then enter the number under "Search." Or, call 888-424-6857.

- Trim Tool Set (T/N SOJATP2014)
- Plastic Trim Tool (T/N SILTRIMTL10)

Illustration of the Fog Lights in the Vehicle

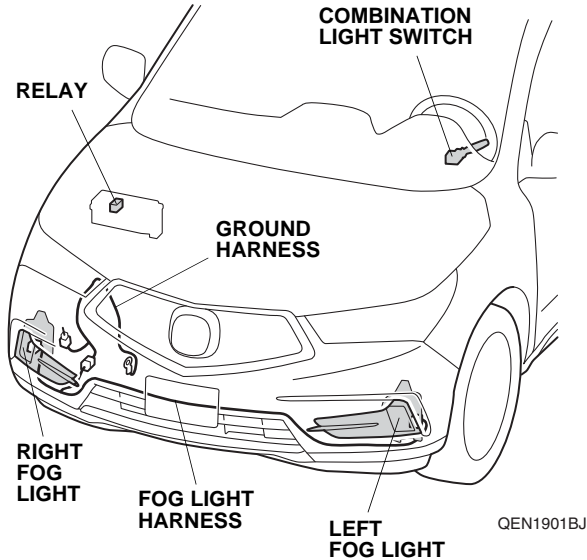

INSTALLATION

Client Information: The information in this installation instruction is intended for use only by skilled technicians who have the proper tools, equipment, and training to correctly and safely add equipment to your vehicle. These procedures should not be attempted by "do-it-yourselfers."

NOTE: If you are also installing front parking sensors (sold separately), install them before you install the fog lights.

1. Disconnect the negative cable from the battery:
 - Wrap a shop towel around the hood latch.

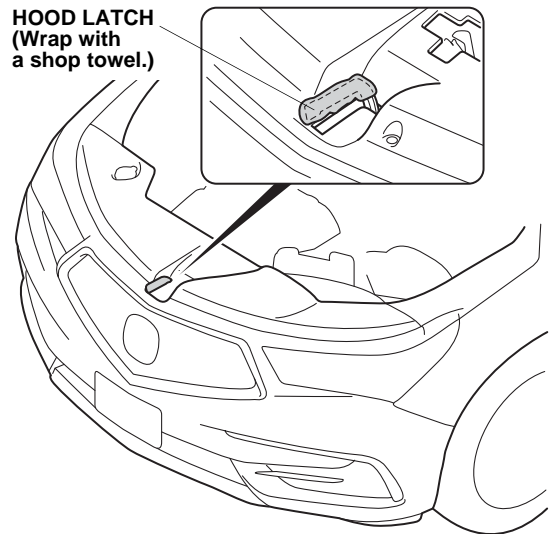

- Remove the front bulkhead cover.

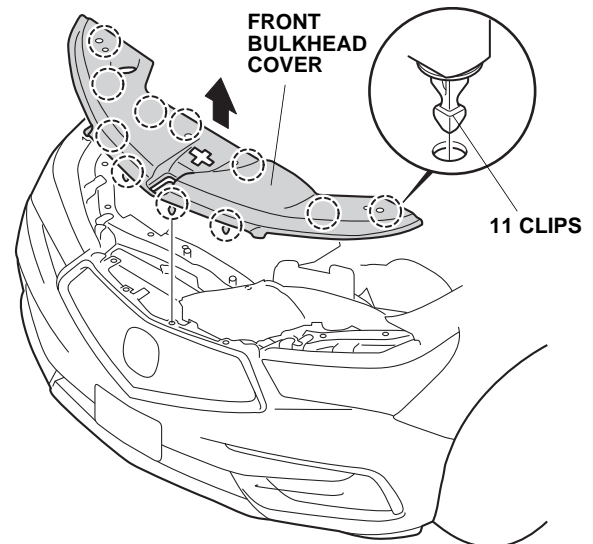

- Remove the air intake tube.
- Disconnect the negative cable from the battery.

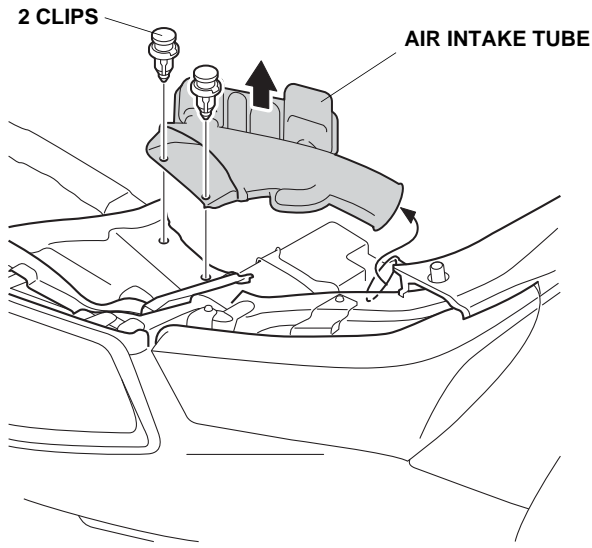

QE03003AJ

2. Remove the front bumper:

- Apply masking tape as shown on each side.

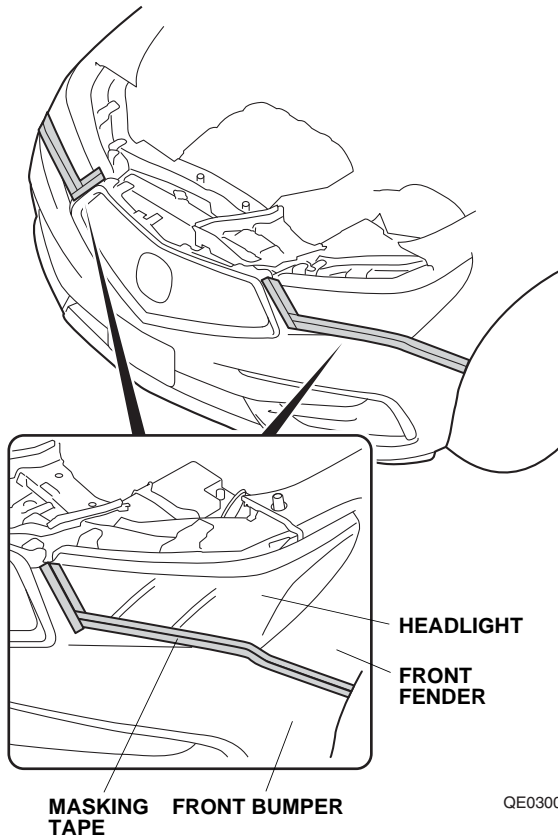

QE03004BJ

- Remove the air intake guide.

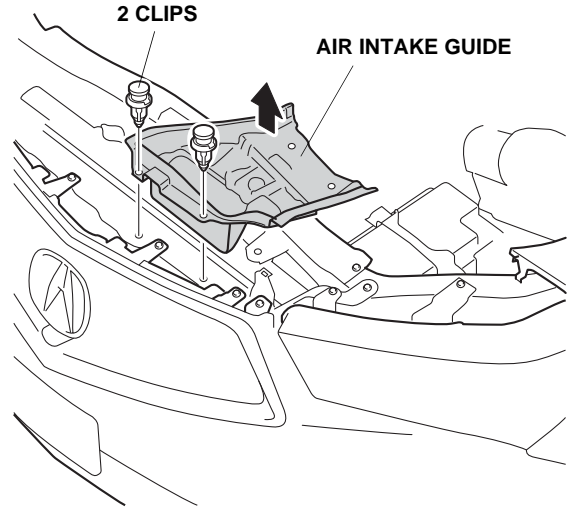

QE03005AJ

- Remove the four self-tapping screws, the two push rivet clips, the two short clips, the four clips, the four short clips, the four washer-bolts, and the four flange bolts.

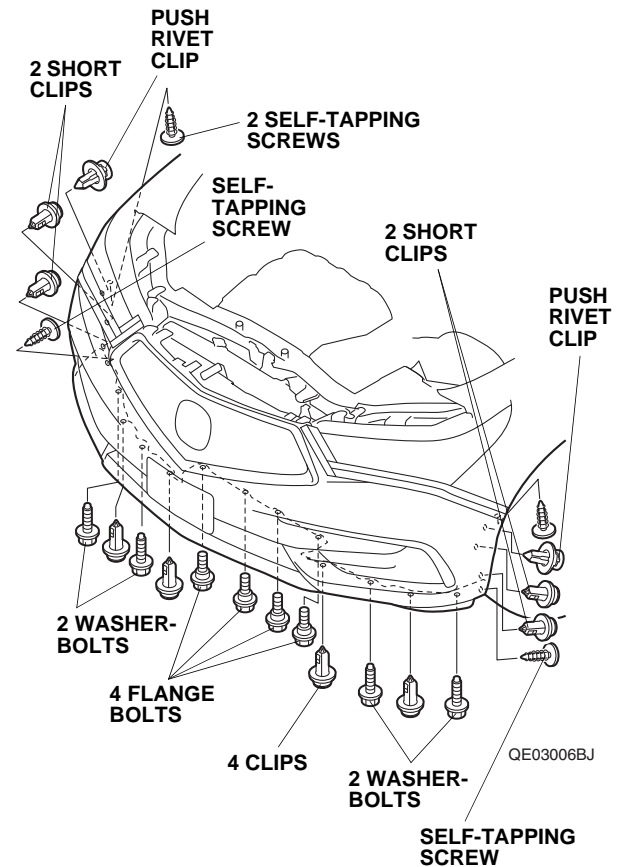

QE03006BJ

- Release the three retaining tabs on each side.

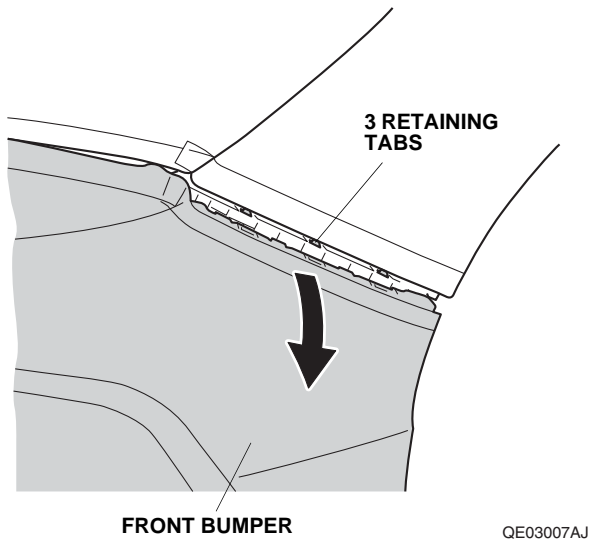

- With the help of an assistant, release the four retaining tabs on each side.

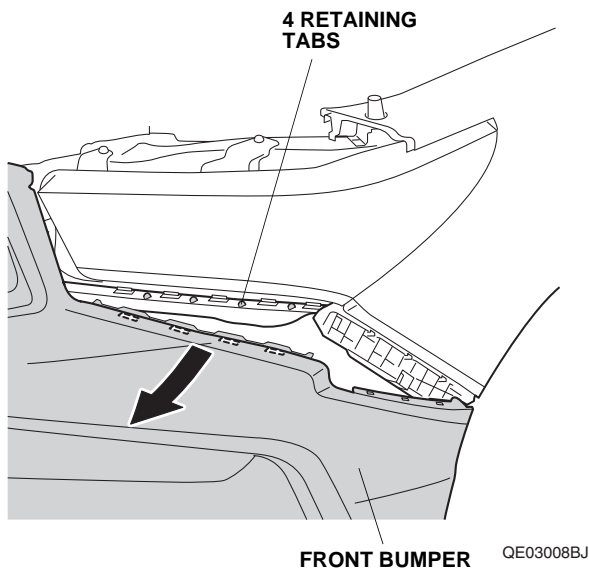

- With the help of an assistant, release the front bumper and unplug the vehicle connector.

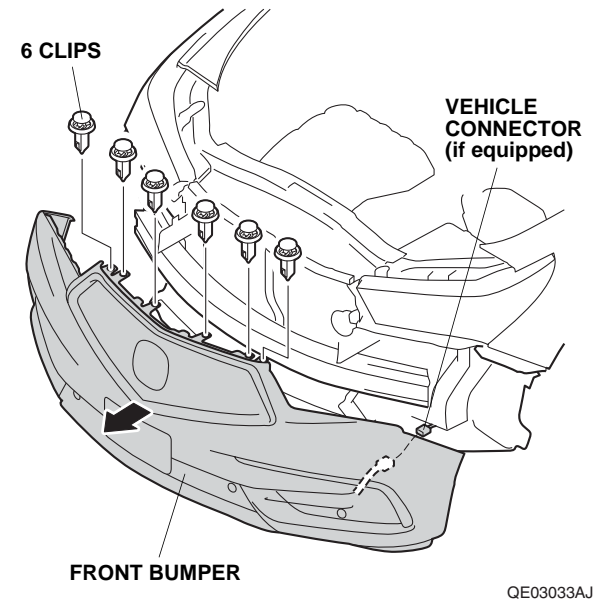

- If the vehicle is equipped with headlight washers, place a suitable container under the tube end to collect the washer fluid. Disconnect the headlight washer tube.
- Remove the front bumper. Place the front bumper on the blanket to prevent damage.

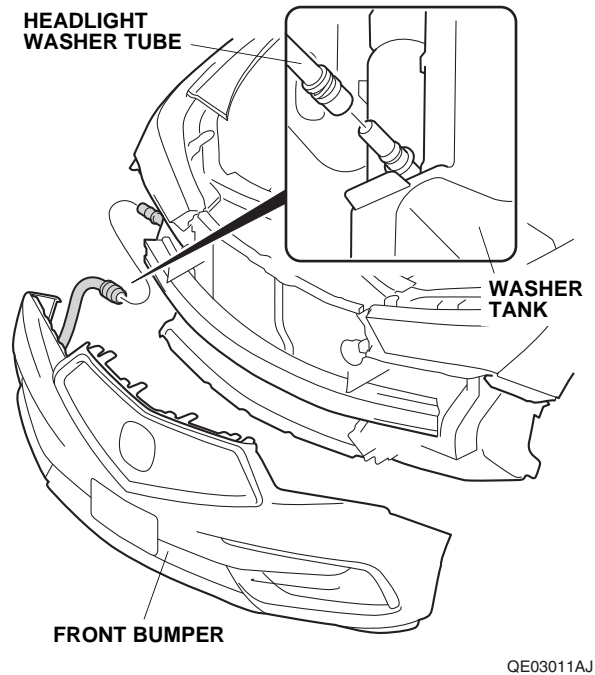

- Remove one washer-bolt and one clip and pull back the right front inner fender as shown.

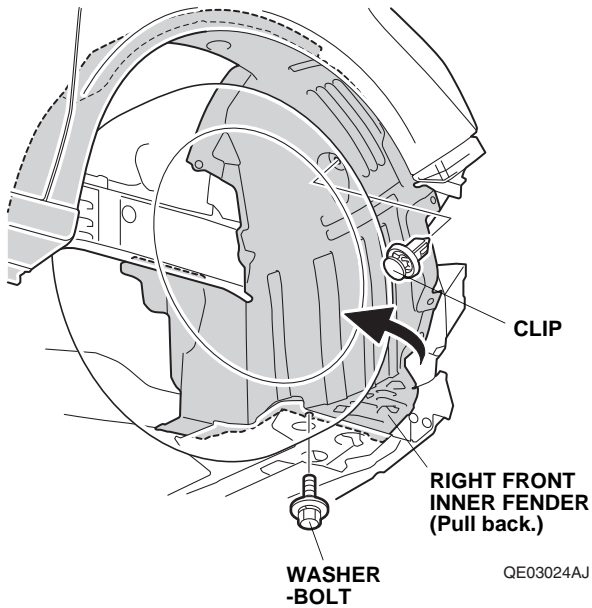

- If the vehicle is equipped with headlight washers, release the headlight washer tube.

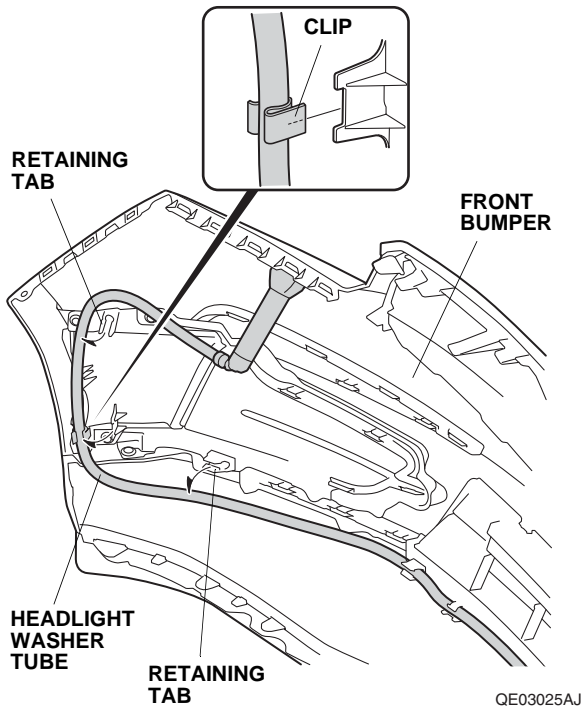

- Remove the left front bumper duct.

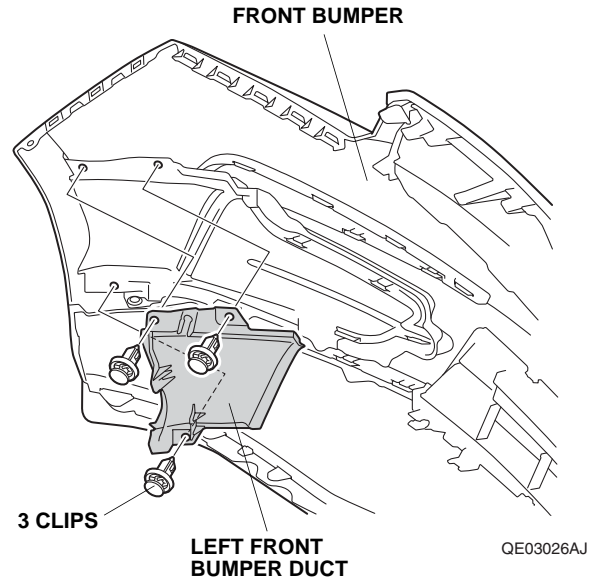

- If the vehicle is equipped with front parking sensors, release the front parking sensor harness and unplug the front parking sensor connector.

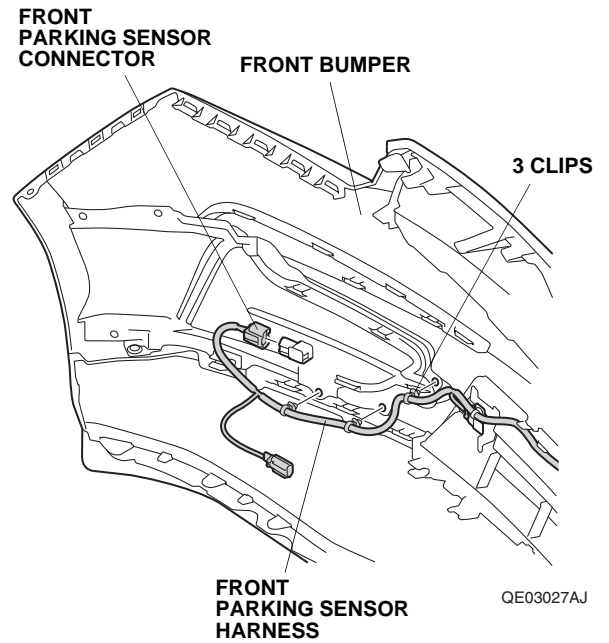

7. Remove the left intake trim.

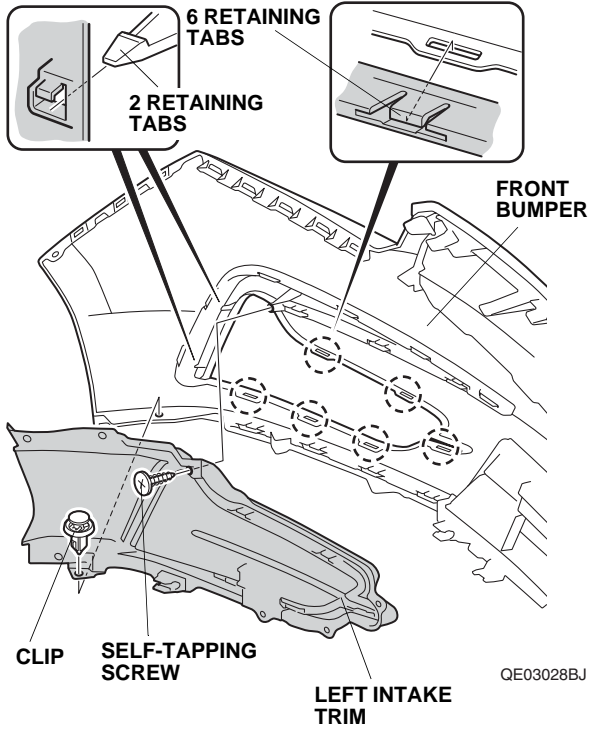

8. Remove the cap or front parking sensor.

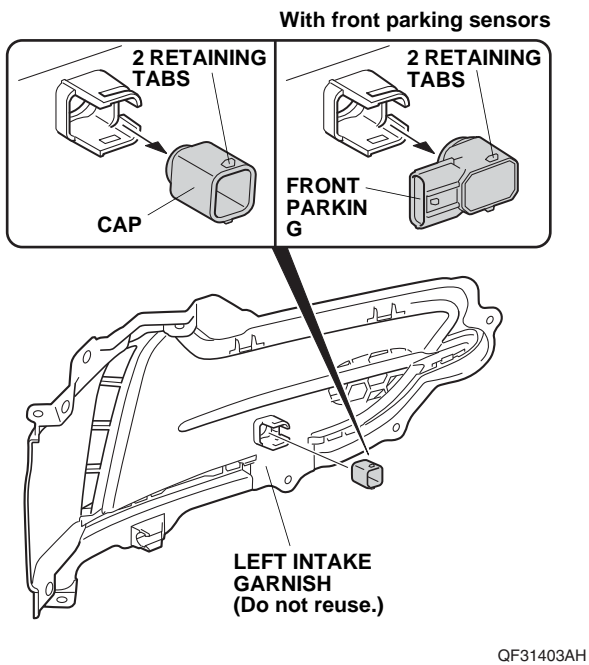

If the vehicle is equipped with headlight washers, continue with step 9. If not, go to step 11.

9. Using a pushpin, pierce the left fog light cover as shown.

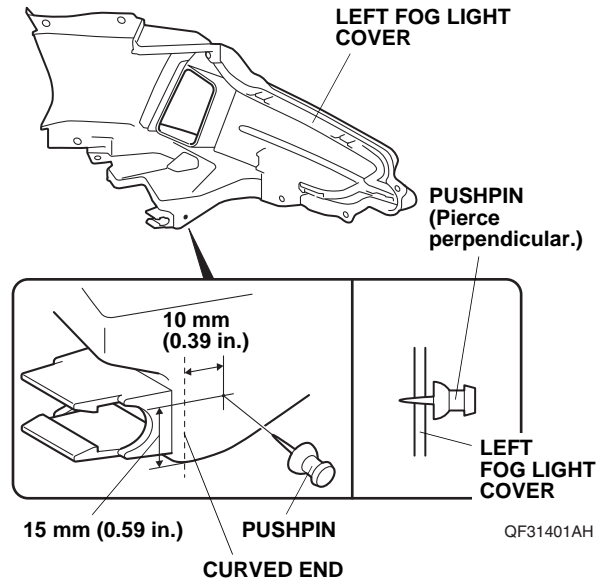

10. While wearing eye protection, drill the pierced mark to 10 mm.

- First drill with a 3 mm drill bit, then with a 6 mm drill bit, then with an 8 mm drill bit and finish with a 10 mm drill bit.
- Remove any burrs.

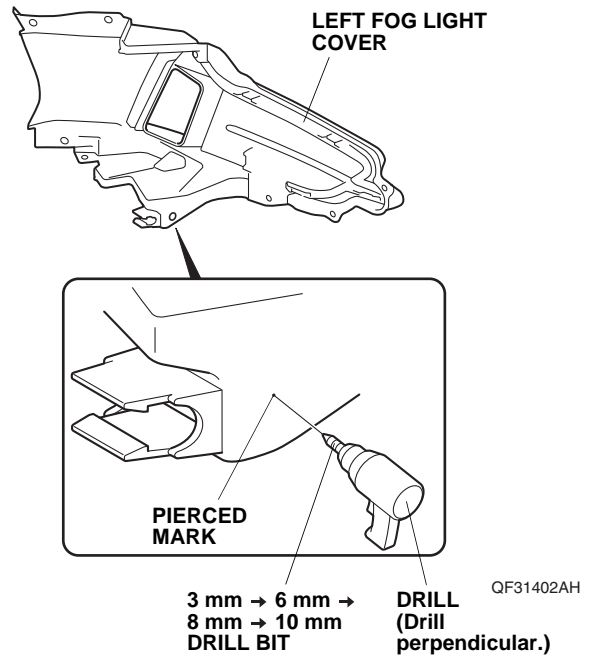

11. Install the cap or front parking sensor to the left fog light cover with two retaining tabs.

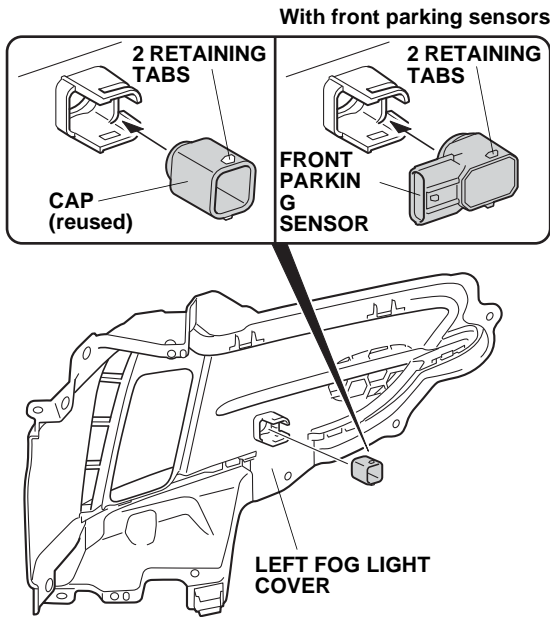

QF31404AH

12. Install the left fog light cover to the front bumper with eight retaining tabs, one clip, and one self-tapping screw.

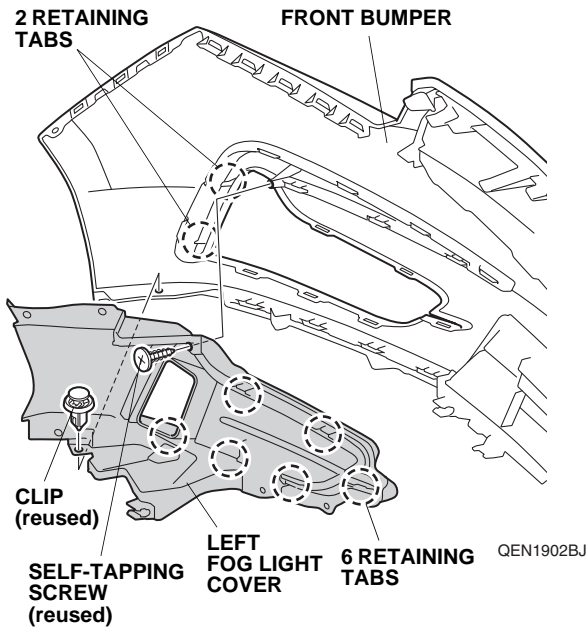

QEN1902BJ

13. If the vehicle is equipped with front parking sensors, secure the front parking sensor harness to the left fog light cover with three clips and plug the front parking sensor connector into the front parking sensor.

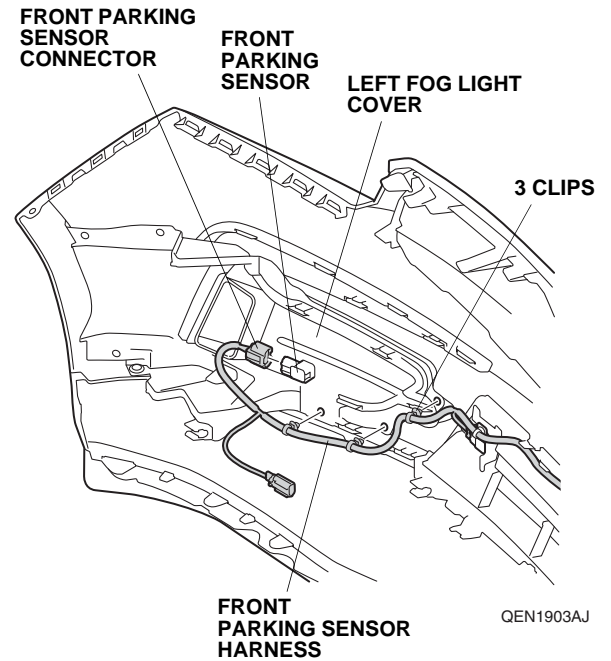

QEN1903AJ

14. Install the left front bumper duct to the left fog light cover with three clips.

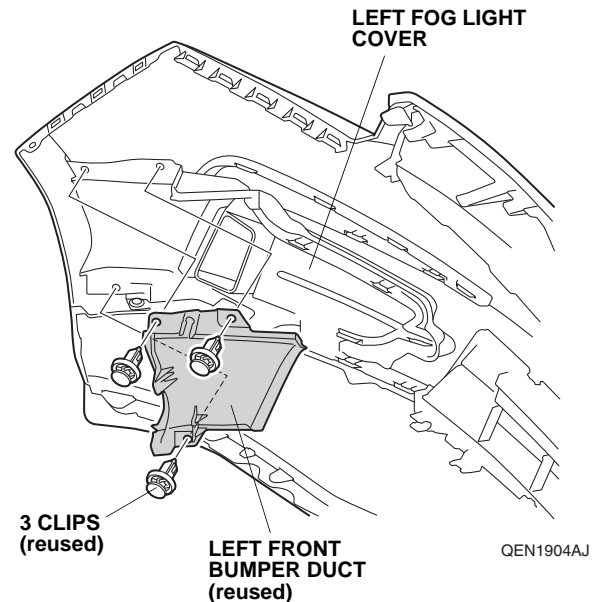

QEN1904AJ

- If the vehicle is equipped with headlight washers, secure the headlight washer tube to the two retaining tabs on the left front bumper duct and left fog light cover. Then secure the clip on the headlight washer tube to the left front bumper duct.

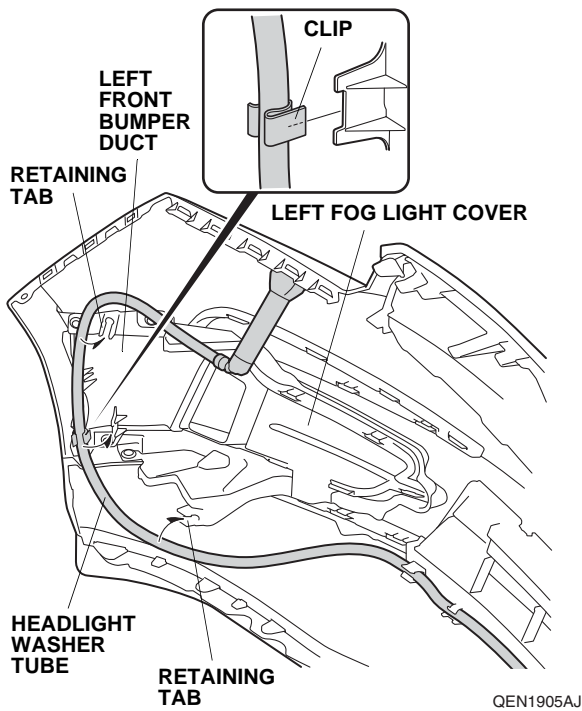

- Install the left fog light to the left fog light cover with three self-tapping screws.

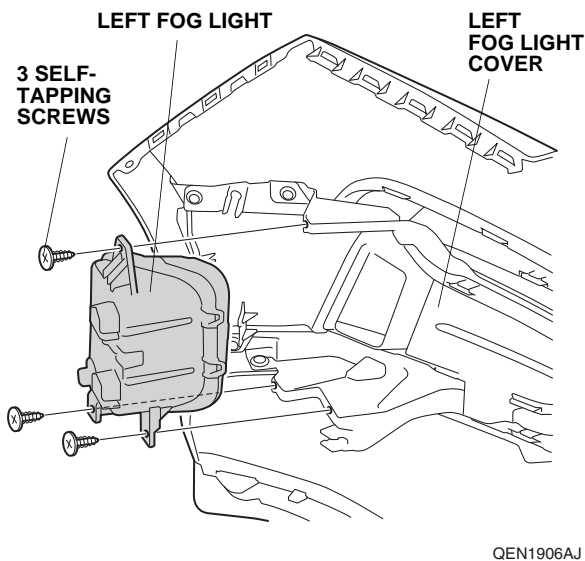

- Repeat steps 4 through 16 to install the right fog light.

- Plug the two fog light harness 3-pin connectors into the left and right fog lights.

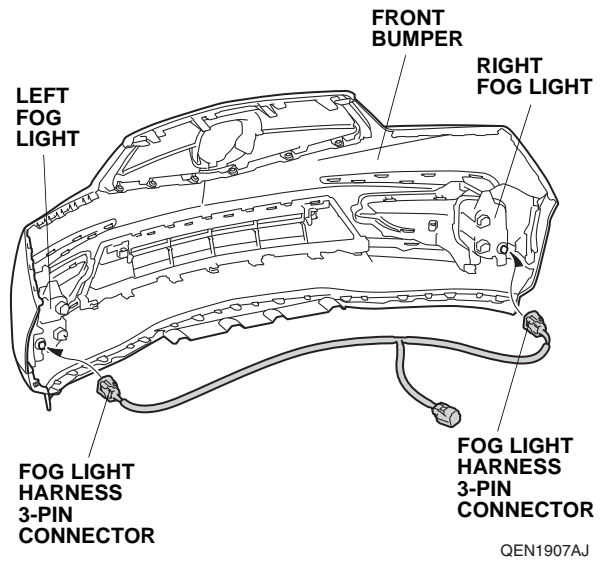

- Secure the fog light harness to the left and right fog light covers with two wire ties.

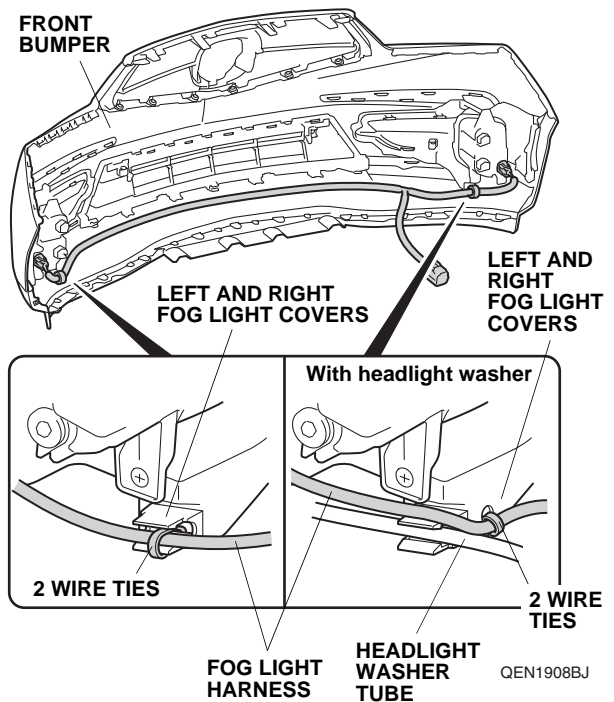

If the vehicle is equipped with front parking sensors, continue with step 20. If not, go to step 22.

With front parking sensors

20. Using diagonal cutters, cut the clip portion off of six wire ties with clip.

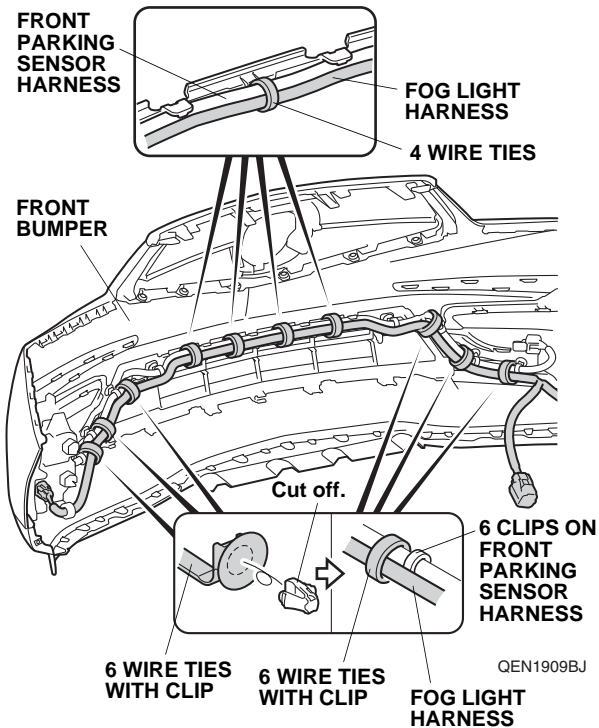

21. Secure the fog light harness to the front parking sensor harness with four wire ties and six wire ties with clip. Go to step 23.

Without front parking sensors

22. Secure the fog light harness to the left and right fog light covers with six wire ties with clip. Then secure the fog light harness to the retaining tabs on the front bumper center lower grille.

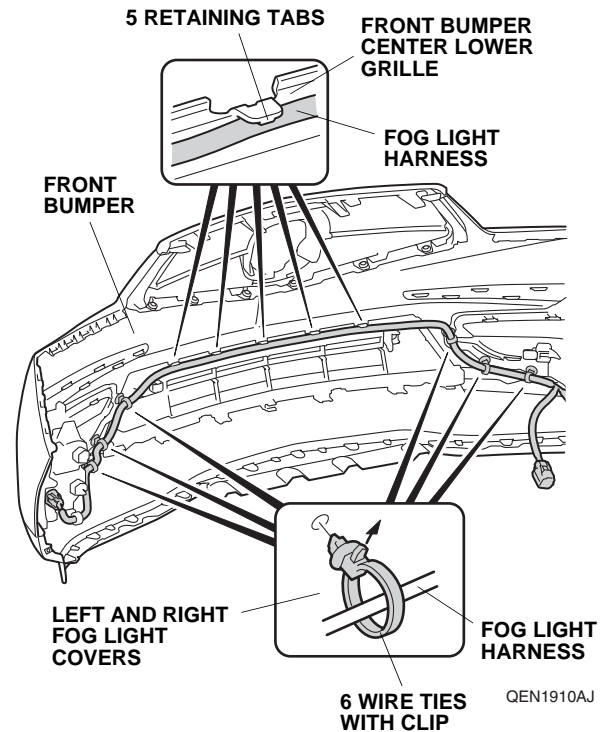

23. Locate the vehicle 1-pin connector taped to the vehicle harness. Remove the tape to free the vehicle 1-pin connector. Remove the dummy connector from the vehicle 1-pin connector.

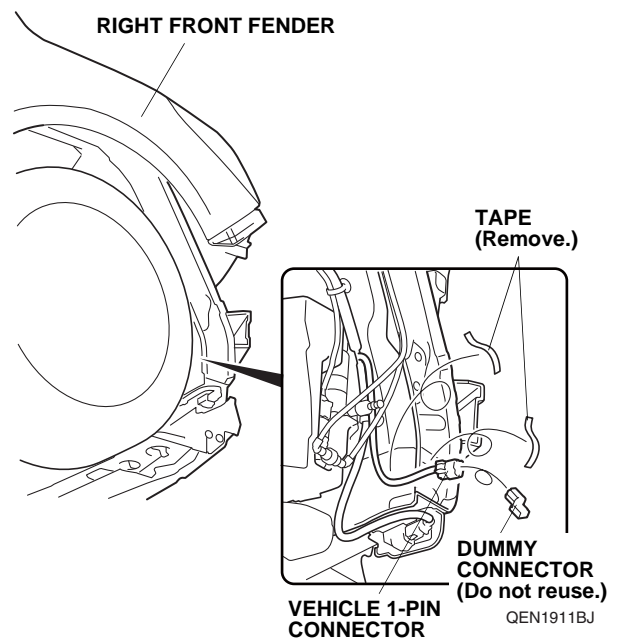

24. Remove the vehicle ground bolt.

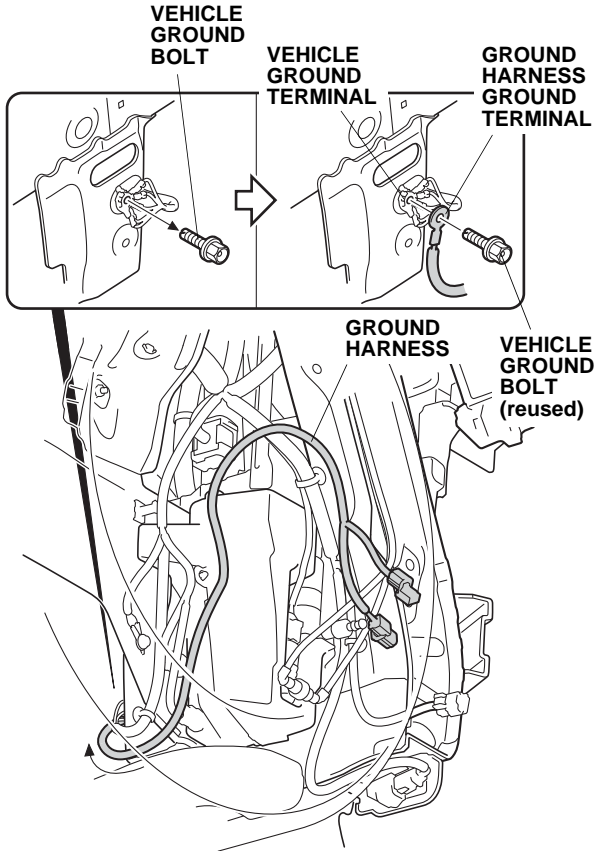

QEN1912BJ

25. Route the ground harness as shown. Attach the ground harness ground terminal to the vehicle ground terminal and install the vehicle ground bolt. NOTE: Do not put the ground terminal calkings on top of one another.

26. Route the ground harness along the vehicle harness as shown.

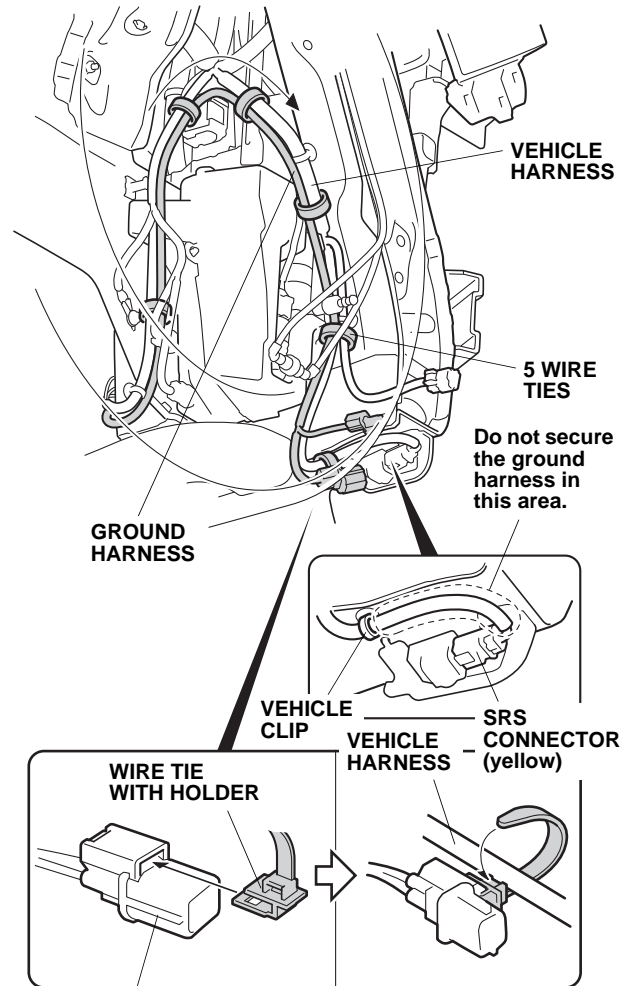

GROUND HARNESS
2-PIN CONNECTOR

QEN1915BJ

27. Secure the ground harness to the vehicle harness with five wire ties. Then secure the ground harness 2-pin connector to the vehicle harness with one wire tie with holder.

28. Plug the vehicle 1-pin connector into the ground harness 1-pin connector.

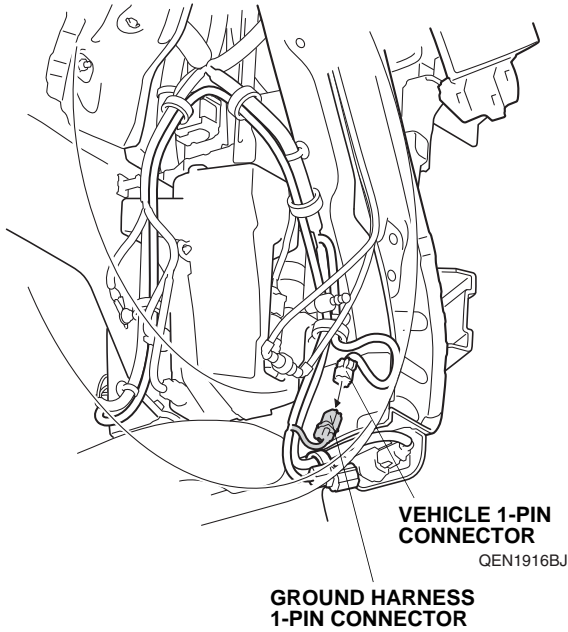

29. Secure the ground harness 1-pin connector to the ground harness and vehicle harness with one wire tie with holder.

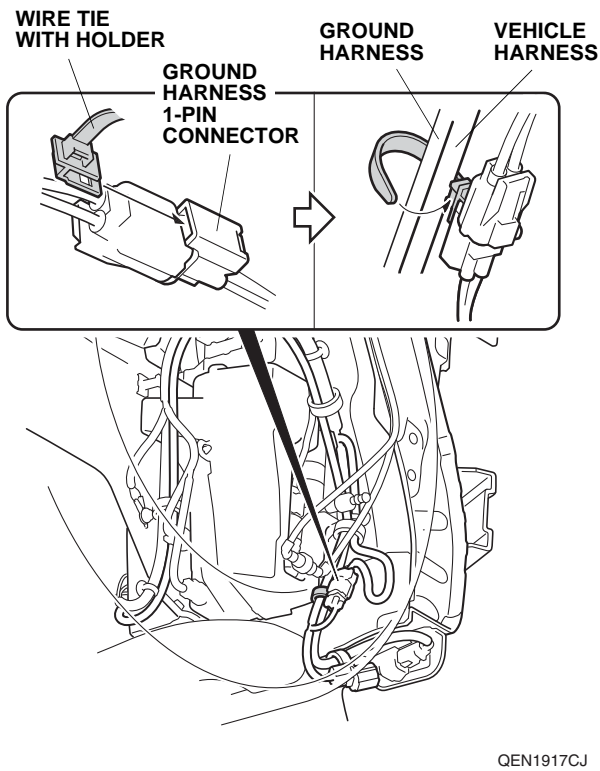

30. Bundle up the excess vehicle harness and secure it to the ground harness with one wire tie.

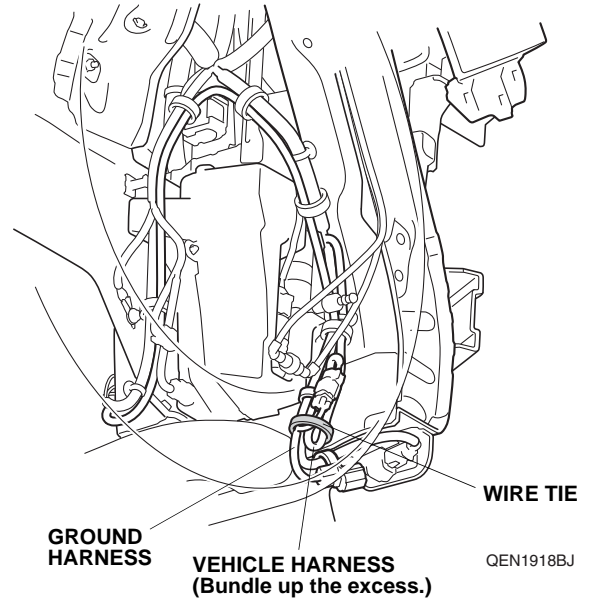

31. With the help of an assistant, bring the front bumper close to the vehicle. Plug the fog light harness 2-pin connector into the ground harness 2-pin connector, then install the front bumper.

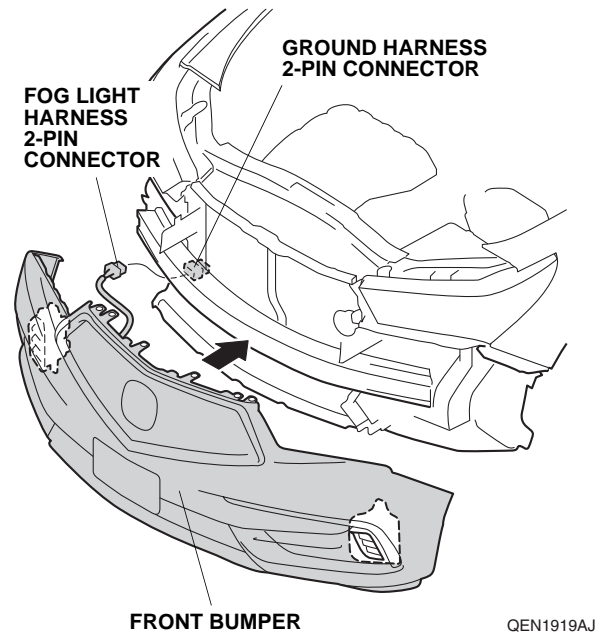

32. Pull away the door opening seal and remove the driver's dashboard side lid.

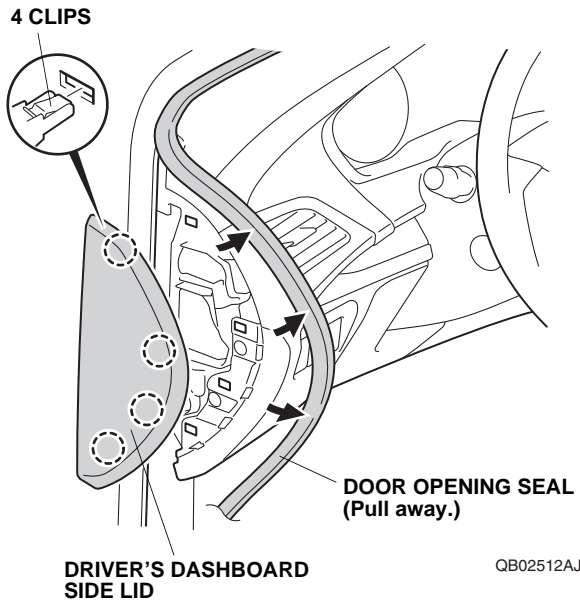

33. Remove the driver's dashboard side vent.

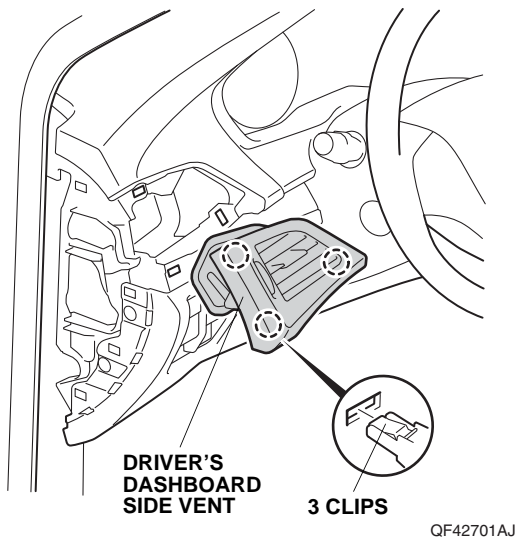

34. Remove the driver's outer dashboard trim.

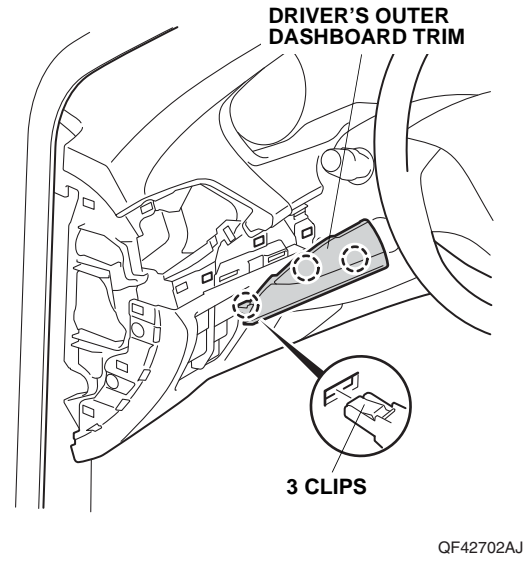

35. Remove the driver's dashboard lower cover.

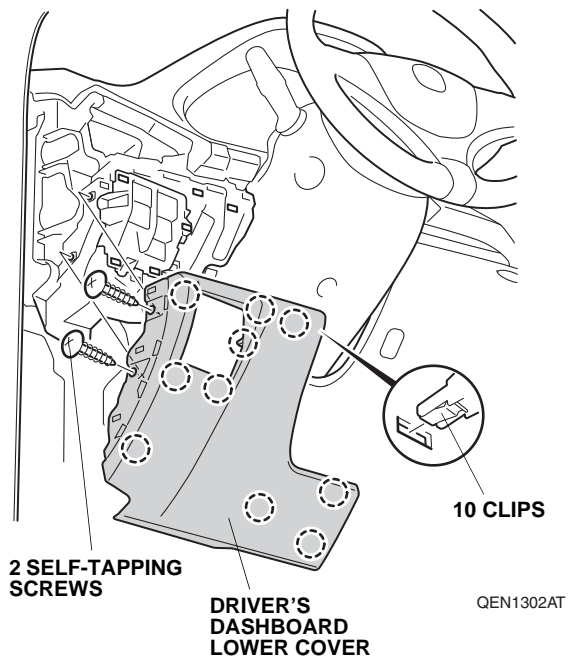

36. Connect the negative cable to the battery, then turn the ignition to ON. Lower the steering wheel by moving the adjustment switch.

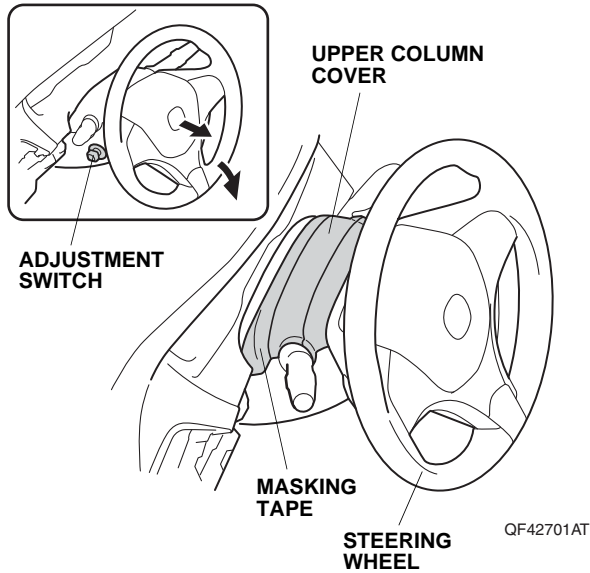

37. Attach masking tape to the upper column cover as shown.
38. Turn the steering wheel 90° counterclockwise. Using a plastic trim tool, release the retaining tab.

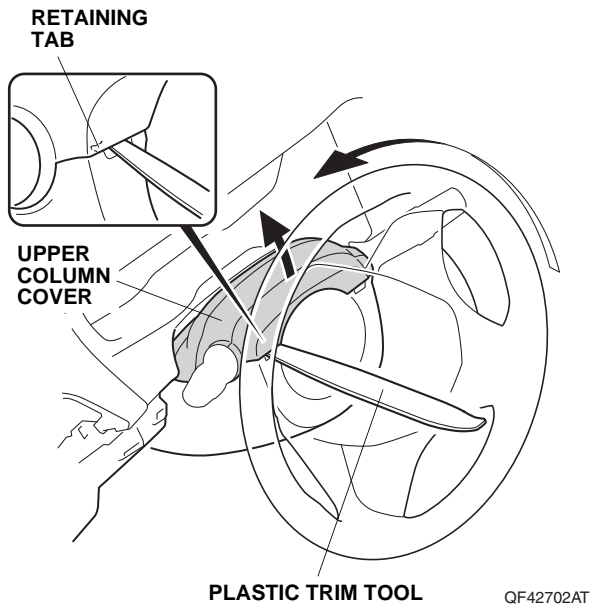

39. Turn the steering wheel 180° clockwise. Using a plastic trim tool, release the retaining tab.

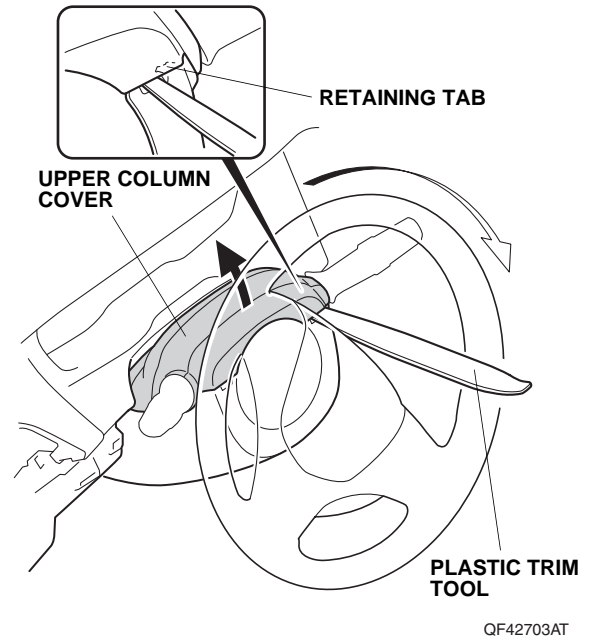

40. Release the upper column cover and secure the upper column cover to the dashboard with the masking tape.

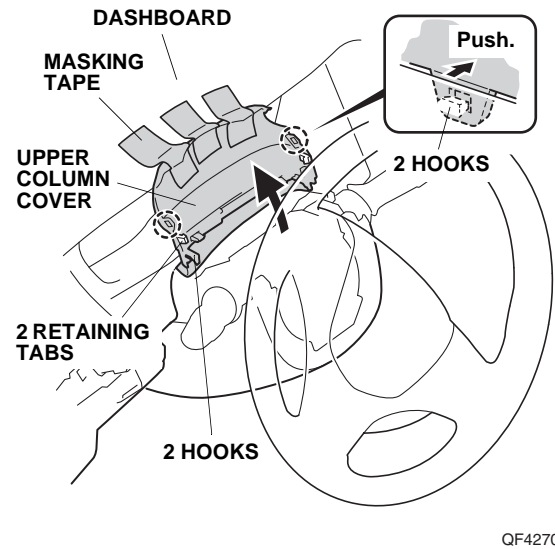

41. Remove one self-tapping screw from the lower column cover.

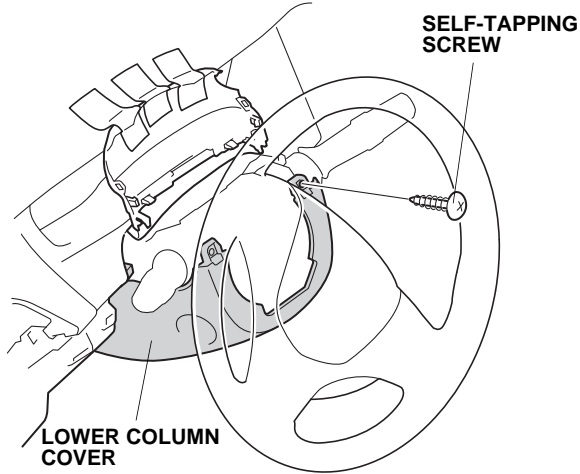

QF42705AT

42. Turn the steering wheel 180° counterclockwise and remove the other self-tapping screw from the lower column cover.

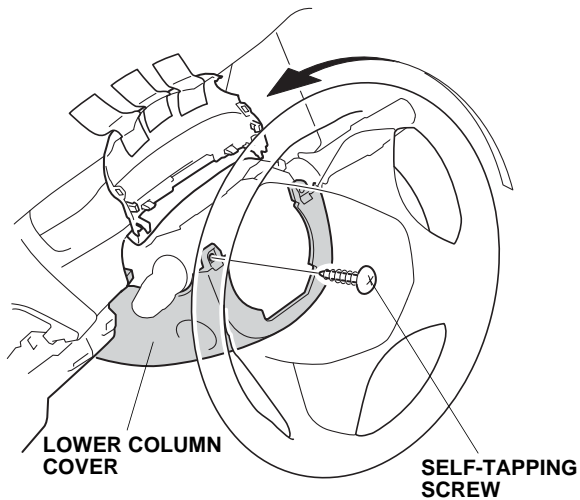

QF42706AT

43. Turn the ignition to OFF.
NOTE: The steering wheel automatically moves fully in and up. Make sure the steering wheel is not interfering with the vehicle parts.
44. Disconnect the negative cable from the battery.

45. Remove the driver's inner dashboard trim.

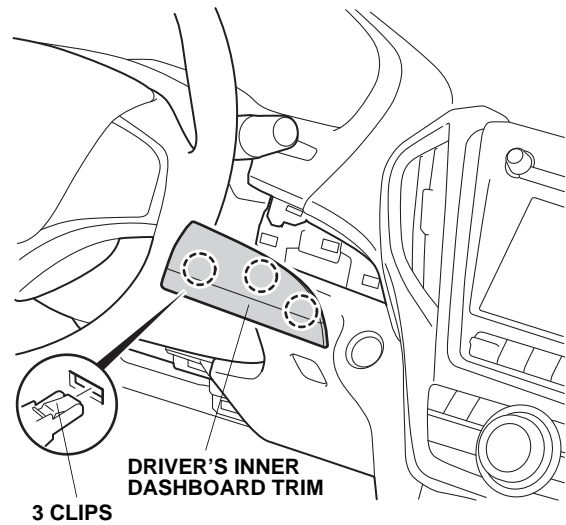

QE03029AJ

46. Remove the bolt from the driver's dashboard center lower cover.

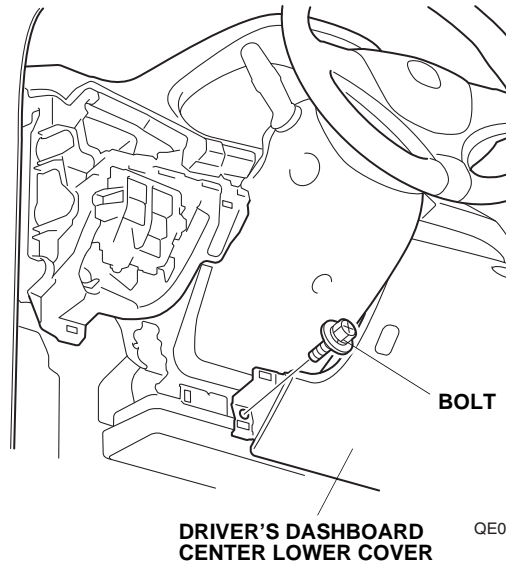

QE03030BJ

47. Remove the driver's dashboard center lower cover and unplug the vehicle connector and temperature sensor.

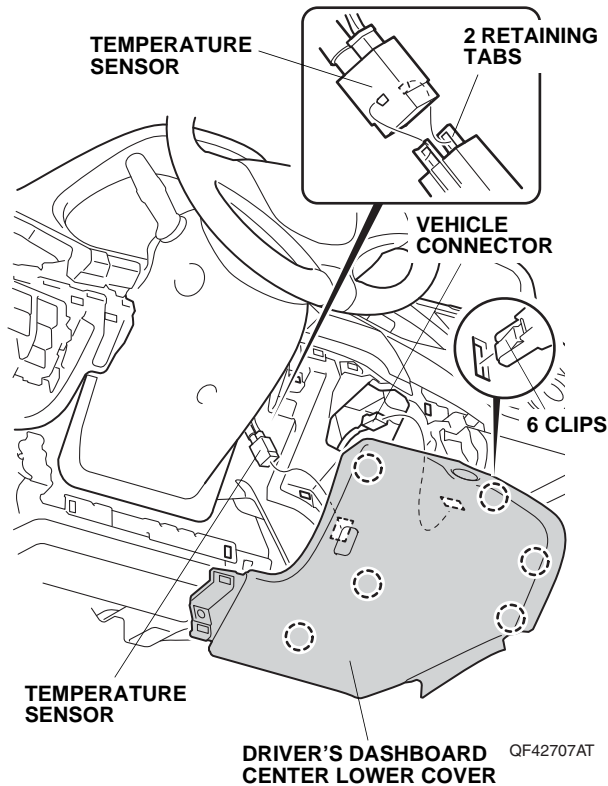

48. Remove the lower column cover and unplug the vehicle connector.

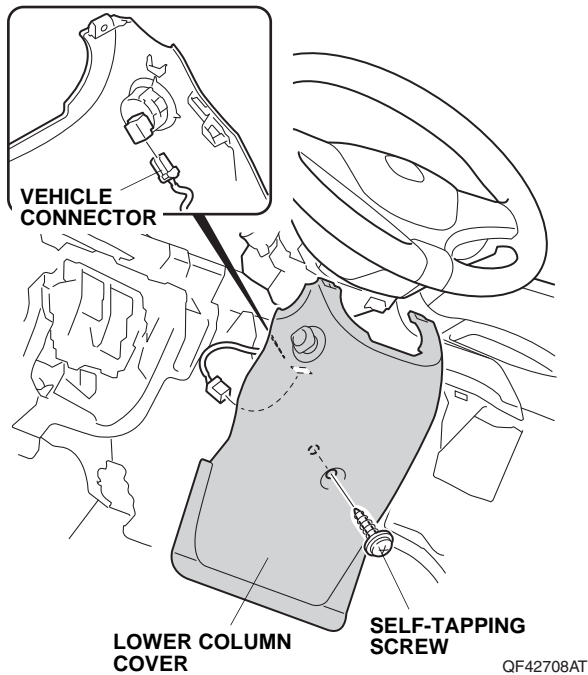

49. Unplug the vehicle connector from the combination light switch.

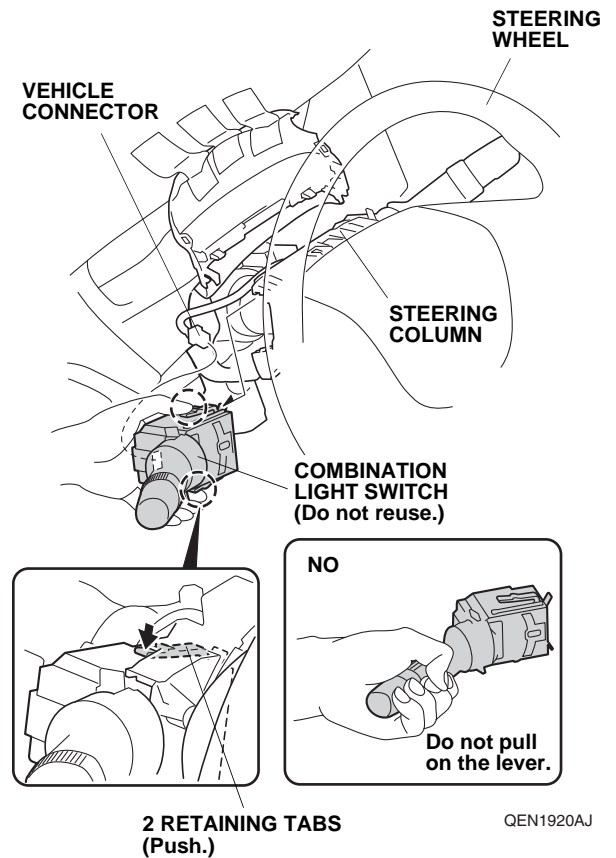

50. While pushing the two retaining tabs, slide the combination light switch out and remove it from the steering column.
NOTE: Do not pull on the lever when removing the switch.

51. Install the new combination light switch on the steering column.
 NOTE: Do not push on the lever when installing the switch.

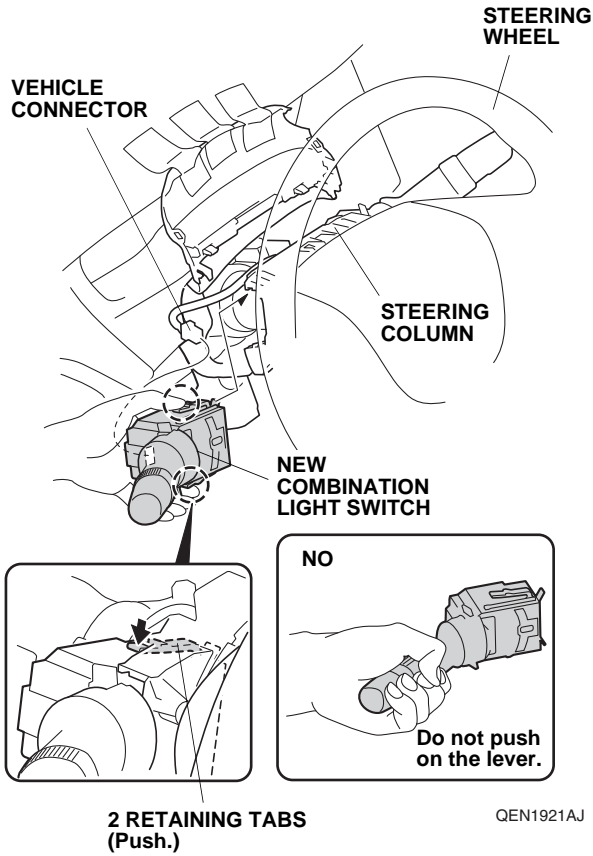

52. Plug the vehicle connector into the new combination light switch. Make sure the vehicle harness has some slack.

53. Under the hood, remove the relay box upper cover.

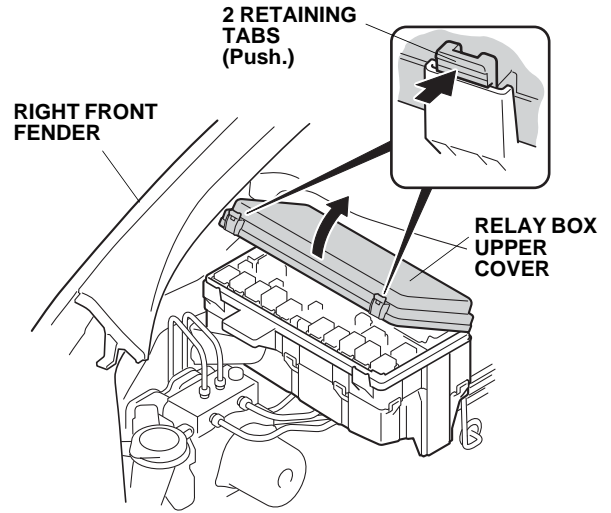

QBN1947AH

54. Plug the relay into the relay box as shown.

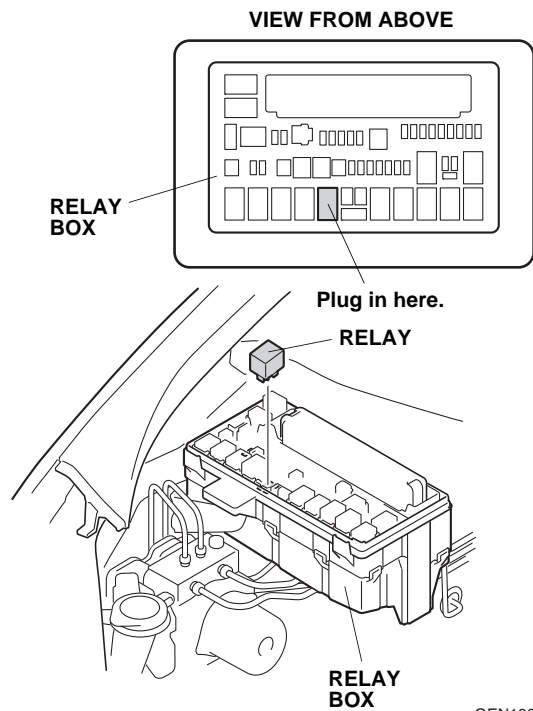

55. Check that all wire harnesses are routed properly and all connectors are plugged in.
56. Install all removed parts except for the front bulkhead cover and the intake air tube.
57. Connect the negative cable to the battery.
58. Install the front bulkhead cover and the intake air tube.
59. Press and hold the audio unit power button for 2 seconds to restore the audio and navi (if equipped) system functions.
60. Set the clock.
61. If necessary restore the systems back to normal operation as described in the service information.
62. If necessary fill the washer tank to the proper level.

Check the Operation of the Fog Light

63. Turn the headlight switch to the AUTO or "D" position (headlights on low beam).
64. Turn on the fog light switch (indicator is on).
65. If the fog lights do not turn on, check the fuse and all the connectors, including the ground cable.

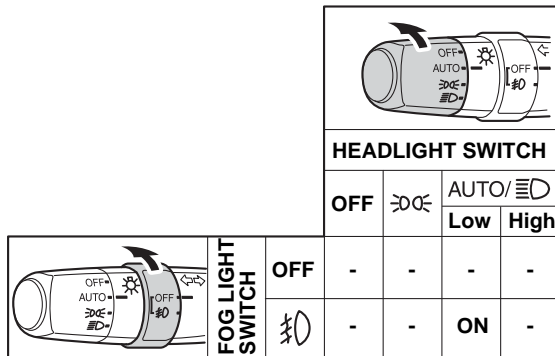

The diagram shows two rotary switches. The top one is the headlight switch with positions OFF, AUTO, and a fog light symbol. The bottom one is the fog light switch with positions OFF and ON. Below them is a table showing the combination of switch positions for fog light operation.

		HEADLIGHT SWITCH			
		OFF	☸	AUTO/☸	
				Low	High
FOG LIGHT SWITCH	OFF	-	-	-	-
	☸	-	-	ON	-

QBN2108AH

NOTE: The fog light lenses may cloud when the outside temperature is cold; this is normal and should go away in warm weather.

How to Aim the Fog Lights

66. Adjust the fog light aim by turning the adjustment screw in or out until the correct aim is obtained. Adjust the aim according to local laws and regulations.

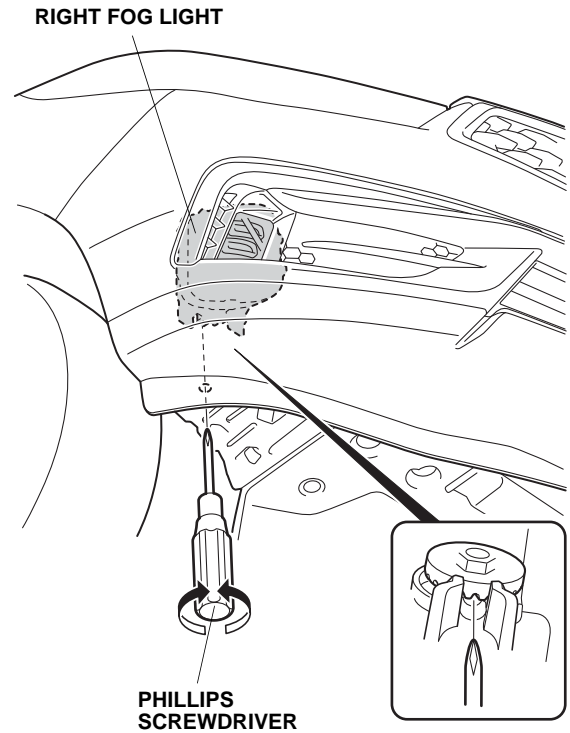

QEN1923AJ

LED REPLACEMENT

NOTE: The fog light (LED) is a part of the fog light assembly and cannot be replaced by itself.