

# ACURA INSTALLATION INSTRUCTIONS

Accessory  
**WOOD-LOOK  
STEERING WHEEL**

Application  
**2005 RL**

Publications No.  
**BII 27039**  
Issue Date  
**SEP 2004**

## PARTS LIST

Wood-look steering wheel

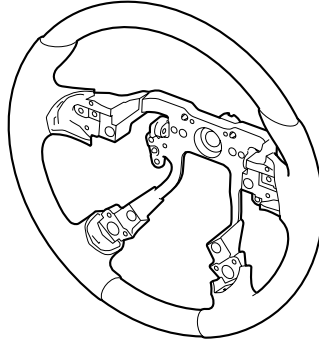

2 Torx bolts



Important Information

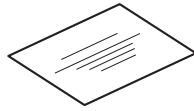

## TOOLS REQUIRED

Phillips screwdriver  
Flat-tip screwdriver  
19 mm T-handle wrench  
Torque wrench  
Steering wheel puller  
T30 Torx bit

## INSTALLATION

**Customer Information:** The information in this installation instruction is intended for use only by skilled technicians who have the proper tools, equipment, and training to correctly and safely add equipment to your vehicle. These procedures should not be attempted by “do-it-yourselfers.”

### NOTE:

- Observe all safety notes and precautions described in the Service Manual in addition to these described in this Installation Instruction.
- After installing the steering wheel, you must align the steering wheel spoke angle to the straight ahead position by adjusting the front toe.

- Make sure you have the anti-theft codes for the radio and navigation system, then write down the radio presets.
- Disconnect the negative cable from the battery, and wait for at least 3 minutes before you start to install the steering wheel.
- From under of the driver's side airbag, pry up on the four retaining tabs, and remove the access panel.
- Remove the horn ground terminal and the airbag connectors from the holder on the cord guide. Unplug the horn ground terminals.

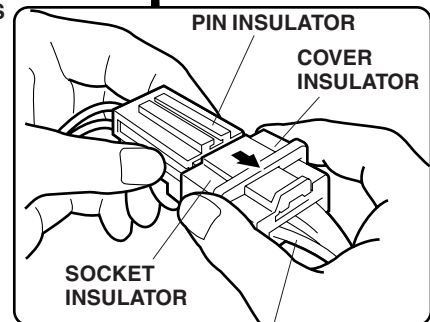
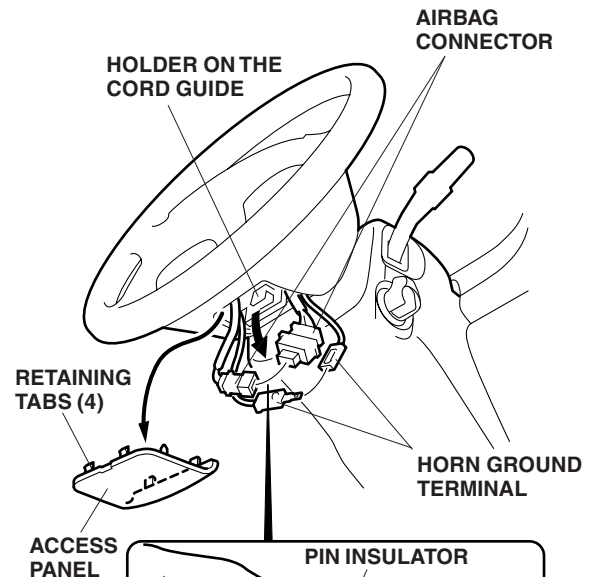

Do not pull on the harness wires.

- Unplug the airbag connectors. While holding the pin insulator, pull out on the cover insulator. Do not pull on the socket insulator.

- Using hand tools, remove and discard the two Torx bolts that secure the airbag, and remove the airbag. Carefully set the airbag in a secure location with the pad facing up. Do not drop or bump the airbag against anything.

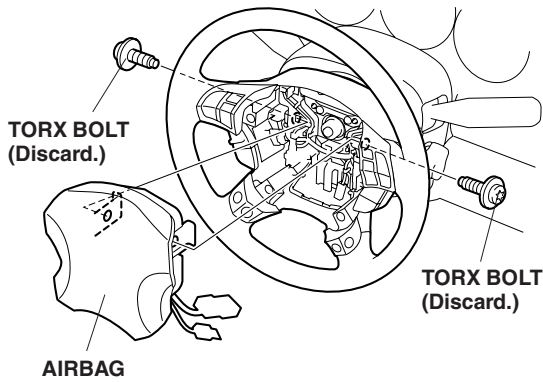

- Turn the steering wheel so the front wheels are in the straight-ahead position.
- Remove the steering wheel nut. Disconnect the vehicle 13-pin connector from the cable reel. Using a steering wheel puller, remove the steering wheel. Do not thread the steering wheel puller bolts in more than 10 mm. Be careful not to move the steering wheel during removal.

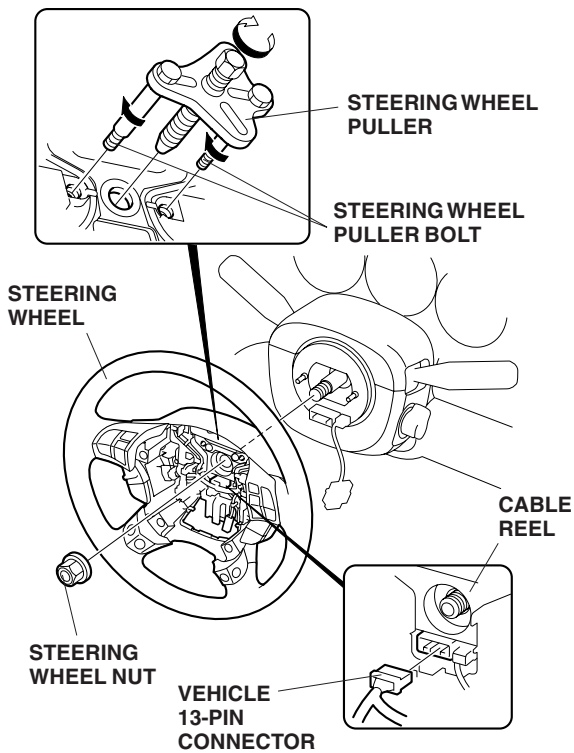

- Release the two vehicle 2-pin connectors from the holders on the cord guide.

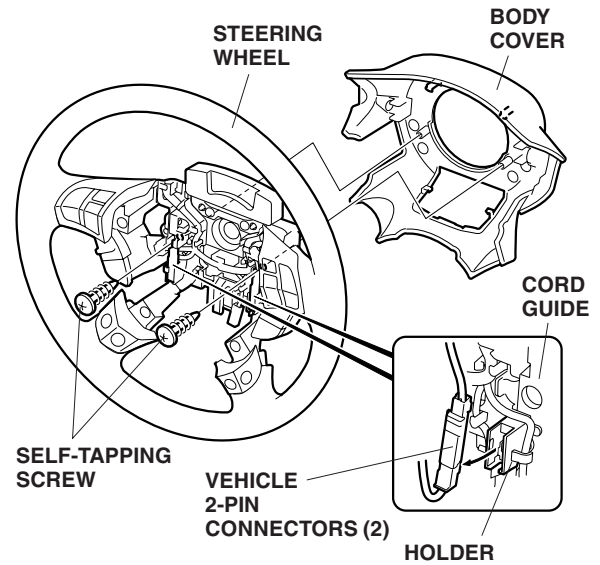

- Remove the two self-tapping screws that fasten the body cover to the steering wheel and remove the body cover.
- Remove the two washer-screws that fasten the steering dynamic damper to the steering wheel and remove the steering dynamic damper.

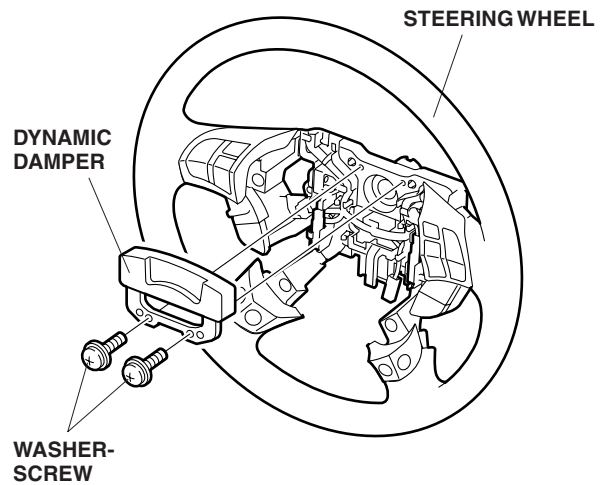

12. Remove the 10 washer-screws that fasten the switches and/or lids to the steering wheel and remove the switches and/or lids.

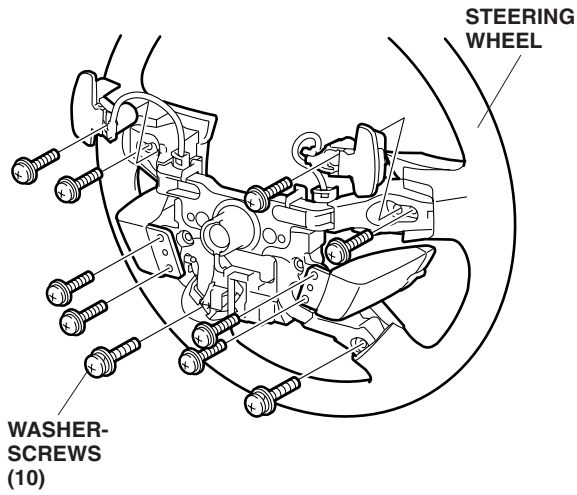

13. Pry up the four retaining tabs and remove the cord guide from the steering wheel.

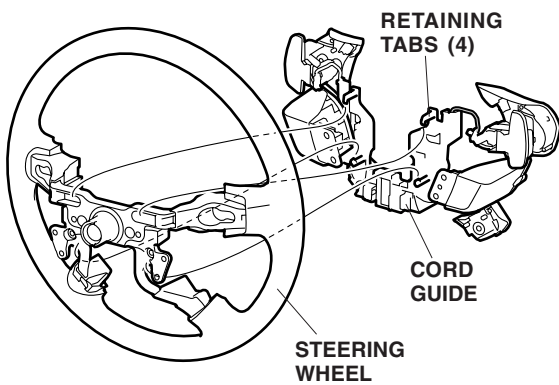

14. Install the cord guide on the new steering wheel.

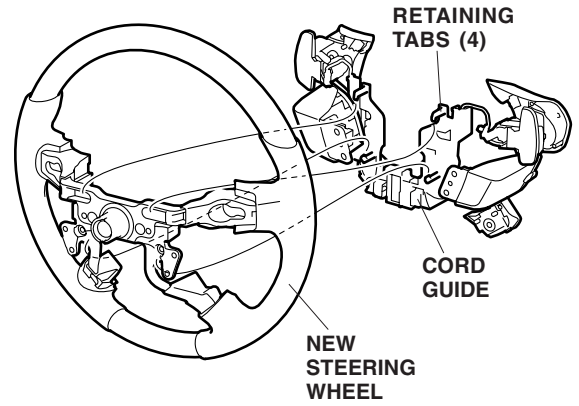

15. Install the switches and/or lids to the steering wheel with the 10 washer-screws.

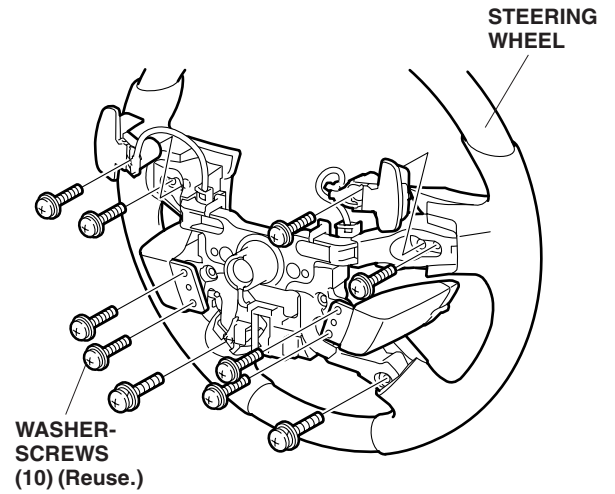

16. Install the steering dynamic damper to the steering wheel with the two washer-screws.

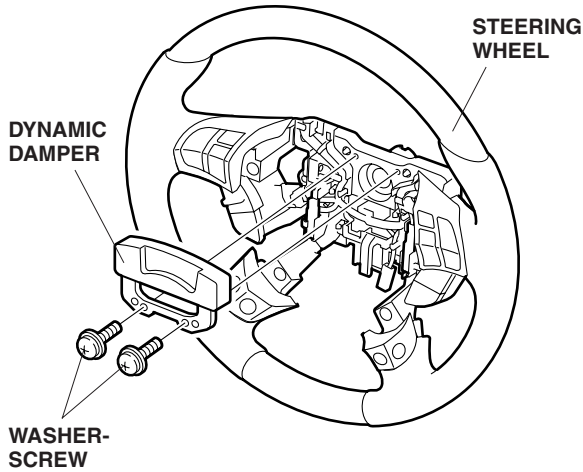

17. Install the body cover to the steering wheel with the two self-tapping screws.

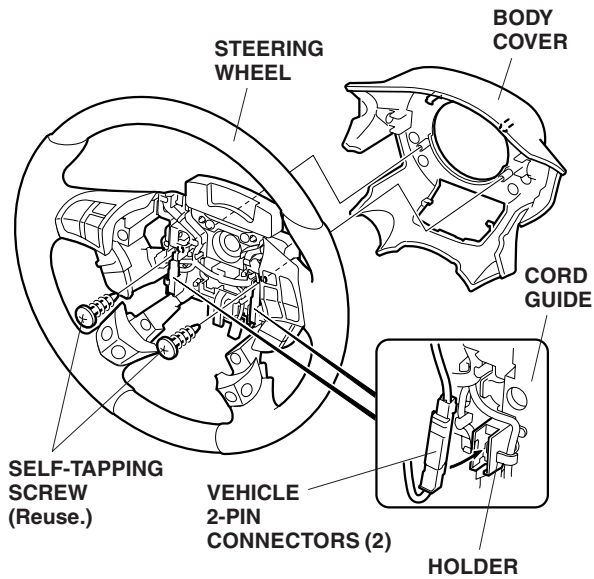

18. Attach the two vehicle connectors to the holders on the cords guide.

*If the cable reel was not moved, go to step 20; if it was moved, go to step 19.*

19. Align the cable reel:

- Rotate the cable reel clockwise all the way until it stops.
- Turn the cable reel counterclockwise about three complete turns until the "TOP" arrow on the cable reel points up.

20. Install the steering wheel on the steering column shaft in the straight-ahead position:

- Route the wire harness through the opening in the steering wheel.
- Align the two tabs of the canceling sleeve with the two cutouts in the steering wheel as shown.
- Check that the wire harness are not pinched.

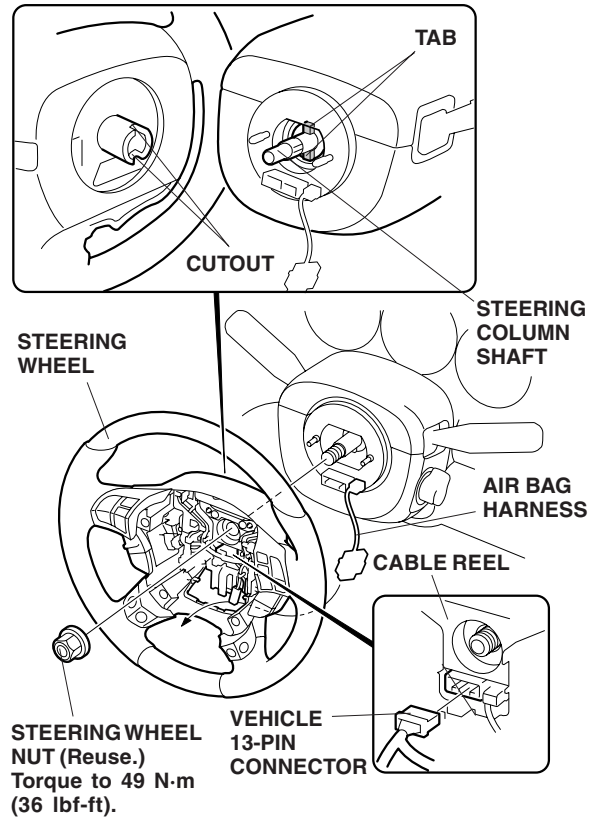

21. Install the steering wheel nut. Torque the steering wheel nut to 49 N·m (36 lbf-ft).

22. Reconnect the 13-pin connectors.

23. Get the airbag, and route the airbag harness and horn harness down through the steering wheel. Position the airbag on the steering wheel, and install the two new Torx bolts. Torque the Torx bolts to 10 N·m (7.2 lbf·ft).

- Check that the wire harness are not pinched.

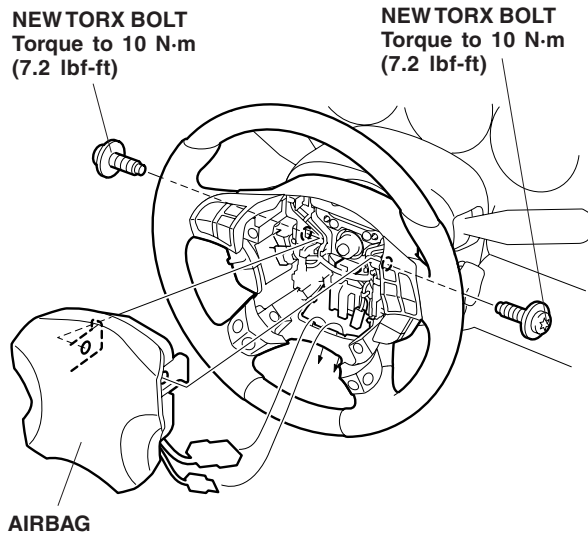

24. From under the steering wheel, connect the horn ground terminals, and attach the terminals to the holder on the cord guide.

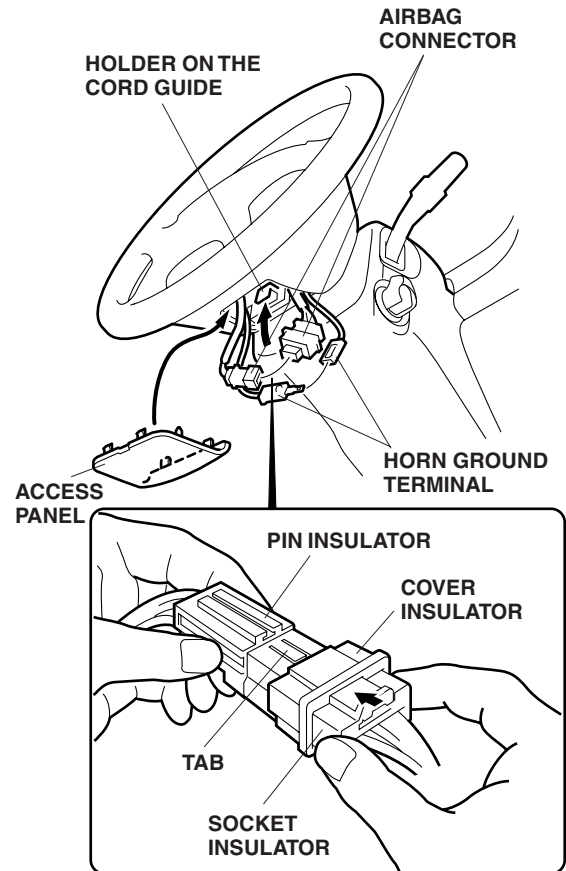

25. Connect the airbag harness connectors:

- Push the socket insulator onto the pin insulator until it contacts the tab on the pin insulator.
- Do not push the socket insulator onto the pin insulator by pushing on the cover insulator.
- Continue pushing on the socket insulator in the same direction until the cover insulator rides over the tab on the pin insulator and is locked securely.
- Reattach the airbag harness connectors to the holder on the cord guide.
- Reinstall the access panel.

26. Reconnect the negative cable to the battery.
27. Make sure the steering wheel is in the straight-ahead position with the front wheels. If the spoke angle of the steering wheel is not in the straight-ahead position with the front wheels, adjust the front toe as described in the Service Manual.
28. Verify that the horn works.
29. Turn the ignition key on, and verify that the SRS warning light comes on and stays on for 6 seconds; turn the key off to make sure the SRS warning light goes off.
30. Enter the anti-theft codes for the radio and navigation system, then enter the customer's radio presets.
31. Reset the clock.

NOTE: Whenever the battery is disconnected, the driver's window AUTO function is disabled.

32. Start the engine. Push down on the driver's window switch until the window is fully open.
33. Pull up on the driver's window switch to close the window completely, then hold the switch for 2 seconds or more.
34. Lower and raise the driver's window to check the operation of the driver's window AUTO function.
35. Do the PCM idle learn procedure.
  - Make sure all electrical items are turned off.
  - Start the engine. Hold the engine speed at 3,000 rpm with no load (in Park or Neutral) until the radiator fan comes on.
  - Let the engine idle for about 10 minutes with the throttle fully closed and with all electrical items off.

NOTE: If the radiator fan comes on during this step, the time it is operating must not be included in the 10 minutes.